

CHECKER MOTORS CORP. KALAMAZOO, MICH.

EFFECTIVE MODEL YEAR 1974

MODEL:
A-11
A-11E

DATE
8-17-73

GRAPHIC ILLUSTRATION

PARTITION - LIFE GUARD MOUNTING

DWN. DESK
CHK.

SHEET NO. 260 B-1

APPVD. SUPERSEDES G1 260 A-5

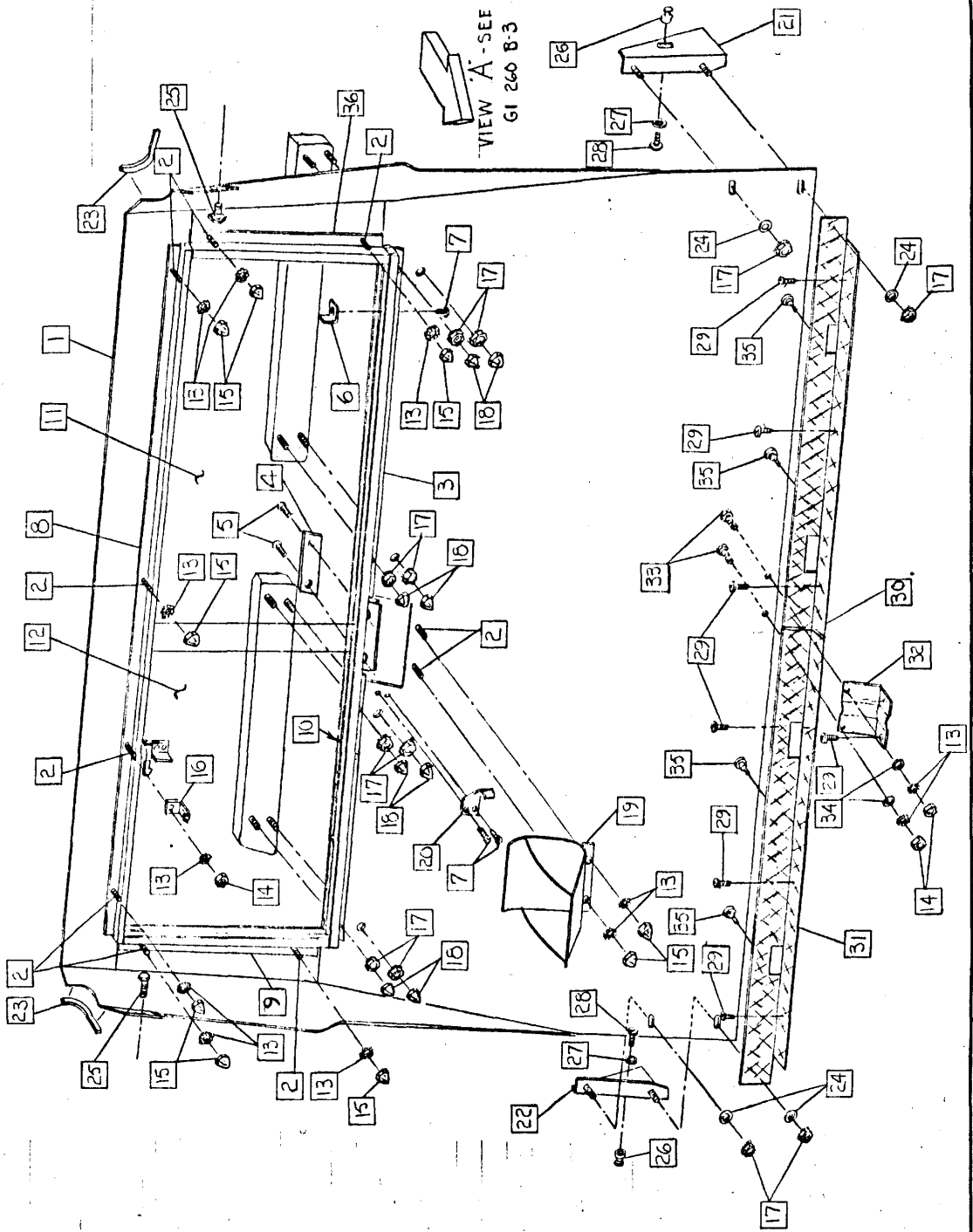

CHECKER MOTORS CORP. KALAMAZOO, MICH.

EFFECTIVE MODEL YEAR 1974

| | | | |
|-------------------------|-----------------|--------------|-----------------------|
| MODEL: A-11 A-11E | DATE 8-17-73 | DWN. CHK. | SHEET NO. 260 B-2 |
| | | APPVD. | SUPERSEDED BY 260 A-5 |

| ITEM NO. | DESCRIPTION | DATE | CHANGES |
|----------|---|------|---------|
| 1. | 647652 PARTITION ASM. - LESS TRIM. | | |
| 2. | 647315 PARTITION ASM. - WELDED L/G | | |
| 3. | 626865 STUD $\frac{3}{16}$ -18 x $\frac{3}{4}$ SPECIAL TAP (10) | | |
| 4. | 647647 CHANNEL ASM. - LEXAN LOWER L/G | | |
| 5. | 642898 PANEL - FARE BOX GUARD (REF.) | | |
| 6. | 626642 RIVET $\frac{3}{16}$ DIA. B5 POP (2) | | |
| 7. | 646343 BRACKET - LEXAN OPEN STOP | | |
| 8. | 163158 SCREW *8 x $\frac{3}{8}$ FH.CR. (3) | | |
| 9. | 647658 CHANNEL ASM. - LEXAN UPPER L/G | | |
| 10. | 647660 CHANNEL ASM. - LEXAN SIDE - R.H. | | |
| 11. | 646338 FILLER - STATIONARY LEXAN $\frac{1}{2}$ x $\frac{1}{2}$ x 19 $\frac{3}{8}$ | | |
| 12. | 646481 LEXAN - L/G PART. L.H. | | |
| 13. | 647659 LEXAN + HANDLE ASM. - L/G PART. | | |
| 14. | 138485 L.W. $\frac{3}{16}$ EXT. TOOTH (12) | | |
| 15. | 120376 NUT $\frac{3}{16}$ -18 HEX. (3) | | |
| 16. | 441265 NUT $\frac{3}{16}$ -18 STAMPED (9) | | |
| 17. | 646341 STRIKER - PART. LATCH L/G | | |
| 18. | 271172 NUT * EXT. L.W. ASM. $\frac{1}{4}$ -20 (12) | | |
| 19. | 626910 NUT $\frac{1}{4}$ -20 STAMPED (8) | | |
| 20. | 647431 BOX ASM. - PARTITION FARE | | |
| 21. | 636347 CLIP - TIRE DOOR SPRING | | |
| 22. | 647435 PANEL ASM. - LOWER PART. SIDE LH. | | |
| 23. | 647436 PANEL ASM. - LOWER PART. SIDE RH. | | |
| 24. | M6-115 RUBBER CHANNEL - $\frac{1}{4}$ " SLOT (1.584 LIN. FT.) | | |
| 25. | 120392 WASHER $\frac{3}{32}$ ID x $\frac{5}{8}$ OD (4) | | |
| 26. | 644300 BOLT - SEAT BELT ANCHOR LONG (2) | | |
| 27. | 626448 JACK NUT $\frac{1}{4}$ -20 (2) | | |
| 28. | 626516 L.W. $\frac{1}{4}$ x .632 OD INT. TOOTH (2) | | |
| 29. | 189129 SCREW $\frac{1}{4}$ -20 x $\frac{3}{8}$ T.H.CR. (2) | | |
| 30. | 626456 SCREW *8 x $\frac{3}{4}$ (8) | | |
| 31. | 646741 GRILLE - LOWER PART. L.H. | | |
| 32. | 646742 GRILLE - LOWER PART. R.H. | | |
| 33. | 644262 ANGLE - LOWER PART. CENTER PANEL | | |
| 34. | 180080 BOLT $\frac{3}{16}$ -18 x $1\frac{1}{8}$ HEX. (2) | | |
| 35. | 120393 WASHER $\frac{1}{2}$ ID x $\frac{1}{16}$ OD (2) | | |
| 36. | 622595 BUMPER - HOOD (4) | | |
| | 646332 CHANNEL - LEXAN SIDE L/G | | |

GRAPHIC ILLUSTRATION

PARTITION - LIFE GUARD TRIM.

DATE

8-20-73

MODEL:

A-11
A-11E

1. 647385 PAD ASM. - PART. UPR. L/G - GRAY
2. 647386 PAD ASM. - PART. UPR. L/G - RED
3. 647397 PAD ASM. - PART. SIDE L/G - GRAY L.H.
4. 647419 PAD ASM. - PART. SIDE L/G - RED L.H.
5. 647398 PAD ASM. - PART. SIDE L/G - GRAY R.H.
6. 647420 PAD ASM. - PART. SIDE L/G - RED R.H.
7. 647421 PAD ASM. - PART. CRASH - L/G - GRAY L.H.
8. 647423 PAD ASM. - PART. CRASH - L/G - RED L.H.
9. 647422 PAD ASM. - PART. CRASH - L/G - GRAY R.H.
10. 647424 PAD ASM. - PART. CRASH L/G - RED R.H.
11. 646269 LABEL - L/G PART.
12. 632317 BUMPER - DOOR (2)
13. 163162 SCREW #8 x 1/2 PAN. HD. (2)
14. MA-147 CEMENT
15. 651573 PAD ASM. - PART. SIDE - BLACK L.H.
16. 651574 PAD ASM. - PART. SIDE - BLACK R.H.
17. 651575 PAD ASM. - PART. CRASH - BLACK L.H.
18. 651576 PAD ASM. - PART. CRASH - BLACK R.H.
19. 651579 PAD ASM. - PART. UPPER - BLACK

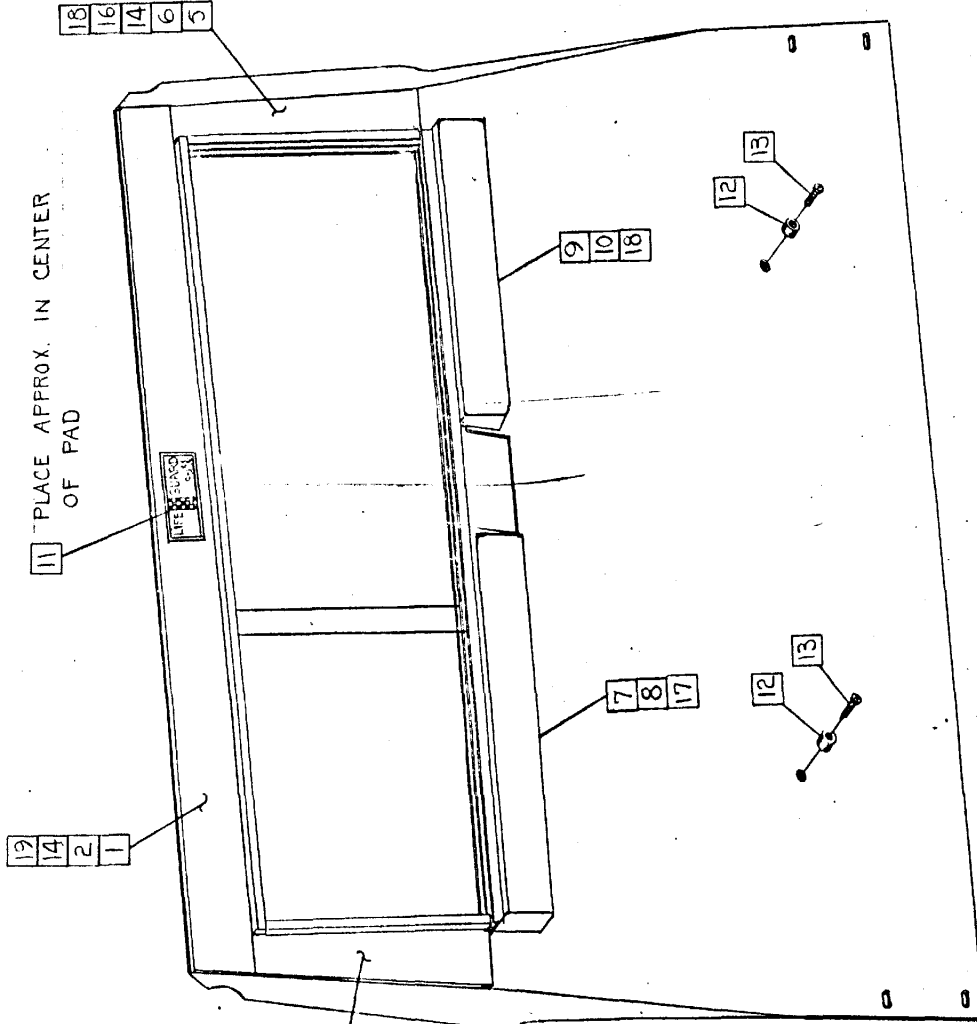

DATE CHANGES