

CHECKER MOTORS CORP. KALAMAZOO, MICH.

EFFECTIVE MODEL YEAR 1974

MODEL:

B-12WB

DATE

6-28-73

GRAPHIC ILLUSTRATION

BUMPER - FRONT

DWN. CHK.

SHEET NO. 30 B-1

APPRVD. SUPERSEDES G.I. 80 A-1 PER MEMO *330

QTY	DESCRIPTION	QTY	DESCRIPTION
14.	189129 SCREW 1/4-20 x 3/8 TR. HD. (2)	14.	189129 SCREW 1/4-20 x 3/8 TR. HD. (2)
15.	626383 NUT 1/4-20 TYPE "U" TINN. (2)	15.	626383 NUT 1/4-20 TYPE "U" TINN. (2)
16.	181698 BOLT 1/2-20 x 1 1/4 HEX. (2)	16.	181698 BOLT 1/2-20 x 1 1/4 HEX. (2)
17.	191695 BOLT 1/2-20 x 4 3/4 HEX. (2)	17.	191695 BOLT 1/2-20 x 4 3/4 HEX. (2)
18.	120371 NUT 1/2-20 HEX. (2)	18.	120371 NUT 1/2-20 HEX. (2)
19.	705509 GUARD ASSEM. - BUMPER L.H.	19.	705509 GUARD ASSEM. - BUMPER L.H.
20.	705510 GUARD ASSEM. - BUMPER R.H.	20.	705510 GUARD ASSEM. - BUMPER R.H.
21.	180122 BOLT 3/8-16 x 1 HEX. (4)	21.	180122 BOLT 3/8-16 x 1 HEX. (4)
22.	178566 LW. 3/8 INT. EXT. TOOTH (2)	22.	178566 LW. 3/8 INT. EXT. TOOTH (2)

QTY	DESCRIPTION	QTY	DESCRIPTION
1.	706572 BAR - BUMPER FACE	1.	706572 BAR - BUMPER FACE
2.	98303 BRACKET (4)	2.	98303 BRACKET (4)
3.	121807 BOLT 3/8-16 x 1 RD. HD. (5)	3.	121807 BOLT 3/8-16 x 1 RD. HD. (5)
4.	120382 LW. 3/8 MED. (9)	4.	120382 LW. 3/8 MED. (9)
5.	120377 NUT 3/8-16 HEX. (9)	5.	120377 NUT 3/8-16 HEX. (9)
6.	126227 BOLT 3/8-16 x 3/4 RD. HD. (4)	6.	126227 BOLT 3/8-16 x 3/4 RD. HD. (4)
7.	704796 SUPPORT (2)	7.	704796 SUPPORT (2)
8.	120917 BOLT 1/2-13 x 1 1/2 RD. HD. (4)	8.	120917 BOLT 1/2-13 x 1 1/2 RD. HD. (4)
9.	120396 WASHER 1/2 ID. x 1 1/4 OD. (9)	9.	120396 WASHER 1/2 ID. x 1 1/4 OD. (9)
10.	120384 LW. 1/2 MED. SPR. (8)	10.	120384 LW. 1/2 MED. SPR. (8)
11.	120378 NUT 1/2-13 HEX. (4)	11.	120378 NUT 1/2-13 HEX. (4)
12.	98058 BRACKET - FRT. LICENSE	12.	98058 BRACKET - FRT. LICENSE
13.	98378 WASHER - FRT. LICENSE	13.	98378 WASHER - FRT. LICENSE

CHANGES
 12-12-72 191695 WAS 189348
 8-11-74 706577 WAS 94752
 705509, 10 W/RE 92592, 93

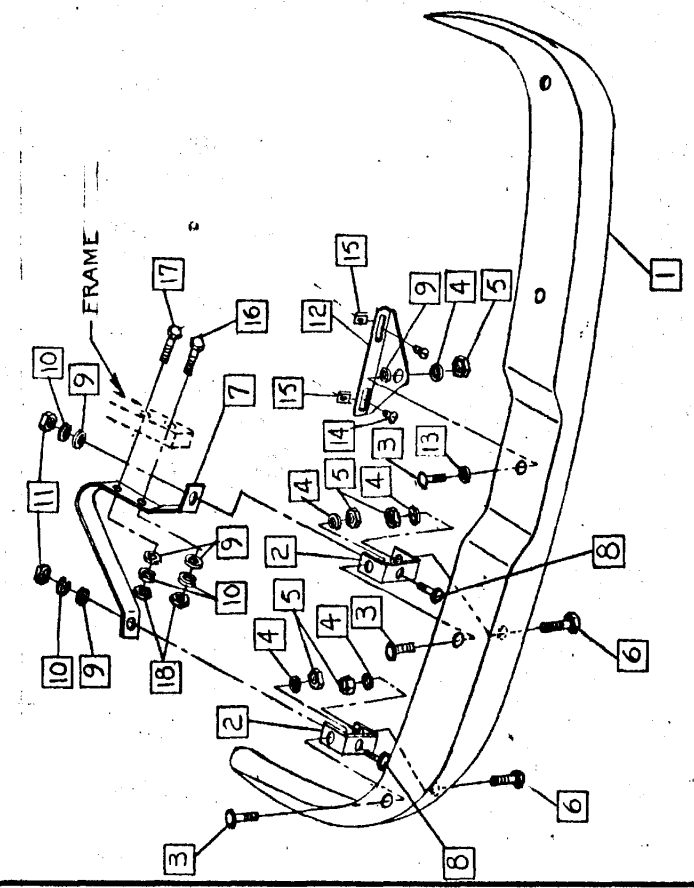

WITHOUT BUMPER GUARDS

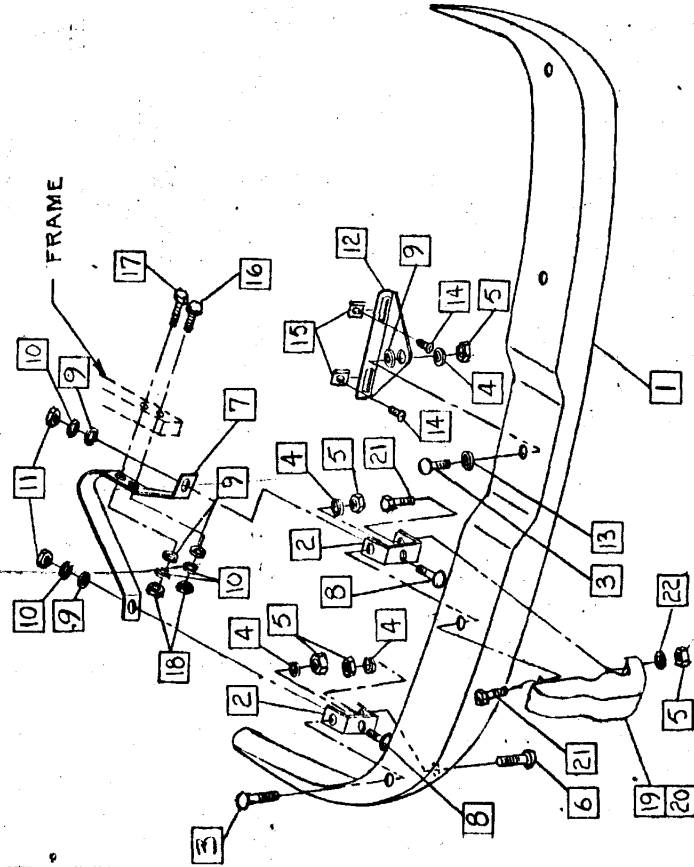

WITH BUMPER GUARDS