

CHECKER MOTORS CORP. KALAMAZOO, MICH.

EFFECTIVE OCT 1, 1970

MODEL:

- B-11
- B-12
- B-11E
- B-12W

DATE

7-23-70

GRAPHIC ILLUSTRATION

ENGINE MOUNTING - FRONT 6 CYL.

DWN. DESKER

CHK: RCP 2-27-70

SHEET NO. 140 A-1

APPVD.

1. 701347 BRACKET ASM. - FRT. ENG. MTG. - 6 CYL. L.H.
2. 701348 BRACKET ASM. - FRT. ENG. MTG. - 6 CYL. R.H.
3. 180120 BOLT  $\frac{3}{8}$ -16 x  $\frac{3}{4}$  HEX. (6)
4. 120382 L.W.  $\frac{3}{8}$  MED. SPRING (9)
5. 703805 MOUNTING ASM. - FRT. ENG (2)
6. 181681 BOLT  $\frac{7}{16}$ -20 x  $3\frac{3}{4}$  HEX. (2)
7. 120395 WASHER  $\frac{1}{8}$  I.D. x  $\frac{5}{16}$  O.D. (4)
8. 702477 SPACER - SPECIAL (2)
9. 272684 NUT  $\frac{7}{16}$ -20 HEX. LOCK (2)
10. 704872 BRACKET - ENG. MTG. STOP (2)
11. 704889 SUPPORT - ENG. MTG. ADAPTER (2)
12. 181637 BOLT  $\frac{3}{8}$ -24 x 1 HEX. (4)
13. 120369 NUT  $\frac{3}{8}$ -24 HEX. (4)
14. 180145 BOLT  $\frac{7}{16}$ -14 x 1 HEX. (2)
15. 120383 L.W.  $\frac{7}{16}$  MED. SPRING (2)
16. 95284 STRAP - ENG. GRD.
17. 178551 L.W.  $\frac{3}{8}$  INT. EXT. TOOTH.
18. 706184 STOP - FRT. ENG. MTG. - 6 CYL. (2)

LEFT SIDE ONLY

CANCELED SUPERSEDED BY G.I. 140A-6

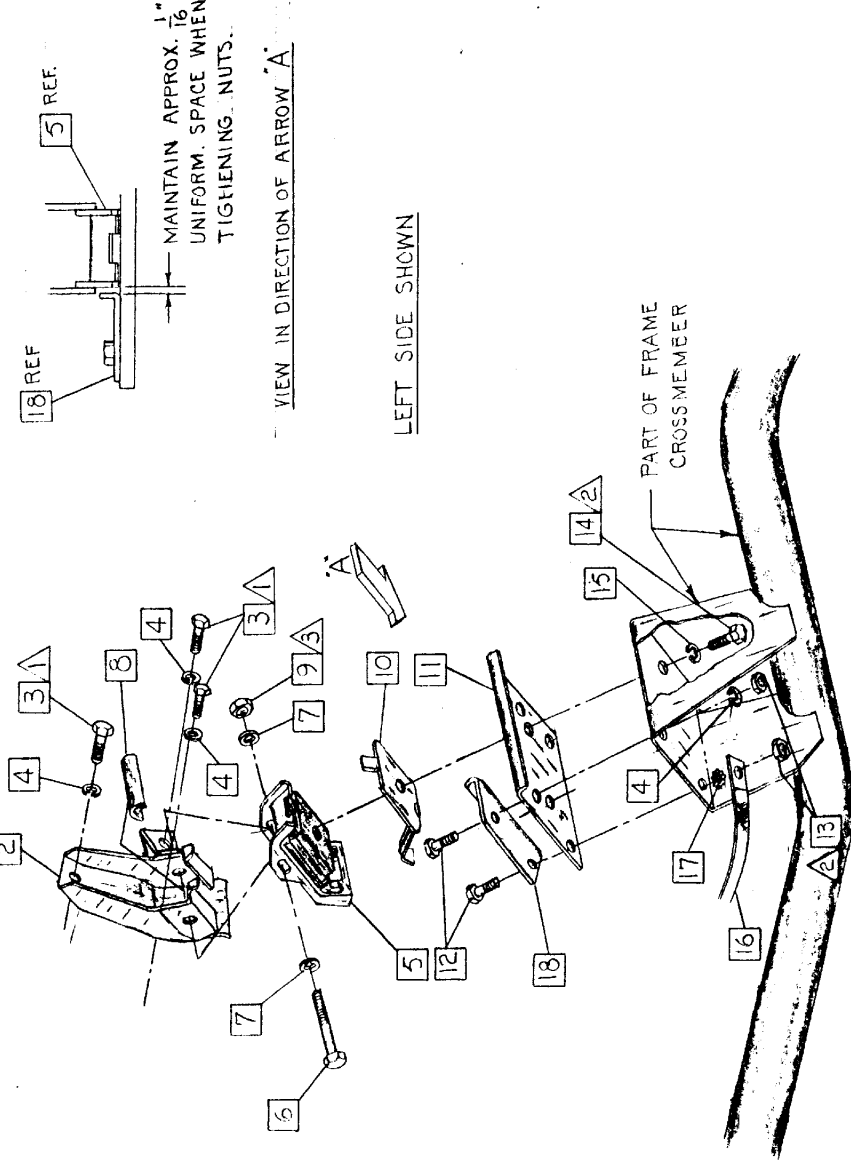

VIEW IN DIRECTION OF ARROW 'A'

LEFT SIDE SHOWN

- 1 20-30 LBS. FT. TORQUE
- 2 25-35 LBS. FT. TORQUE
- 3 40-50 LBS. FT. TORQUE

CHANGES

- 8-3-71 180120 Was 122119
- 10-15-71 706184 ADDED
- 4-10-72 View "A" ADDED, 178551 (1) Reqd Was (2) Reqd.

MODEL:	B-12	DATE
B-11	B-12 W8	7-22-70
B-11E	B-12W	

- 1. MOUNTING ASM. ENG. FRT. V-8
- 2. BOLT  $\frac{3}{8}$ -16 x  $\frac{1}{2}$  HEX. (6)
- 3. L.W.  $\frac{3}{8}$  MED. SPRING (13)
- 4. BOLT  $\frac{7}{16}$ -20 x  $3\frac{1}{4}$  HEX. (2)
- 5. NUT  $\frac{7}{16}$ -20 HEX LOCK. (2)
- 6. BRACKET - V8 ENG. MTG. ADAPTER (2)
- 7. SPACER - ENG. MTG. ADAP. BRKT. (2)
- 8. BOLT  $\frac{3}{8}$ -24 x 1 HEX. (8)
- 9. WASHER  $\frac{1}{32}$  LD. x  $\frac{1}{16}$  OD. (8)
- 10. NUT  $\frac{3}{8}$ -24 HEX. (8)
- 11. L.W.  $\frac{3}{8}$  INT. EXT. TOOTH (2)
- 12. STRAP - ENG. GRD.
- 13. SHIELD - ENG. MOUNT HEAT - LH.

~~CANCELED - SUPERSEDED BY G.I. 140A-7~~

13 LEFT SIDE ONLY

- ▲ 25 - 35 LBS. FT. TORQUE
- △ 40 - 50 LBS. FT. TORQUE

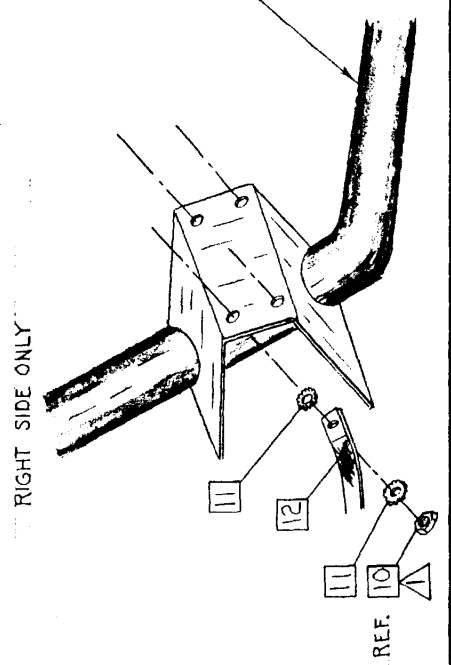
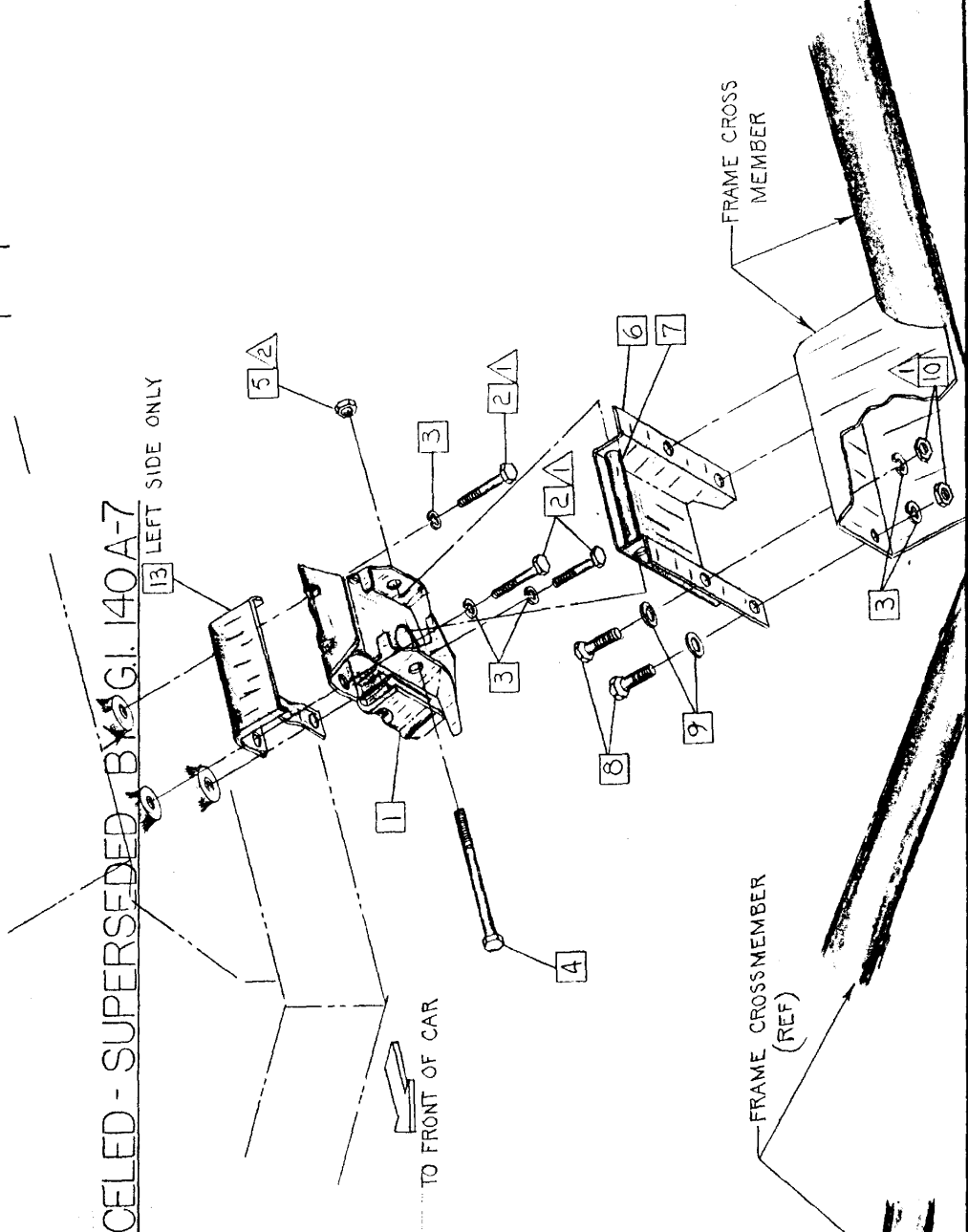

CHANGES	
8-3-71	180120 WAS 122119
9-22-72	

CHECKER MOTORS CORP. KALAMAZOO, MICH.

EFFECTIVE OCT. 1, 1970

MODEL: B-12  
B-11E B-12E  
B-11E B-12W

DATE  
7-27-70

GRAPHIC ILLUSTRATION

DWN. DENKE  
CHK. R. P. 2-2-70

SHEET NO. 140 A-4

ENGINE MOUNTING - REAR 6 CYL. AUTO. TRANS.

APPVD.

- 1. 703931 SUPPORT ASM. - ENG. MTG. - REAR
- 2. 181637 BOLT  $\frac{3}{8}$ -24 x 1 HEX. (4)
- 3. 442828 NUT  $\frac{3}{8}$ -24 HEX. LOCK. (4)
- 4. 704776 PLATE - ENG. SUPPORT (2)
- 5. 704670 PLATE - ENG. SUPPORT (2)
- 6. 703606 MOUNTING ASM.
- 7. 626868 NUT  $\frac{1}{6}$ -14 HEX. SP. CROWNLOCK
- 8. 120353 L.W.  $\frac{1}{6}$  MED. SPRING (4)
- 9. 120388 WASHER  $\frac{1}{6}$  ID. x 1 OD.
- 10. 704780 BRACKET - ENG. MTG. REAR 6 CYL.
- 11. 181668 BOLT  $\frac{1}{6}$ -20 x  $\frac{1}{4}$  HEX. (2)
- 12. 272123 NUT  $\frac{1}{6}$ -20 HEX. (2)
- 13. 180149 BOLT  $\frac{1}{6}$ -14 x  $\frac{1}{2}$  HEX. (2)
- 14. 272122 NUT  $\frac{1}{6}$ -14 HEX. JAM. (2)

CHANGES

2-9-71	45-50 TORQUE ADDED
~	272122 NUT ADDED.
4-27-71	703931 WAS 704890
5-3-71	120388 WAS 446477
7-18-71	706093 ADDED
11-29-71	180149 WAS 180147
~	706093 REMOVED
7-26-72	181668 WAS 181666

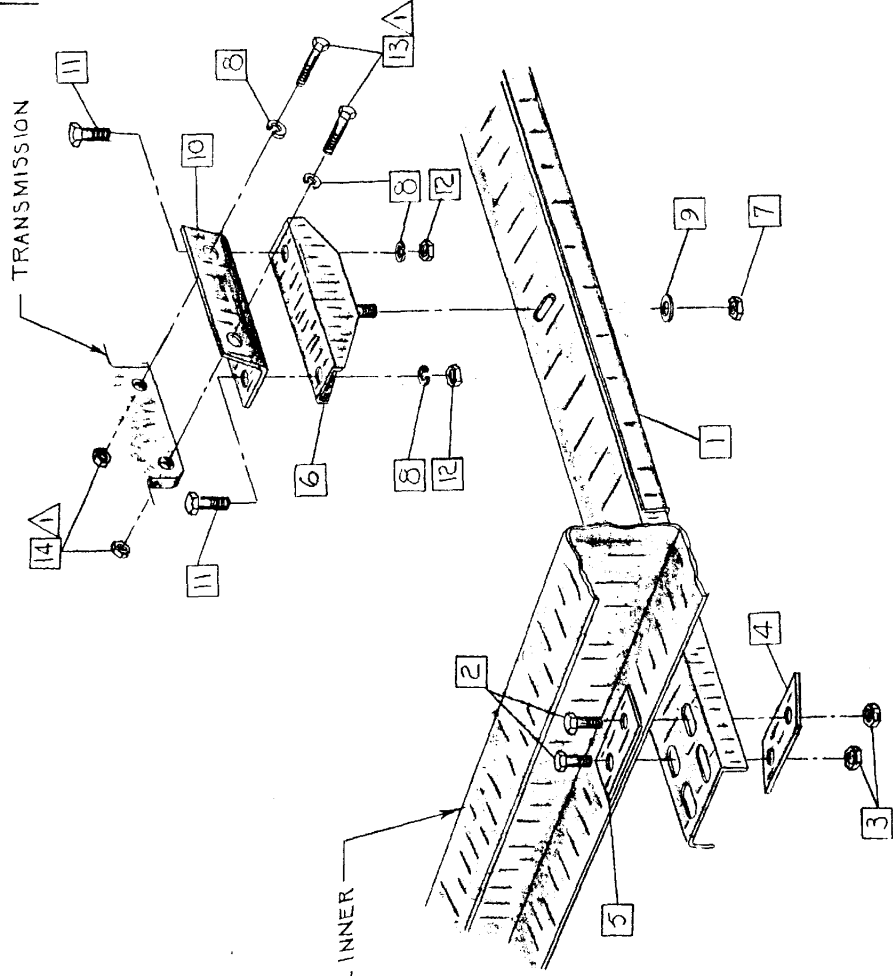

△ 45-50 LBS FT. TORQUE

CHECKER MOTORS CORP. KALAMAZOO, MICH.

EFFECTIVE OCT. 1, 1970

MODEL: B-12  
B-11  
B-11E

GRAPHIC ILLUSTRATION  
ENGINE MOUNTING - REAR 8 CYL. AUTO. TRANS.

DATE  
7-27-70

DWN. DECKER  
CHK. RCP 7-27-70  
APPVD.

SHEET NO. 140 A-5

1. 703931 SUPPORT ASM. - ENG. MTG. - REAR
2. 181637 BOLT  $\frac{3}{8}$ -24 x 1 HEX. (4)
3. 442828 NUT  $\frac{3}{8}$ -24 HEX LOCK (4)
4. 704776 PLATE - ENG. SUPPORT (2)
5. 704670 PLATE - ENG. SUPPORT (2)
6. 703806 MOUNTING ASM.
7. 626868 NUT  $\frac{7}{16}$ -14 HEX. SP. CROWN LOCK
8. 120383 L.W.  $\frac{7}{16}$  MED. SPRING. (4)
9. 120388 WASHER  $\frac{7}{16}$  10 x 1 OD.
10. 704771 BRACKET - ENG. MTG.
11. 181668 BOLT  $\frac{7}{16}$ -20 x  $1\frac{1}{4}$  HEX. (2)
12. 272123 NUT  $\frac{7}{16}$ -20 HEX. (2)
13. 180149 BOLT  $\frac{7}{16}$ -14 x  $1\frac{1}{2}$  HEX. (2)
14. 272122 NUT  $\frac{7}{16}$ -14 HEX JAM. (2)

CHANGES	
2-9-71	45-50 TORQUE ADDED
~	272122 NUT ADDED
4-27-71	703931 WAS 704690
5-3-71	120388 WAS 446477
7-19-71	706093 ADDED
11-27-71	180149 WAS 180147
~	706093 RE-NOVFO
7-20-72	181668 WAS 181666

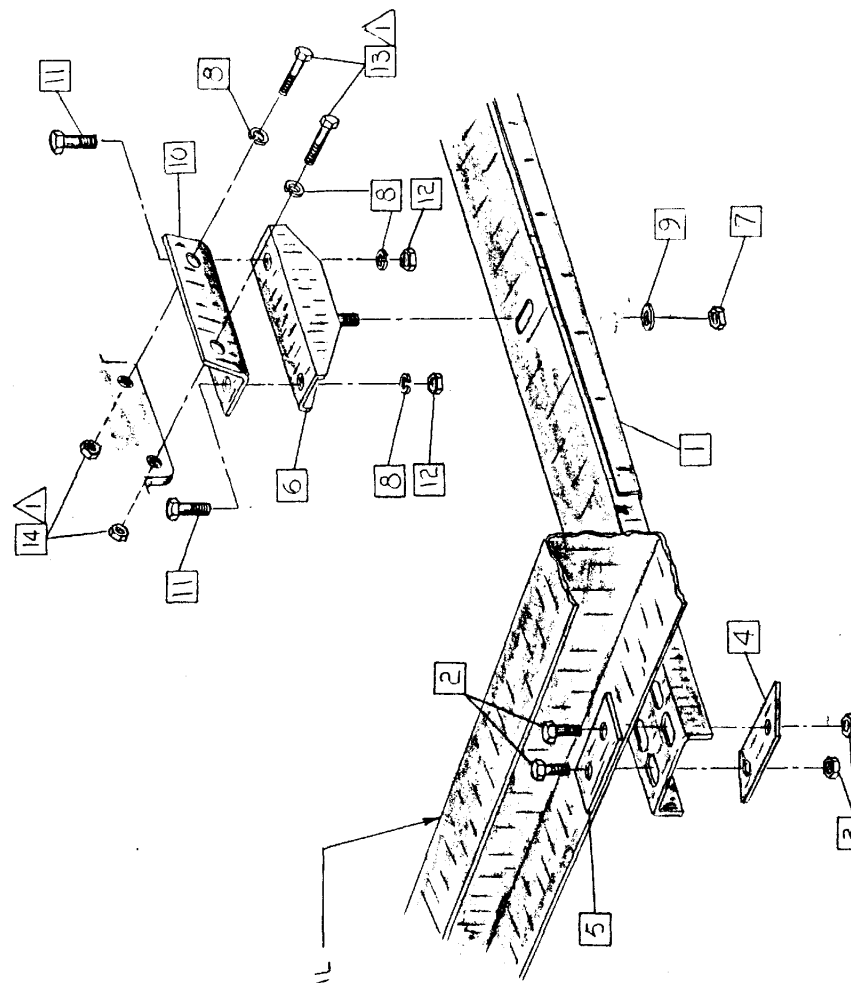

△ 45-50 LBS. FT. TORQUE

CHECKER MOTORS CORP. KALAMAZOO, MICH.

EFFECTIVE OCT 1 1972

MODEL:  
B-11  
B-11E

B-12  
B-12E  
B-12W

DATE  
5-12-72

DWN. DEKEL  
CHK. F. 4-7-72

SHEET NO. 140 A-6  
SUPERSEDES G.I. 140 A-1 PER MEMO 313

ENGINE MOUNTING - 6 CYL. (1973)

1. 706241 BRACKET - FRT. ENG. MTG. LH. 6 CYL.
2. 706242 BRACKET - FRT. ENG. MTG. RH. 6 CYL.
3. 190120 BOLT  $\frac{3}{8}$ -16 x  $\frac{3}{4}$  HEX (6)
4. 120332 L.W.  $\frac{3}{8}$  MED. SPRING (6)
5. 705109 MOUNTING ASM. - ENG. FRT. (2)
6. 706101 BOLT  $\frac{7}{16}$ -14 x 5 HEX FLANGED (2)
7. 706102 NUT  $\frac{7}{16}$ -14 HEX FLANGED (2)
8. 706239 ADAPTER - ENG. MTG. LH. 6 CYL.
9. 706240 ADAPTER - ENG. MTG. RH. 6 CYL.
10. 706099 BOLT  $\frac{3}{8}$ -16 x 1 HEX. (6)
11. 706100 NUT  $\frac{3}{8}$ -16 HEX. FLANGED (6)
12. 181637 BOLT  $\frac{3}{8}$ -24 x 1 HEX. (8)
13. 274643 NUT  $\frac{3}{8}$ -24 SERR. HEX. (8)
14. 178551 L.W.  $\frac{3}{8}$  INT. EXT. TOOTH.
15. 706295 GROUND STRAP

- △ 1 20 - 30 LBS. FT. TORQUE
- △ 2 20 - 27 LBS. FT. TORQUE
- △ 3 40 - 50 LBS. FT. TORQUE

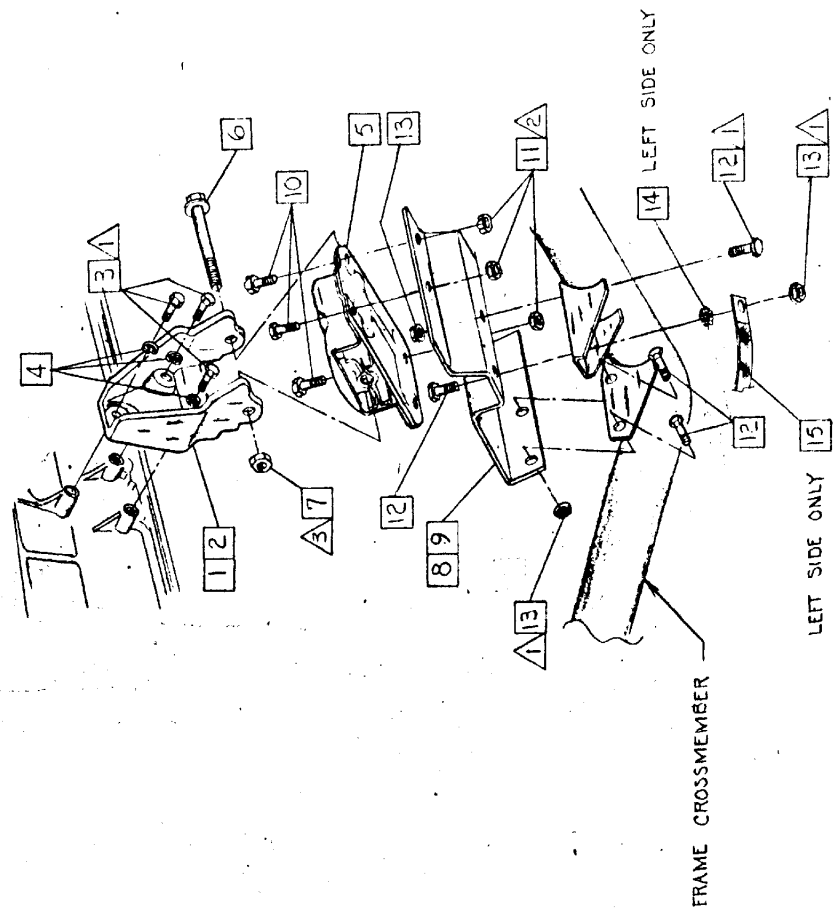

DATE	CHANGES
7-27-72	706241 N/A 95334
~	274643 N/A 120332
~	120332

CHECKER MOTORS CORP. KALAMAZOO, MICH.

EFFECTIVE OCT 1, 1972

MODEL: B-11 B-11E	B-12 B-12E B-12W	DATE 5-11-72	DWN. DEKKER CHK. 12-6-7-72	SHEET NO. 140 A-7	APPROV. DATE
GRAPHIC ILLUSTRATION			SUPERSEDES G.I. 140A2 MEMO 318		CHANGES:
ENGINE MOUNTING - 8 CYL. (1973)			APPVD.		706295 WA-3 92264 274643 WA-3 1203837 120382

1. 706245 BRACKET - ENG. MTG. FRT. LH. (V-8)
2. 706243 BRACKET - ENG. MTG. FRT. RH. (V-8)
3. 180120 BOLT  $\frac{3}{8}$  - 16 x  $\frac{3}{4}$  (6)
4. 120382 L.W.  $\frac{3}{8}$  MED. SPRING (6)
5. 705113 MOUNTING ASM. - ENG. FRT. 8 CYL (2)
6. 706101 BOLT  $\frac{7}{16}$  - 14 x 5 HEX. FLANGED (2)
7. 706102 NUT  $\frac{7}{16}$  - 14 HEX. FLANGED (2)
8. 706079 ADAPTER - ENG. MTG. LH.
9. 706080 ADAPTER - ENG. MTG. RH.
10. 706039 BOLT  $\frac{3}{8}$  - 16 x 1 HEX. (6)
11. 706100 NUT  $\frac{3}{8}$  - 16 HEX. FLANGED (6)
12. 181637 BOLT  $\frac{3}{8}$  - 24 x 1 HEX. (6)
13. 274643 NUT  $\frac{3}{8}$  - 24 HEX. SERR. (6)
14. 178551 L.W.  $\frac{3}{8}$  INT. EXT. TOOTH
15. 706295 GROUND STRAP.

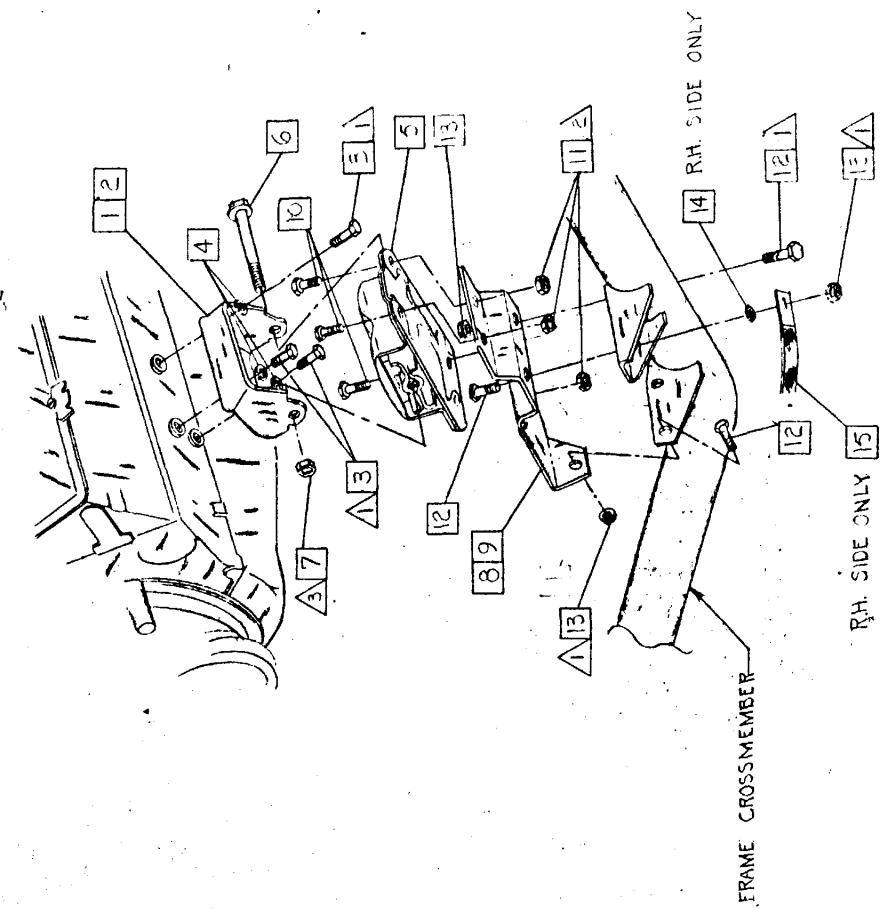

- ① 20 - 30 LBS. FT. TORQUE
- ② 20 - 27 LBS. FT. TORQUE
- ③ 40 - 50 LBS. FT. TORQUE

CHECKER MOTORS CORP. KALAMAZOO, MICH.

EFFECTIVE

MODEL:  
B-11  
B-11E

DATE  
11-10-72

GRAPHIC ILLUSTRATION  
ENGINE MOUNTING - REAR 6 CYL. HYDRAMATIC

DWN. DESKER  
CHK. R. J. 1-30-73

SHEET NO. 140 A-8  
SUPERSEDS G.I. 140 A-4 PER MEMO #326

1. 705192 SUPPORT ASM. - ENG. MTG. REAR
2. 704670 PLATE - ENG. SUPT. FR. "X" MBR. REINE. (2)
3. 704776 PLATE - ENG. SUPT. BOLTING (2)
4. 181637 BOLT 3/8-24 x 1 HEX. (4)
5. 442828 NUT 3/8-24 HEX. (4)
6. 705172 MOUNTING ASM. - TRANS. SUPT.
7. 626913 WASHER 1/4 ID. x 1 3/8 OD. x 3/16 THK
8. 271501 NUT 1/4-14 SPL.
9. 150145 BOLT 1/4-14 x 1 HEX. (2)
10. 120383 L.W. 1/16 MED. SPR. (2)

- ① 45 - 60 LBS. FT. TORQUE
- ② 25 - 30 LBS. FT. TORQUE
- ③ 40 - 45 LBS. FT. TORQUE

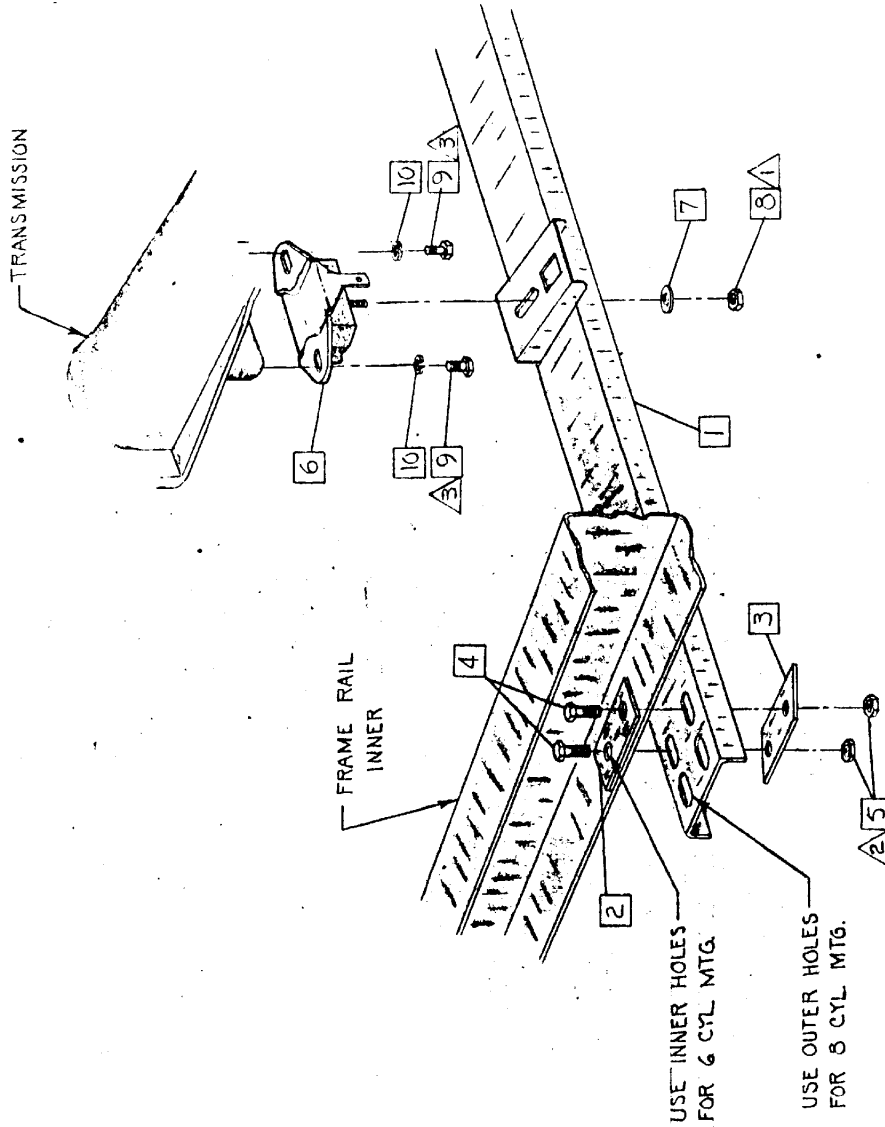

USE INNER HOLES  
FOR 6 CYL MTG.

USE OUTER HOLES  
FOR 8 CYL MTG.

CHECKER MOTORS CORP. KALAMAZOO, MICH.

EFFECTIVE

SHEET NO. 140 A-9

DWN. DENVER  
CHK. 2/2-30-73

APPVD. SUPERSEDS G.I. 140 A-5 PER MEMO 726

GRAPHIC ILLUSTRATION

ENGINE MOUNTING - REAR & CYL. HYDRAMATIC

DATE

11-10-72

MODEL: B-12 B-12W8

B-12E B-12W

MODEL: B-12

B-12E

B-12W

1. 705192 SUPPORT ASM. - ENG. MTG. REAR
2. 704670 PLATE - ENG. SUPT. FR. X" MBR. REINF. (2)
3. 704776 PLATE - ENG SUPT. BOLTING (2)
4. 181637 BOLT 3/8" - 24 \* 1 HEX. (4)
5. 442828 NUT 3/8" - 24 HEX (4)
6. 705172 MOUNTING ASM. - TRANS. SUPPORT
7. 622913 WASHER 5/32 I.D. \* 1 3/8 O.D. \* 3/16 THK.
8. 271501 NUT 7/16" - 14 SPL.
9. 150145 BOLT 3/16" - 14 \* 1 HEX. (2)
10. 120353 L.W. 7/16 MED. SPR. (2)

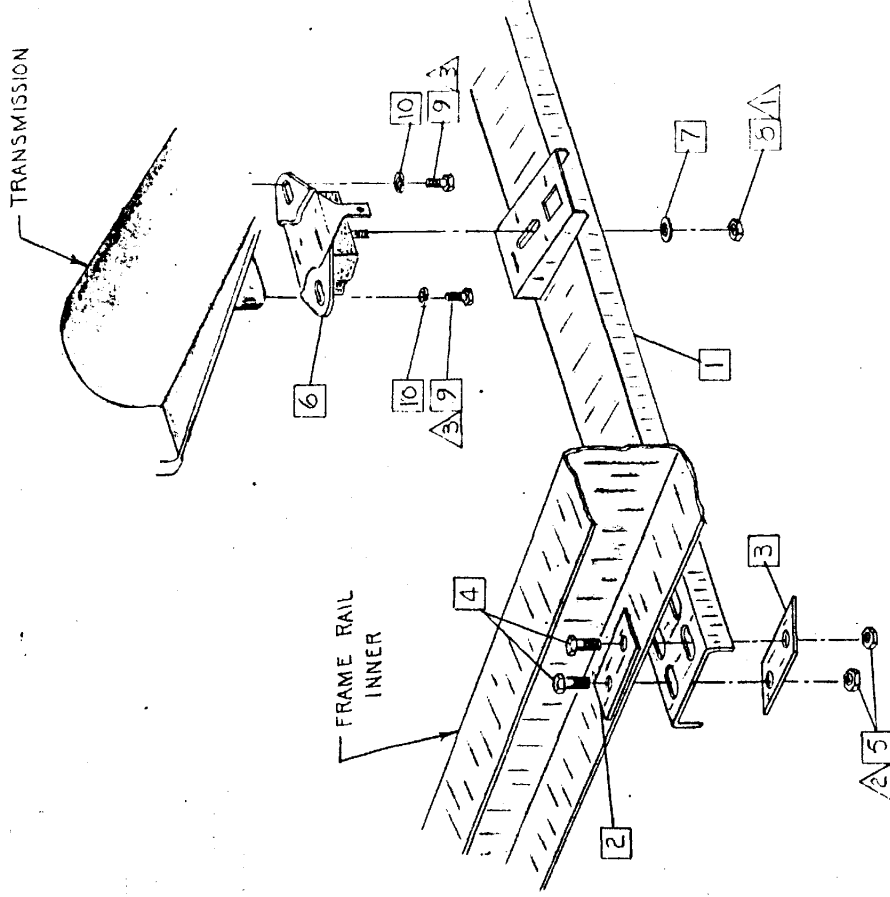

- 45 - 60 LBS. FT. TORQUE
- 25 - 30 LBS. FT. TORQUE
- 40 - 45 LBS. FT. TORQUE