

MODEL: B-11E
B-11
B-12

DATE: 8-25-70

GRAPHIC ILLUSTRATION

DWN. DEKKER
CHK. *[Signature]*

SHEET NO. 92 A-1

CARBURETOR CONTROLS - 6 CYL. AUTO. TRANS.

APPYD.

CHANGES	
1-22-71	704985 WAS 704906
~	25 (SPRING) RELOCATED
9-9-71	702551 REMOVED (*)
7-6-72	126479 REMOVED (2)
~	120614 REMOVED
~	9411593 ADDED
1-29-73	702597 WAS 702337
4-12-73	115269 ADDED

- | | |
|---|---|
| 1. CARBURETOR ASM. - SEE GI. 20 A-1, A-3, A-4 | 20. LEVER - THROT. CONT. SHAFT - INNER |
| 2. 701129 ROD ASM. - E/CRANK TO CARB. | 21. 702128 LEVER - THROT. CONT. SHAFT - OUTER |
| 3. 9411593 NUT #10-32 NYLON HEX LOCK (2) | 22. 120392 WASHER $\frac{1}{32}$ ID. x $\frac{5}{8}$ O.D. (3) |
| 4. 120614 NUT #10-32 HEX. | 23. 112726 COTTER PIN $\frac{1}{16}$ x $\frac{1}{2}$ (2) |
| 5. 703836 ELLCRANK ASM. | 24. 432982 BOLT $\frac{1}{4}$ x 20 x $3\frac{3}{4}$ HEX. |
| 6. 94949 BUSHING (2) | 25. 704985 SPRING - THROTTLE RETURN - 6 CYL. |
| 7. 702210 SCREW $\frac{5}{16}$ x $1\frac{1}{2}$ SHOULDER | 26. 702122 ROD - ACCEL. PEDAL |
| 8. 121547 FIN $\frac{3}{16}$ x $\frac{1}{32}$ CLEVIS | 27. 635192 BOOT |
| 9. 110322 CLEVIS #10 ADJ. | 28. 95135 PEDAL - FLATE ASM. |
| 10. 703837 ROD - TUEE ASM. | 29. 156351 SCREW $\frac{1}{4}$ x 20 x 2 FLAT HD (2) |
| 11. 704793 ROD - CONT. LEVER TO E/C - REAR | 30. 705197 SWITCH ASM. - KICKDOWN |
| 12. 120391 WASHER $\frac{1}{32}$ ID. x $\frac{1}{2}$ O.D. (2) | 31. 124939 NUT $\frac{1}{16}$ - 15 HEX. |
| 13. 702126 BRACKET | 32. 704361 SPRING - ACCEL. PULL BACK (ORANGE) |
| 14. 120375 NUT $\frac{1}{4}$ - 20 HEX. (3) | 33. FUEN. ON ENGINE |
| 15. 120350 L.W. $\frac{1}{4}$ MED. SPRING (3) | 34. 702397 NUT $\frac{1}{16}$ - 15 PALNUT |
| 16. 98446 NUT $\frac{1}{4}$ - 20 HEX. ELASTIC STOP | 35. 115269 CLIP - SINGLE TUBE |
| 17. 702125 SPACER (3) | |
| 18. 702538 BUSHING (2) | |
| 19. 702123 SHAFT - THROT. CONTROL | |

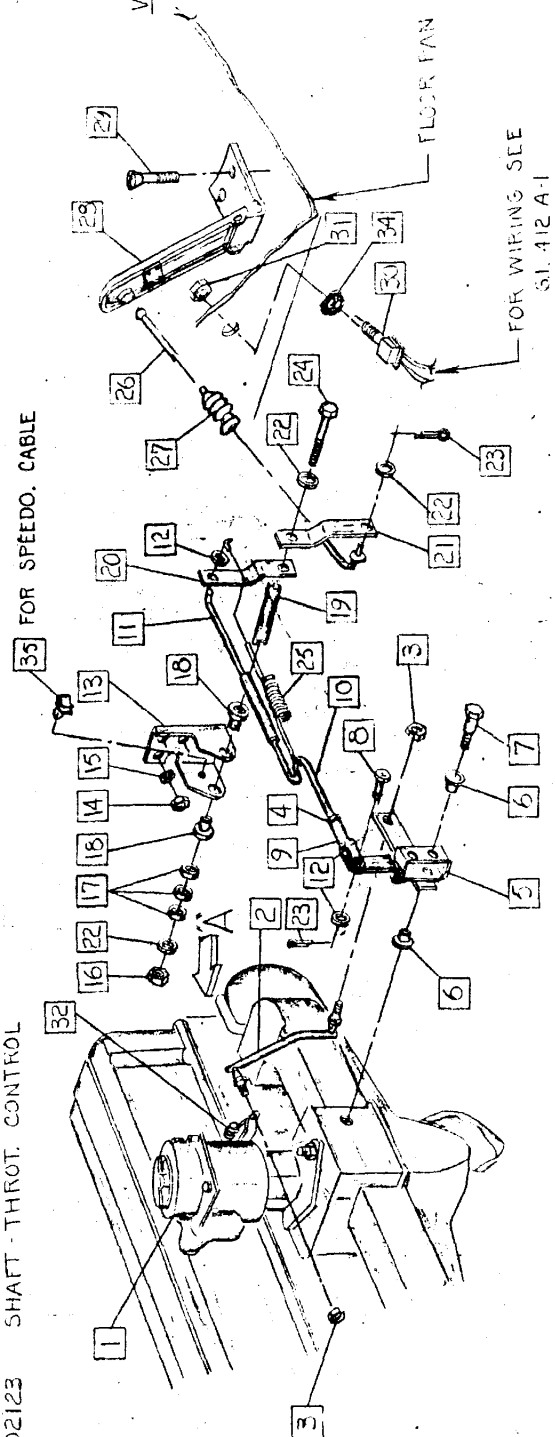
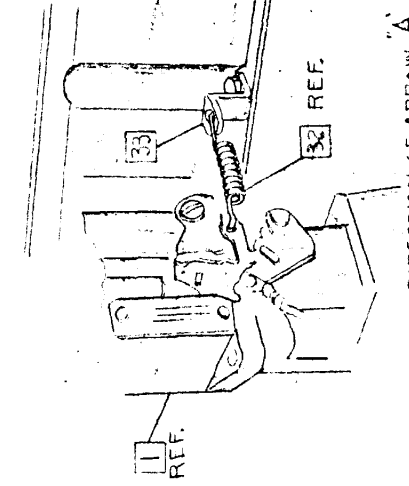

CHECKER MOTORS CORP. KALAMAZOO, MICH.

EFFECTIVE OCT. 1, 1970

MODEL: B-11E
B-11E
B-12 W

DATE
B-10-70

GRAPHIC ILLUSTRATION
CARBURETOR CONTROLS - 350 V-8 -

DWN. DEKKER
CHK. 8-20-70
APPVD.

SHEET NO. 92 A-2

- 1. CARBURETOR SEE G.I. 90 A-5
- 2. 702397 NUT $\frac{3}{16}$ - 18 PALNUT
- 3. 704638 SPRING - ACCEL. FULL BACK (2)
- 4. 124939 NUT $\frac{3}{16}$ - 18 HEX.
- 5. 704461 ADAPTER - CARB.
- 6. 705197 SWITCH ASM. - KICKDOWN
- 7. 120391 WASHER $\frac{7}{32}$ ID. $\times \frac{1}{2}$ OD.
- 8. 156351 SCREW $\frac{1}{4}$ - 20 \times 2 FLAT HD. (2)
- 9. 95133 PEDEL + PLATE ASM. - ACCEL.
- 10. 120614 NUT $\frac{1}{4}$ - 32 HEX.
- 11. 120654 BOLT $\frac{1}{4}$ - 20 $\times \frac{5}{8}$ HEX. (2)
- 12. 271172 NUT $\frac{1}{4}$ - 20 $\times \frac{1}{2}$ (2)
- 13. 120375 NUT $\frac{1}{4}$ - 20 HEX. (3)
- 14. 121547 PIN - CLEVIS $\frac{3}{16}$ $\times \frac{1}{2}$
- 15. 110322 CLEVIS - #10
- 16. 703701 ROD + TUBE ASSEM.
- 17. 704899 ROD - CONT. LEVER TO BELLCRANK
- 18. 94110 SPRING
- 19. 112726 COTTER PIN $\frac{1}{16}$ $\times \frac{1}{2}$ (2)
- 20. 702344 LEVER - THROT. CONT. SHAFT - INNER BRACKET
- 21. 702126 LEVER - THROT. CONT. SHAFT - OUTER
- 22. 702125 NUT $\frac{1}{4}$ - 20 - HEX.
- 23. 96446 SPACER (3)
- 24. 702125 BUSHING (2)
- 25. 702838 BOLT $\frac{1}{4}$ - 20 $\times \frac{3}{4}$ HEX.
- 26. 432952 SHAFT - THROT. CONTROL
- 27. 702123 WASHER $\frac{3}{32}$ ID. $\times \frac{5}{8}$ OD. (3)
- 28. 120392 L.W. $\frac{1}{4}$ MED. SPRING (3)
- 29. 120360 ROD - ACCEL PEDAL
- 30. 702122 BOOT
- 31. 635192 CLIP - SINGLE TUBE
- 32. 115269

CHANGES	
3-22-70	703702 REMOVED
1-29-70	705197 WAS 705457
4-12-70	115269 Added

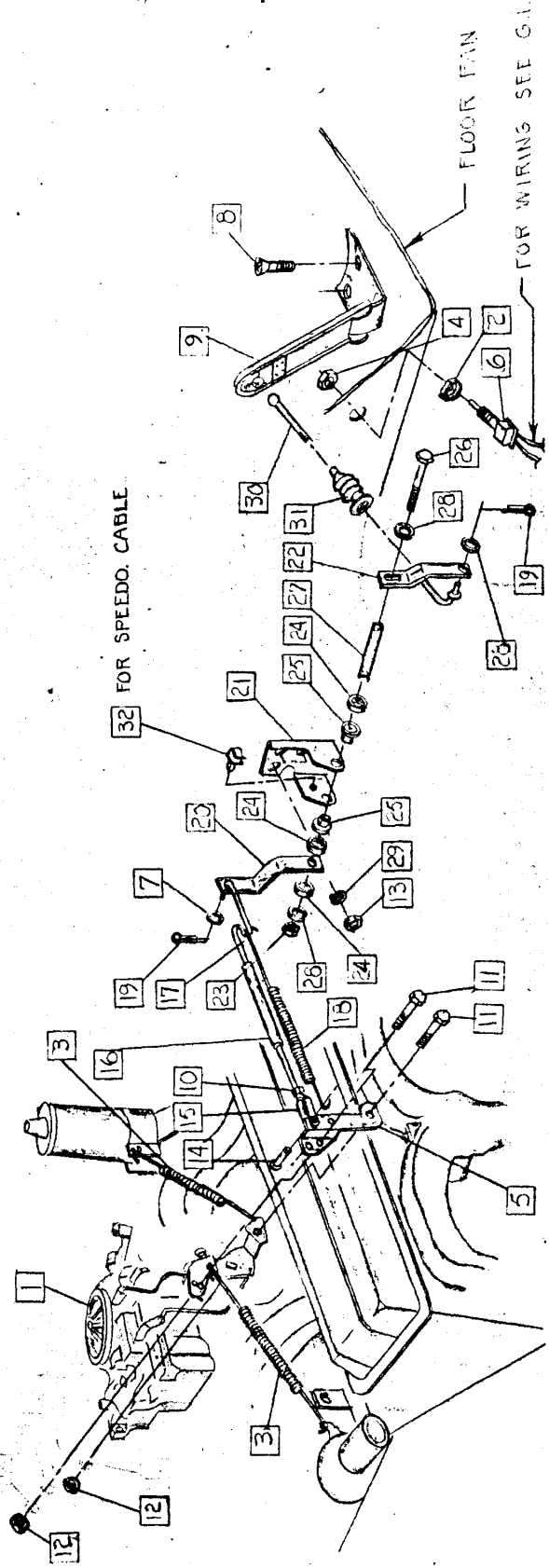

EFFECTIVE OCT 1, 1971

CHECKER MOTORS CORP. KALAMAZOO, MICH.

SHEET NO. 92 A-3

DWN. DRAWING
CHK. Z. DEER

GRAPHIC ILLUSTRATION

DATE 9-26-71

MODEL: E-12WD

CARBURETOR CONTROLS - 8 CYL. 4 EEL. CAB. APPVD.

NO.	DESCRIPTION	QTY.	DATE	CHANGES
1.	706187 ADAPTER - CAB. 350-4 EEL.		1-20-73	705127 WAS 703337
2.	147897 SCREW 1/4-20 x 1/2 F.H.C.R.	(2)	4-18-78	1152259 Added
3.	94110 SPRING - THROTTLE RETURN		5-24-73	704487 Revised
4.	704528 SPRING - ACCEL. RETURN (2)			
5.	120554 BOLT 1/4-20 x 3/8 HEX.			
6.	120423 L.W. 1/4 INT. TOOTH			
7.	120375 NUT 1/4-20 HEX (5)			
8.	120614 NUT "10-32 HEX.			
9.	110322 CLEVIS			
10.				
11.	703336 ROD + TUBE ASY. - CONTROL LEVER TO E/CRANK - FRT.			
12.	704707 ROD - CONTROL LEVER TO E/CRANK - REAR			
13.	121547 PIN - CLEVIS			
14.	11E726 COTTER PIN (2)			
15.	702126 BRACKET			
16.	702858 BUSHING (2)			
17.	702125 SHAFT			
18.	702344 LEVER			
19.	702128 LEVER			
20.	702125 SPACER (2)			
21.	432962 BOLT 1/4-20 x 3/8			
22.	120392 WASHER 1/2 ID. x 1/2 O.D. (3)			
23.	98446 NUT 1/4-20 ELASTIC STOP			
24.	120360 L.W. 1/4 MED. SPRING (3)			
25.	702122 ROD - ACCELERATOR PEDAL			
26.	655192 BOOT			
27.	95135 PEDAL + PLATE ASM. - ACCELERATOR			
28.	156351 SCREW (2)			
29.	120391 WASHER 3/32 ID. x 1/2 O.D.			
30.	705197 SWITCH ASM. - KICKDOWN			
31.	124939 NUT 3/16-18 HEX.			
32.	702397 NUT 1/4-18 FALNUT			
33.	115269 CLIP - SINGLE TUBE.			

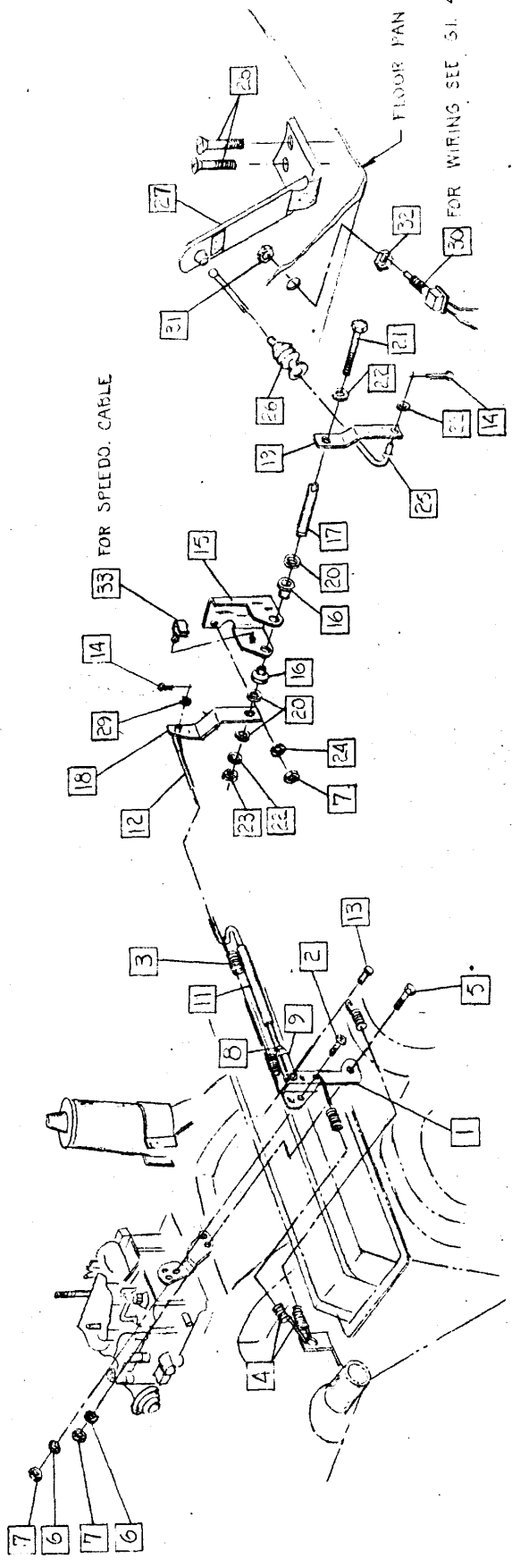

FOR WIRING SEE SI 412 A-1

CHECKER MOTORS CORP. KALAMAZOO, MICH.

EFFECTIVE: OCT 1, 1970

SHEET NO. 92 A-4

DWN. DEKKEK
CHK. *has*

GRAPHIC ILLUSTRATION

CARBURETOR CONTROLS - STD. + AUTO. TRANS. - AEROEUS

DATE

8-11-70

MODEL:

B-12W8

APPVD.

10-2171 81405 ADDED

- | | | | |
|------------|--------------------------------------|------------|--|
| 1. 703794 | CARBURETOR ASM. - 350 AEROEUS | 19. 432962 | BOLT 1/4-20 x 3 3/4 HEX. |
| 2. 703832 | ADAPTER ASM. - CARB. | 20. 702123 | SHAFT - THROT. CONTROL |
| 3. 120706 | BOLT 1/4-20 x 1/2 HEX. (2) | 21. 120392 | WASHER 3/32 I.D. x 5/8 O.D. (2) |
| 4. 271172 | NUT + EXT. TOOTH ASM. 1/4-20 (2) | 22. 120380 | L.W. 1/4 MED. SFRING (3) |
| 5. 121547 | PIN - CLEVIS 3/16 DIA. | 23. 120375 | NUT 1/4-20 HEX. (3) |
| 6. 110322 | CLEVIS #10 | 24. 702122 | ROD - ACCEL. PEDAL |
| 7. 120614 | NUT #10-32 HEX. | 25. 635192 | BOOT |
| 8. 703701 | ROD + TUBE ASM. | 26. 95133 | PEDAL + PLATE ASM. ACCEL. |
| 9. 704848 | ROD - CONT. LEVER TO BELLCRANK | 27. 156351 | SCREW 1/4-20 x 2 FLAT HD. (2) |
| 10. 94110 | SPRING - | 28. 705637 | SWITCH ASM. - KICKDOWN } AUTO. TRANS. ONLY |
| 11. 112726 | COTTER PIN 1/16 x 1/2 (2) | 29. 124939 | NUT 3/16-18 HEX. |
| 12. 120391 | WASHER 3/32 I.D. x 1/2 O.D. | 30. 704582 | ACCEL. PULL BACK |
| 13. 702344 | LEVER - THROT. CONTROL SHAFT - INNER | 31. 702397 | NUT 3/16-18 PALNUT (AUTO TRANS. ONLY) |
| 14. 702126 | BRACKET | 32. 81405 | SPRING - ACCEL. RETURN |
| 15. 702128 | LEVER - THROT. CONTROL SHAFT - OUTER | | |
| 16. 98446 | NUT 1/4-20 HEX. | | |
| 17. 702125 | SPACER (3) | | |
| 18. 702888 | BUSHING (2) | | |

CANCELLED SUPERCEDED BY G.I. 92 A-3

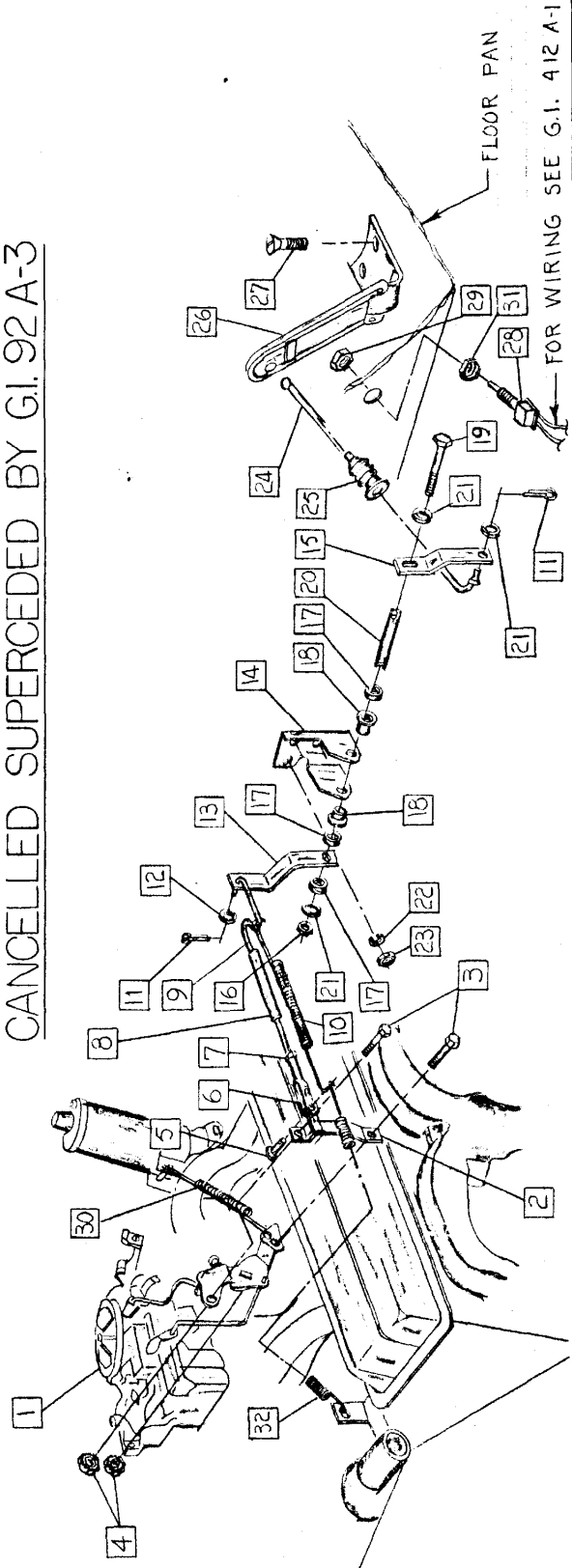

CHECKER MOTORS CORP. KALAMAZOO, MICH.

EFFECTIVE OCT. 1, 1969

MODEL: B-11E
B-12E
B-12W

DATE
8-14-69

GRAPHIC ILLUSTRATION

CARBURETOR IDLE CONTROL - 6 CYL.

DWN. DEKKER
CHK. G.K.B.

SHEET NO. 92 A-5

APPVD.

CANCELLED OCT 1 1970

CHANGES

1. 703212 SOLENOID ASSEM.
2. 703668 BRACKET ASSEM. - CARB. IDLE CONT. SOL.
3. 704742 BRACE - CARB. IDLE CONT. SOL. ERKT.
4. 120392 WASHER $\frac{3}{32}$ I.D. x $\frac{3}{8}$ OD.
5. 121887 BOLT $\frac{1}{4}$ -20 x $\frac{3}{4}$ HEX.
6. 120369 NUT $\frac{3}{8}$ -24 HEX.
7. 180137 BOLT $\frac{3}{8}$ -16 x $2\frac{3}{4}$ HEX.
8. 120382 L.W. $\frac{3}{8}$ MED. SPRING
9. 120377 NUT $\frac{3}{8}$ -16 HEX.

CANCELLED

ADJUSTMENT INSTRUCTIONS

1. INSTALL SOLENOID BRACKET TO INLET MANIFOLD.
2. SET THE CARB. IN THE CLOSED THROTTLE POSITION WITH THE CHOKE COMPLETELY OFF.
3. WITH SOLENOID ENERGIZED (POWER ON), INSTALL INTO BRACKET BY SLIDING IT DOWN WITHIN THE BRACKET SO THE SOLENOID PLUNGER JUST SLIGHTLY CONTACTS THE CARB. LEVER. TIGHTEN THE BRACKET STRAP TO SECURE THE SOLENOID IN PLACE.
4. BACK CARB. IDLE ADJUSTING SCREW OUT (1) TURN (COUNTER-CLOCKWISE) THIS RESULTS IN A CLEARANCE BETWEEN THE CARB. IDLE ADJUSTING SCREW AND ITS STOP ON THE LEVER OF APPROX. .025

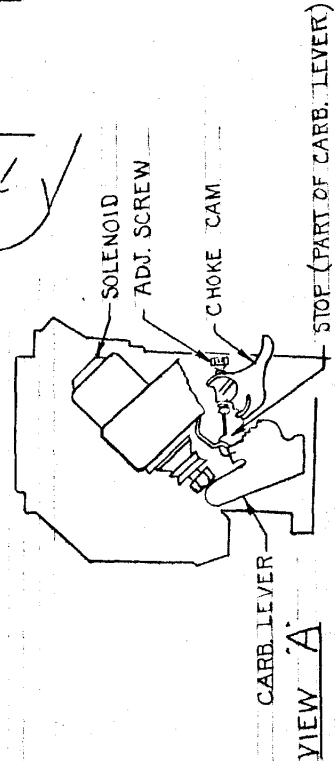
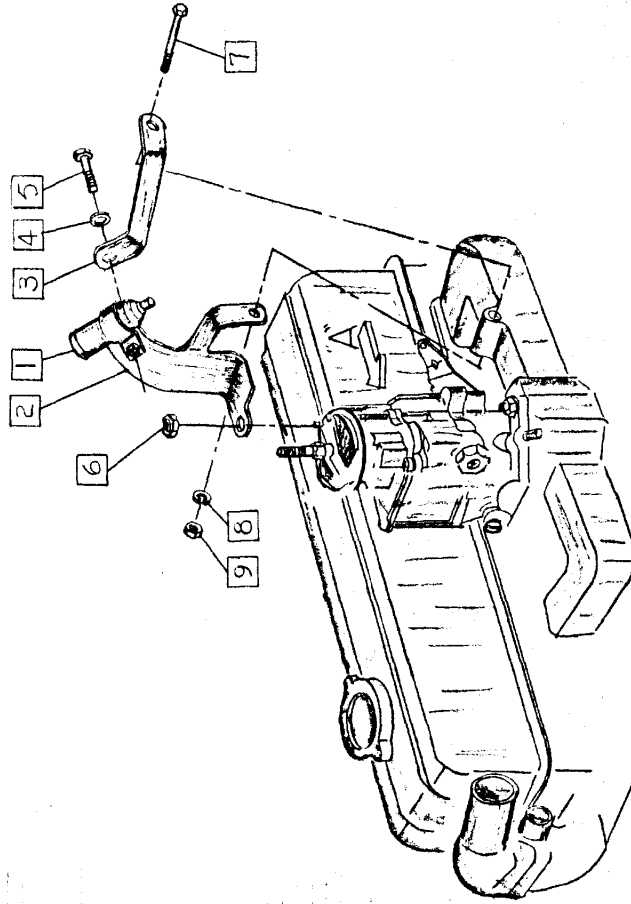

CHECKER MOTORS CORP. KALAMAZOO, MICH.

EFFECTIVE OCT. 1, 1969

MODEL: B-11 B-11E
B-12 B-12E

GRAPHIC ILLUSTRATION

DWN. DEKKER
CHK. S.K.B.

SHEET NO. 92 A-6

B-12W

CARBURETOR IDLE CONTROL - V-8 - AUTO. TRANS.

APVVD.

CANCELLED OCT 1 1970

SOLENOID VALVE ADJUSTING

1. 703212 SOLENOID ASSEM. - CARB. IDLE CONTROL
2. 703655 BRACKET ASSEM.
3. 704554 CLAMP - CARB. IDLE CONTROL SOLENOID.
4. 120392 WASHER $\frac{3}{32}$ ID. * $\frac{5}{8}$ O.D.
5. 121887 BOLT $\frac{1}{4}$ - 20 * $\frac{3}{4}$ HEX.
6. 703625 WIRE ASSEM. - CARB. SOLENOID
7. EXISTING CLIP

1. TIGHTEN BRACKET TO FRONT CARB. STUDS SECURELY WITH CLAMP LOOSELY INSTALLED TO BRACKET.

2. SET THE CARB. IN THE CLOSED POSITION WITH THE CHOKE COMPLETELY OFF.

3. WITH SOLENOID ENERGIZED (POWER ON) AND PLUNGER EXTENDED, SLIDE SOLENOID INTO THE BRACKET SO THE SOLENOID PLUNGER JUST CONTACTS THE CARB. THROTTLE LEVER. TIGHTEN THE BRACKET CLAMP TO SECURE SOLENOID IN PLACE.

4. BACK CARB. ADJUSTING SCREW OUT (1) TURN. (COUNTER-CLOCKWISE)

CANCELLED

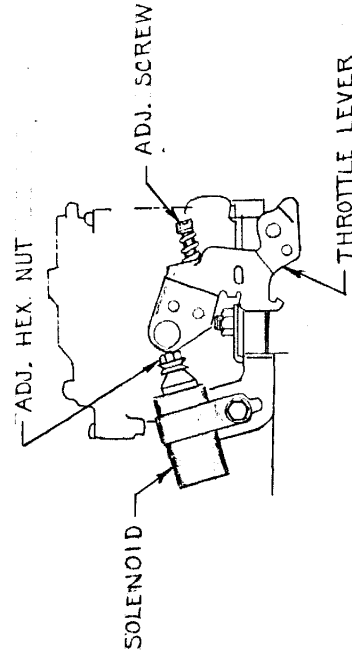
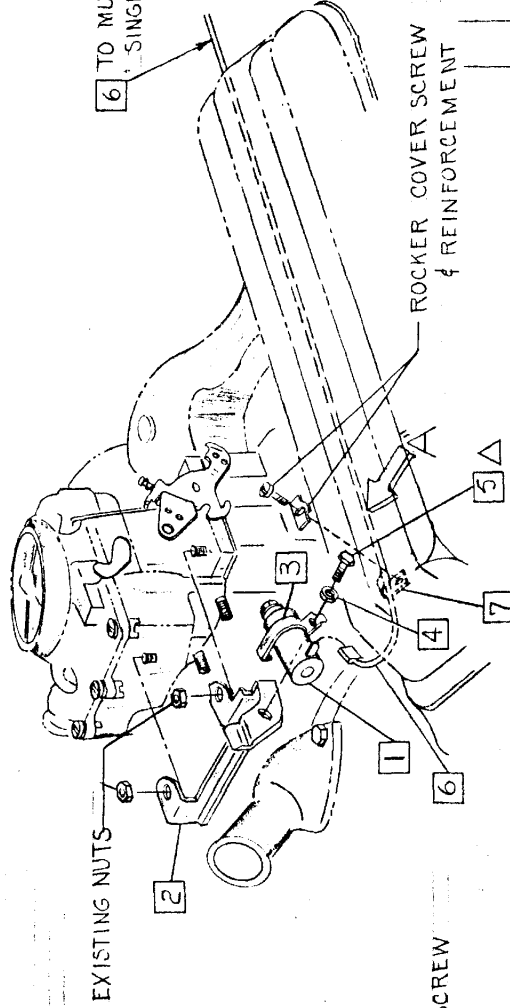

VIEW IN DIRECTION OF ARROW 'A'

CHANGE'S