

CHECKER MOTORS CORP. KALAMAZOO, MICH.

EFFECTIVE SEPT 1, 1968

MODEL: A-11
A-11E

DATE
12-7-68

GRAPHIC ILLUSTRATION

REAR WINDOW DEFOGGER INSTALLATION (CAB)

DWN. DEKKER
CHK. SE 1-9-69

SHEET NO. 626-A

APPVD. MODEL YEAR 1968, 1969.

1. 645664 BLOWER ASSEM. - REAR WINDOW DEFOGGER
2. 645665 GRILLE ASSEM. - AIR OUTLET
3. 644488 COVER - HOLE TRIM
4. 138479 L.W. *10 EXT. TOOTH (3)
5. 120361 NUT *10-24 HEX. (3)
6. 645848 WIRE ASSEM. - SW. TO REAR DEFOGGER
7. 635534 SWITCH ASSEM. - FLOOR MTG. HEATER
8. 136857 L.W. 7/16 EXT. TOOTH
9. 631260 KNOB & SCREW ASSEM.
10. 702352 BRACKET - REAR WINDOW DEFOGGER
11. 157767 SCREW - 5/16-18 * 3/8 TRUSS HD. C.R. (2)
12. 138485 L.W. 5/16-EXT. TOOTH (2)

13. 120376 NUT 5/16-18 HEX. (2)
14. 644490 PANEL - SHELF TRIM.
15. 644491 PANEL - SHELF TRIM.
16. 80361 CLIP 3/8 TUBE (2)
17. 626456 SCREW & WASHER ASSEM. * 8 * 3/4 (3)
18. 635279 LEAD ASSEM.
19. 97453 CIRCUIT BREAKER ASSEM.
20. 635556 CABLE ASSEM.
21. 138479 L.W. *10 EXT. TOOTH (2)
22. 120614 NUT *10-32 HEX. (2)

DASH MOUNTED
CIRCUIT BREAKER

DRIVERS DOME
LIGHT SW.

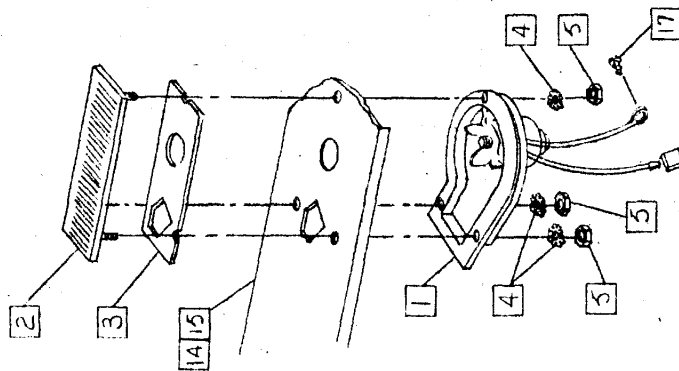

VIEW IN DIRECTION OF ARROW 'B'

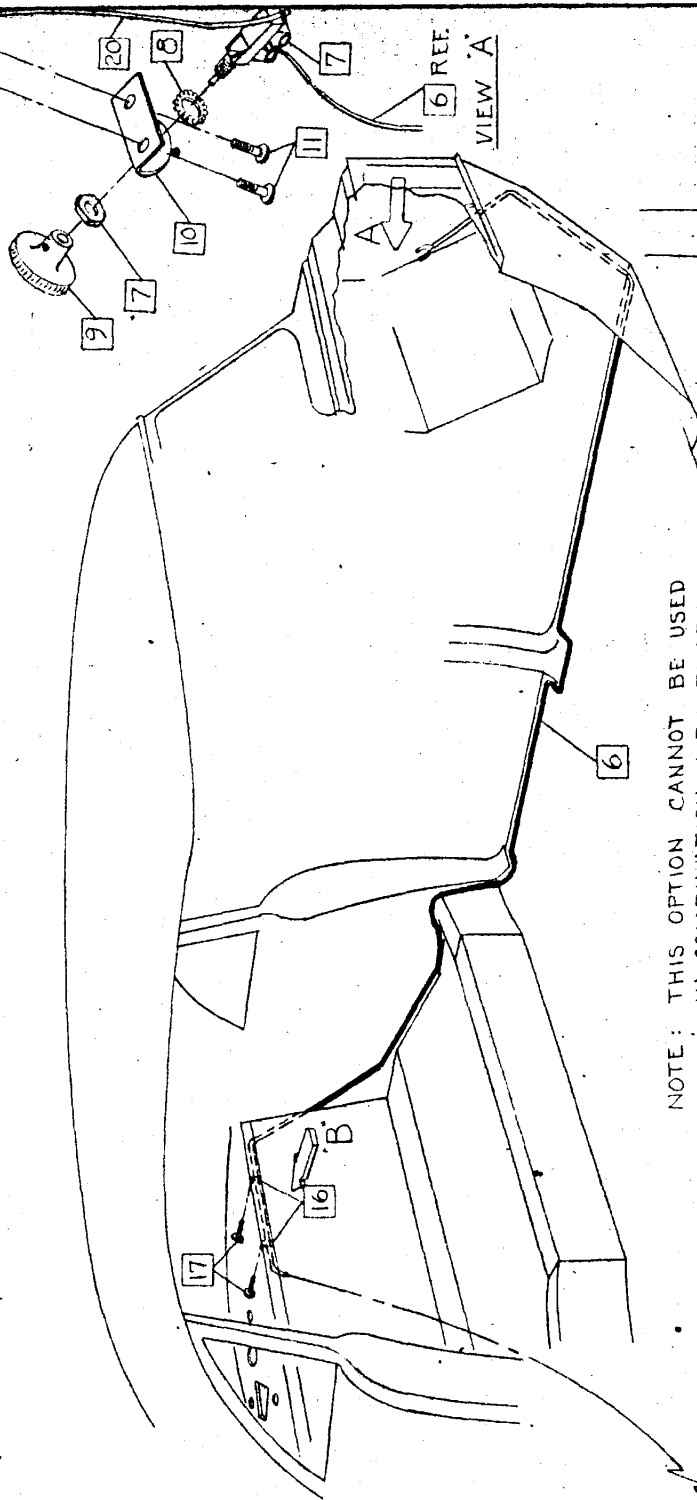

NOTE: THIS OPTION CANNOT BE USED
IN COMBINATION WITH REAR
SEAT SPEAKER OR REAR AIR COND.

2-17-68 80361 WAS 626535
CHANGE 'S

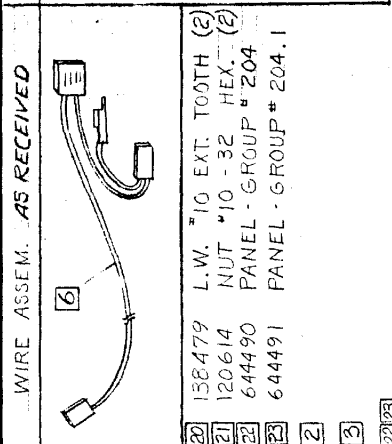
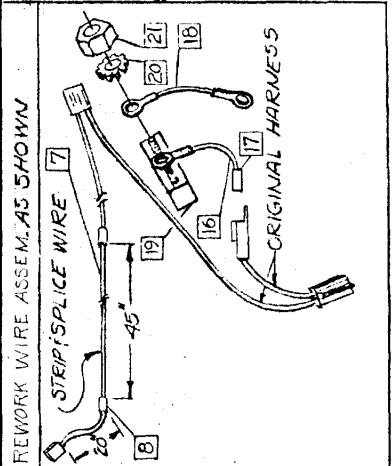
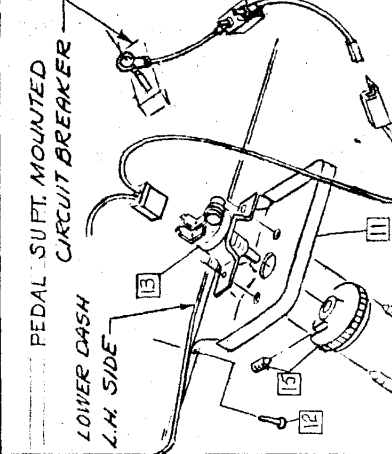

- 1 645664 BLOWER ASSEM.
- 2 645665 GRILLE ASSEM.
- 3 644488 COVER
- 4 138479 L.W. #10 EXT. TOOTH (3)
- 5 120361 NUT #10-24 HEX. (3)
- 6 645668 WIRE ASSEM.
- 7 644502 WIRE EXTENSION
- 8 626810 SPLICER (2)
- 9 626535 CLIP (2)
- 10 626456 SCREW & WASHER ASSEM. # 6 x 3/4 (5)
- 11 644469 BRACKET
- 12 161895 SCR. #10 1/2 PHCR (2)
- 13 645666 SWITCH ASSEM.
- 14 9423637 SCR. # 0 x 1/2 PHCR (2)
- 15 645667 KNOB ASSEM.
- 16 701866 WIRE ASSEM.
- 17 626809 CONN. BODY
- 18 635279 LEAD ASSEM.
- 19 97453 CIRCUIT BREAKER

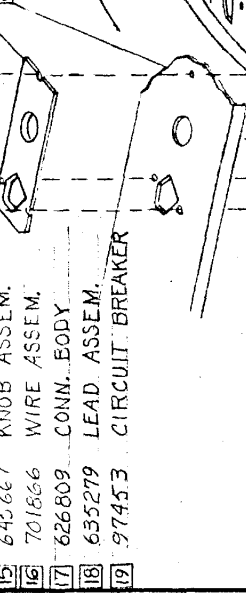
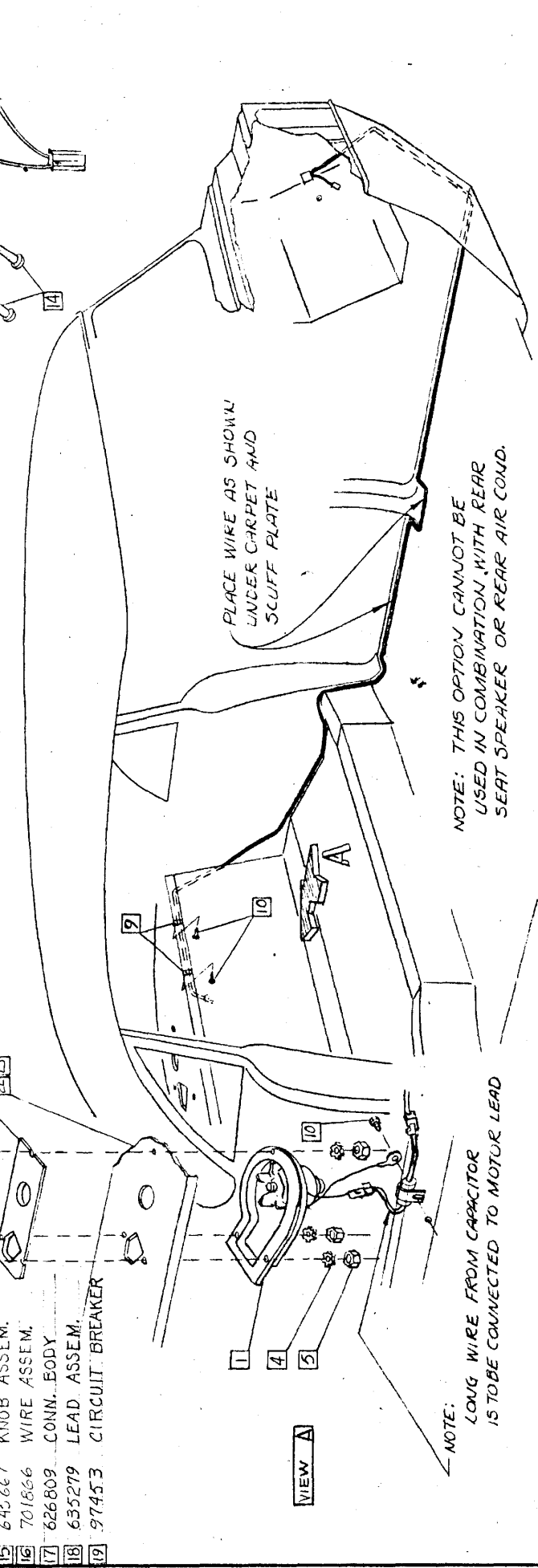

* ITEMS FURNISHED IN # 645663 KIT.

OBSOLETE - DESIGN CHANGE - SEE G.I. 626-A