

EFFECTIVE JAN. 1, 1968

CHECKER MOTORS COEP., KALAMAZOO, MICH.

585

SHEET NO.

DESIGN. DEGREE
CHK. DE 1-22-68
APP'D.

GRAPHIC ILLUSTRATION

ENGINE MTC. - REAR

DATE
1-23-68

MODEL 9-11 CHASSIS
TYPE 1-137 8-12 M/G
APPLS TO 1-12 5-12 M/G

- 7 701842 - SUPPORT ASSEM.
- 2 187612 - BOLT (2)
- 3 120395 - WASHER (4)
- 4 272684 - LOCK NUT (2)
- 5
- 6 702062 - CLAMP (2)
- 7 120384 - L.W. (2)
- 8 180173 - BOLT (2)
- 9 FRAME INNER RAIL - RIGHT SIDE
- 10 120383 - L.W. (2)
- 11 180144 - BOLT (2)
- 12 702542 - SPACER
- 13 701133 - MOUNTING ASSEM. - GCYL
- 14 701369 - MOUNTING ASSEM. - V-8

- △ 25 - 30 LBS. FT.
- △ 35 - 65 LBS. FT. (CAST IRON)
- 40 - 50 LBS. FT. (ALUMINUM)

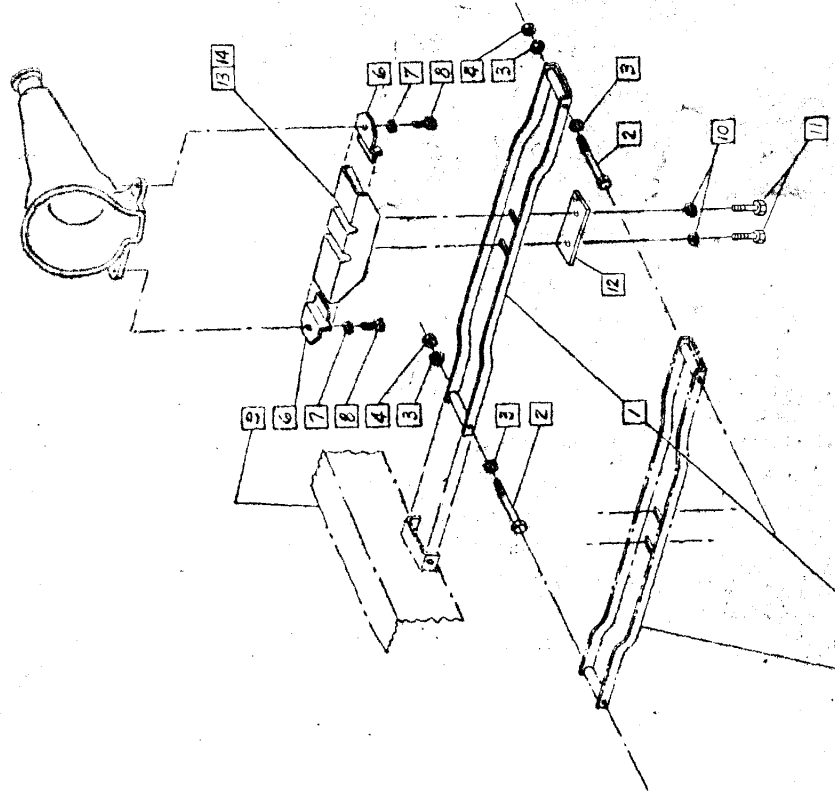

ITEM 1, SHOWN FOR 6 CYL. ENGINE INSTALLATION
ROTATE 180° FOR V-8 ENGINE INSTALLATION