

CHECKER MOTORS CORP. KALAMAZOO, MICH.

EFFECTIVE SEPT. 1, 1968

DWN. DEKKER  
CHK. JONES

SHEET NO. 454-A

DATE

9-20-68

GRAPHIC ILLUSTRATION

A.I.R. EQUIPMENT - EXHAUST GAS COMBUSTION AIR PIPE

MODEL: B-11 B-11E B-12 B-12E B-12 W

MODEL YEAR 1969

1. 703061 PIPE ASSEM.
2. 703117 VALVE ASSEM.
3. 702912 PIPE EXTENSION

△ 150-175 LBS. IN.  
△ 14-20 LBS. FT.

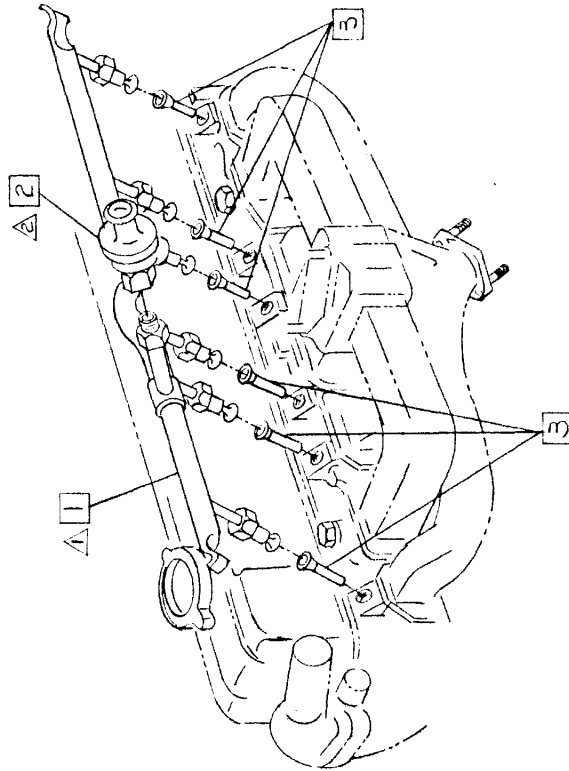

1. 703117 VALVE ASSEM.
2. 703414 PIPE ASSEM. - L.H.
3. 703415 PIPE ASSEM. - R.H.

△ 150-175 LBS. IN.  
△ 14-20 LBS. FT.

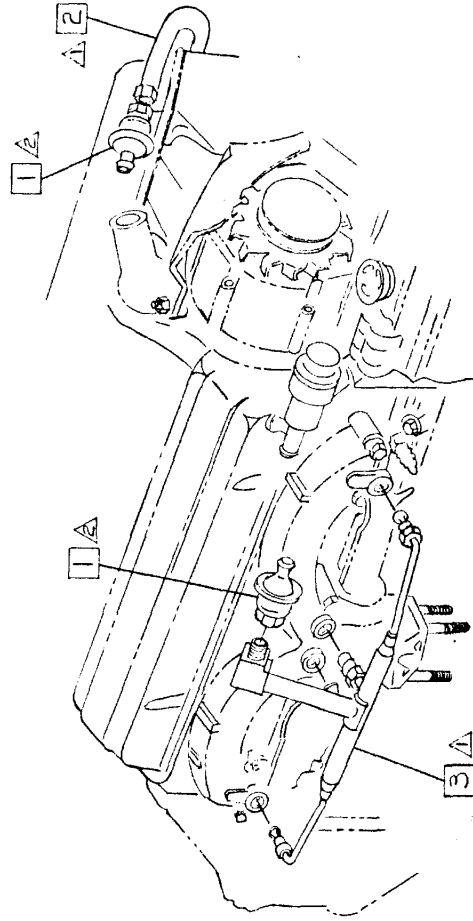

STANDARD TRANS. 250 CU. IN. 6CYL

STANDARD TRANS. 327+350 CU. IN. V-8

EFFECTIVE JAN. 1, 1968

CHECKER MOTORS CORP. KALAMAZOO, MICH.

MODEL: A-11 A-12 A-12W A-11E A-12E CHASSIS	DATE 1-1-68	GRAPHIC ILLUSTRATION A.I.R. EQUIPMENT-EXHAUST GAS COMBUSTION AIR PIPES	DWN. PIERCE CHK. DE 1-2-68	SHEET NO. 454
			APPVD.	

- 1 703061 PIPE ASSEM.
- 2 703117 VALVE ASSEM.
- 3 702912 PIPE-EXTENSION

△ 150-175 LBS. IN.  
△ 14 - 20 LBS. FT.

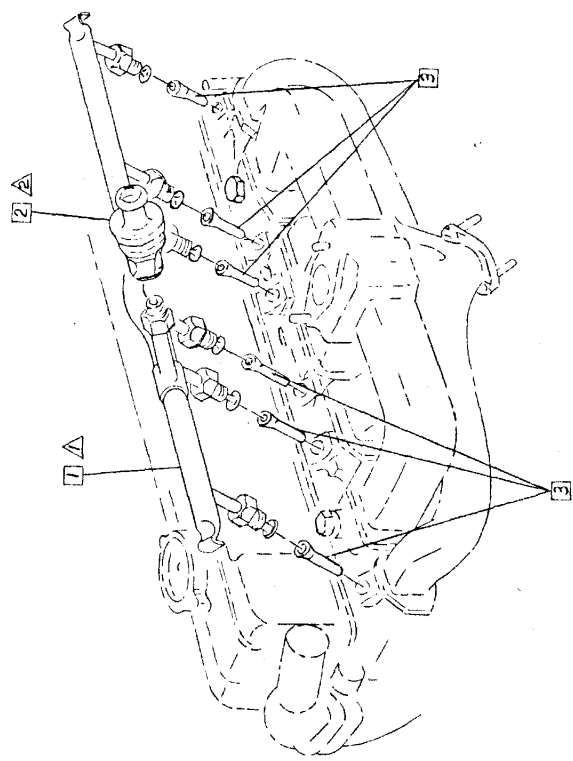

- 2 703117 VALVE ASSEM.
- 4 701825 PIPE ASSEM.

△ 150-175 LBS. IN.  
△ 14 - 20 LBS. FT.

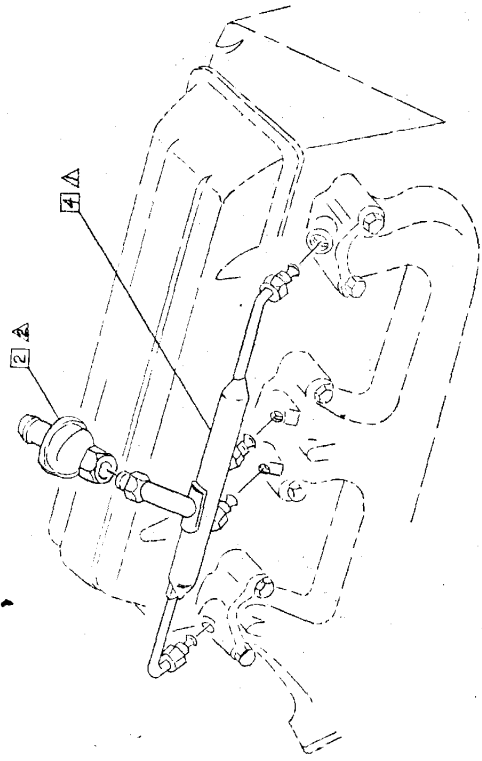

OBsolete PER MEMO #219 SEE G.I. 454-A

STANDARD TRANS. 6 CYL.

307 STD. TRANS.

V-8