

EFFECTIVE JAN. 1, 1968

CHECKER MOTORS CORP., KALAMAZOO, MICH.

744

SHEET NO.

D.W. DENKER
CHK. 3-25-68

APPRO

GRAPHIC ILLUSTRATION
TAILGATE - MANUAL - CONTINUED

DATE
3-15-68

BODY

MODEL
A-12W
A-12WB

THIS ASSEMBLY SHOWN IN POSITION IN 1/4
BY GI-743

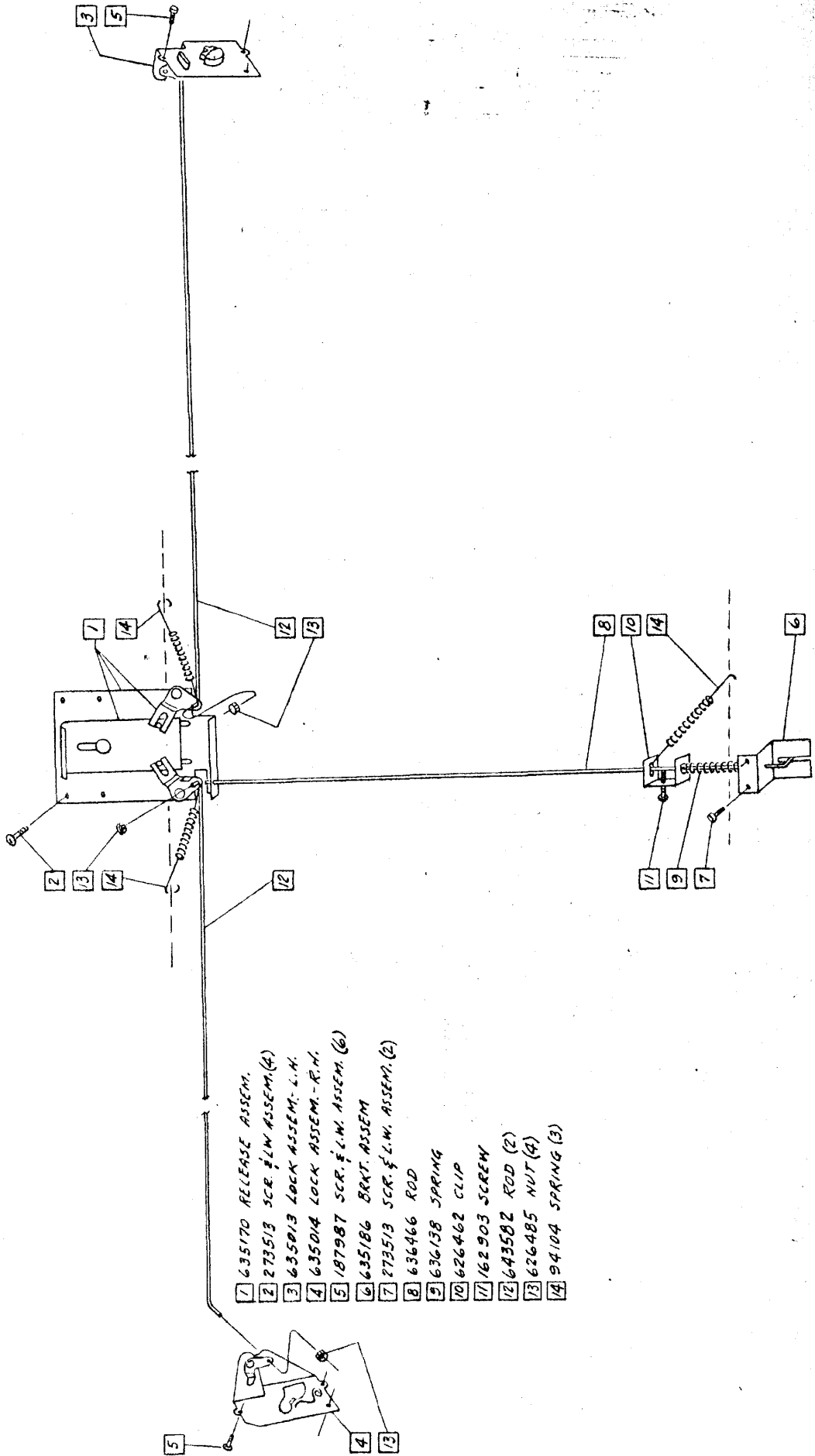

- 1 635170 RELEASE ASSEM.
- 2 273513 SCR. & L.W. ASSEM. (4)
- 3 635013 LOCK ASSEM. - L.H.
- 4 635014 LOCK ASSEM. - R.H.
- 5 187987 SCR. & L.W. ASSEM. (6)
- 6 635186 BRKT. ASSEM.
- 7 273513 SCR. & L.W. ASSEM. (2)
- 8 636466 ROD
- 9 636138 SPRING
- 10 626462 CLIP
- 11 162903 SCREW
- 12 643582 ROD (2)
- 13 626485 NUT (4)
- 14 94104 SPRING (3)

(1) ADD'L. COPY BODY ENGR.