

EFFECTIVE JAN. 1, 1968

CHECKER MOTORS CORP., KALAMAZOO, MICH.

MODEL 8-12WB CHASSIS DATE 2-12-68 SHEET NO. 738

DWM DEXER  
CHK RCP 2-29-68

APPROVED

GRAPHIC ILLUSTRATION  
REAR SUSPENSION - AEROBUS

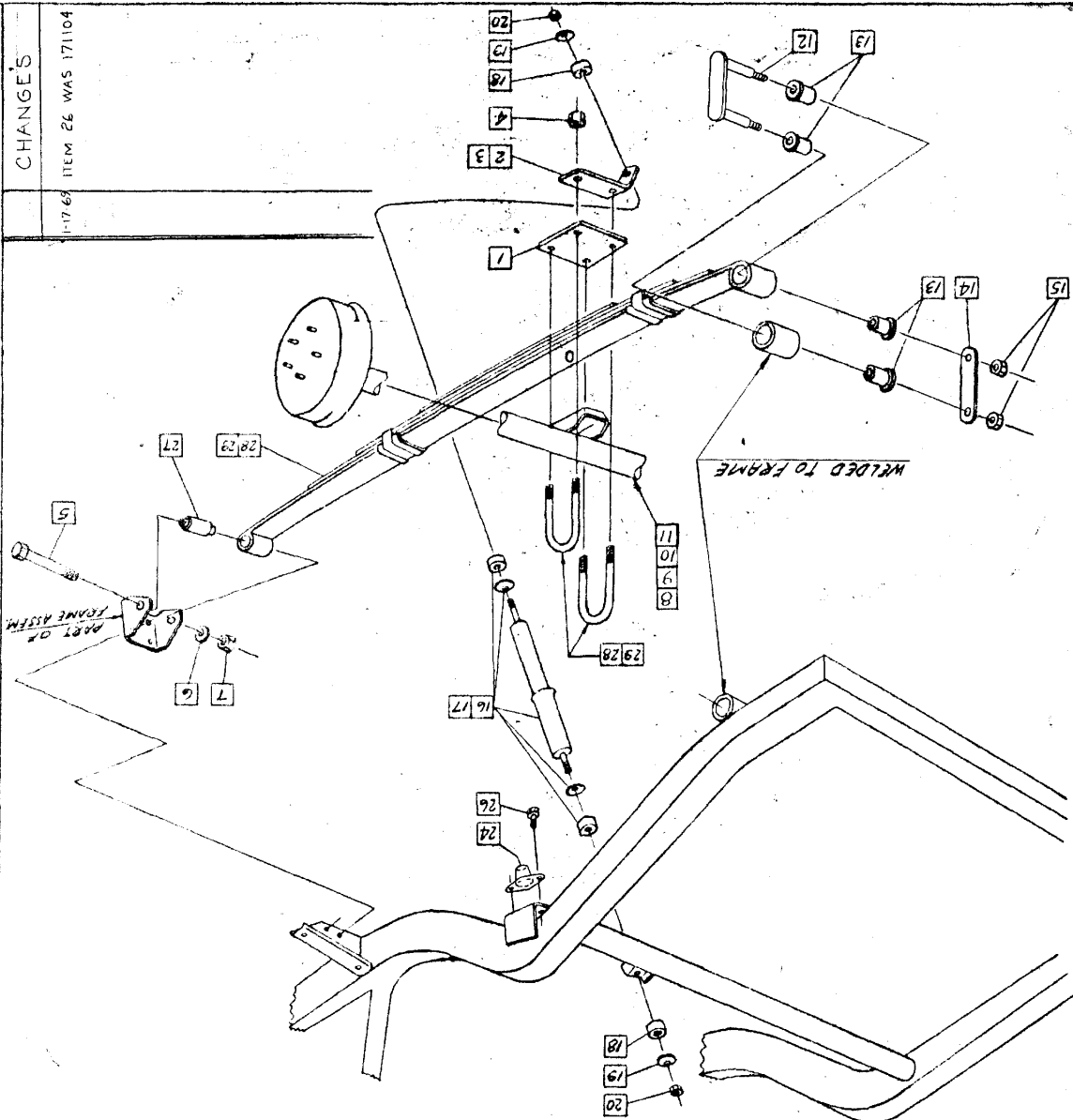

CHANGES  
17-69 ITEM 26 WAS 171104

MODEL 8-12WB CHASSIS DATE 2-12-68 SHEET NO. 738

DWM DEXER  
CHK RCP 2-29-68

APPROVED

GRAPHIC ILLUSTRATION  
REAR SUSPENSION - AEROBUS

DWM DEXER  
CHK RCP 2-29-68

SHEET NO. 738

- 1 702603 PLATE (2)
- 2 98301 BRKT-L.H.
- 3 98302 BRKT-R.H.
- 4 65198 NUT (8)
- 5 271758 BOLT(2)
- 6 121574 L.W.(2)
- 7 121558 NUT(2)
- 8 701436 - 3.54 AXLE
- 9 701437 - 3.54 ROWR LOK.
- 10 701435 - 4.10 AXLE
- 11 701439 - 4.10 ROWR LOK.
- 12 95634 - PLATE & PIN(2)
- 13 96153 BUSHING(2)
- 14 80768 PLATE(2)
- 15 443340 NUT(4)
- 16 701966 SHOCK ASS. - (2) B-12WB
- 17 701967 SHOCK ASS. - (2) B-12WB
- 18 704142 INSULATOR(4)
- 19 94408 WASHER(4)
- 20 442828 NUT(4)
- 21
- 22
- 23
- 24 95651 BUMPER(2)
- 25 448665 SCREW(4)
- 26 95644 BEARING(2) FURN. W/SPRING
- 27 95645 SPRING(2) B-12WB
- 28 702602 CLIP(4)
- 29 95646 SPRING(2) B-12WB
- 30 98326 CLIP(4)