

40,000 - 1-1-1965

CHECKER MOTORS CORP. KALAMAZOO, MICH.

EFFECTIVE JAN. 1, 1965

MODEL: B-12W6 CHASSIS	DATE	DWN. BY: J. J. JONES	SHEET NO. 564
B-12W8	2-14-65	CHK. BY: G. K. S.	
GRAPHIC ILLUSTRATION		APPVD.	
CRANKCASE VENT - ALFORD'S			

1. 126177 WING NUT
2. 703159 AIR CLEANER
3. 703169 STUD ASSEM.
4. 702894 GASKET (2)
5. 701374 CAP. RETOR ASSEM.
6. 704327 HOSE
7. 704114 CONNECTOR
8. 704146 GROMMET - (2)
9. 702104 CLAMP - (2)
10. 704350 CONNECTOR
11. 120368 NUT (4)
12. 120214 L.W. (2) REAR STUDS ONLY
13. 702257 WASHER (2) FRONT STUDS ONLY
14. 702192 GASKET
15. 704228 HOSE
16. 703105 VALVE ASSEM.
17. CAP ASSEM. TO BE FURN. IN ENGINE
18. TUBE ASSEM. TO BE FURN. IN ENGINE
- 19.
- 20.
21. 702572 CONNECTOR
22. 704445 HOSE TO BRAKE MASTER CYL.
23. 272846 CLAMP (2)
24. 444028 BUSHING
25. 704325 EXTENSION
26. 701980 POWER BRAKE CYL.

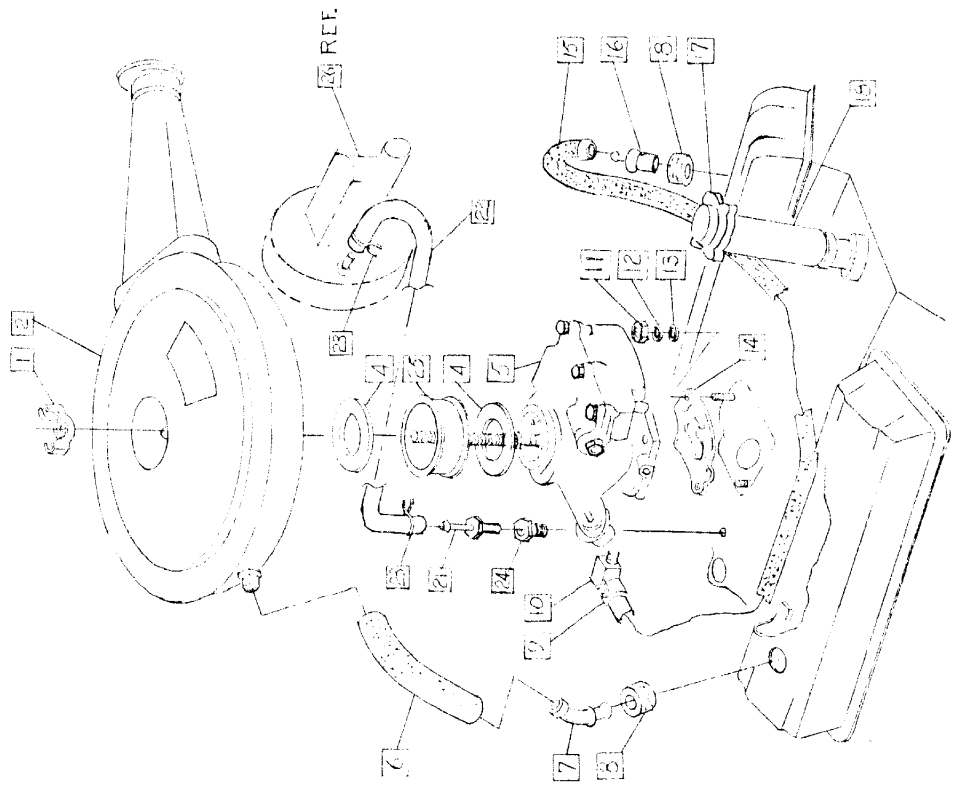

OBSOLETE PER MEMO # 219 SEE G.I. 561-A