

CHECKER MOTORS CORP. KALAMAZOO, MICH.

MODEL: B-11 CHASSIS	DATE	GRAPHIC ILLUSTRATION	SHEET NO.
B-12 B-12 W	1-12-68	AIR COND. WITH POWER STEERING - 6-CYL. - STD. TRANS.	407
B-12 E		APPVD.	

- 1- 701756 COMP. ASSEM.
- 2- 703178 TUBE ASSEM.
- 3- 120369 NUT
- 4- 120382 L. W. (13)
- 5- 701263 BRKT. ASSEM.
- 6- 702370 SPACER
- 7- 702223 BRACE
- 8- 701228 CLUTCH ASSEM.
- 9- 454222 BOLT (2)
- 10- 702169 FULLEY - W.P.-REF.
- 11- 702215 FULLEY - W.P.
- 12- 702326 SPACER
- 13- 701224 FAN ASSEM.
- 14- 120214 L.W. (4)-REF.
- 15- 454289 BOLT (4)-REF.
- 16- 181829 BOLT (3)-REF.
- 17- 702244 FULLEY - C.S.
- 18- 701907 IGN. COIL - REF.
- 19- 702320 BRACE
- 20- 454904 BOLT (4)
- 21- 186679 BOLT
- 22- 178551 L.W.
- 23- 186679 BOLT (4)
- 24- HARMONIC BALANCER - REF. DUAL GROOVE - (FURN. ON ENGINE)
- 25- 454922 BOLT
- 26- 120394 WASHER (5)
- 27- 702372 BRKT.
- 28- 442828 LOCK NUT
- 29- 701264 SUPPLY ASSEM.
- 30- 97639 PULLEY ASSEM.
- 31- 120388 WASHER
- 32- 120383 L.W.
- 33- 271501 NUT
- 34- 454906 BOLT (2)
- 35- BATTERY GR. CABLE HERE WITH A/C
- 36- 702159 BELT.

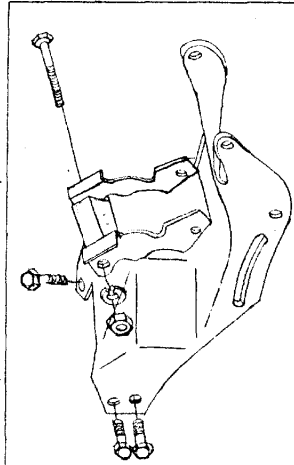
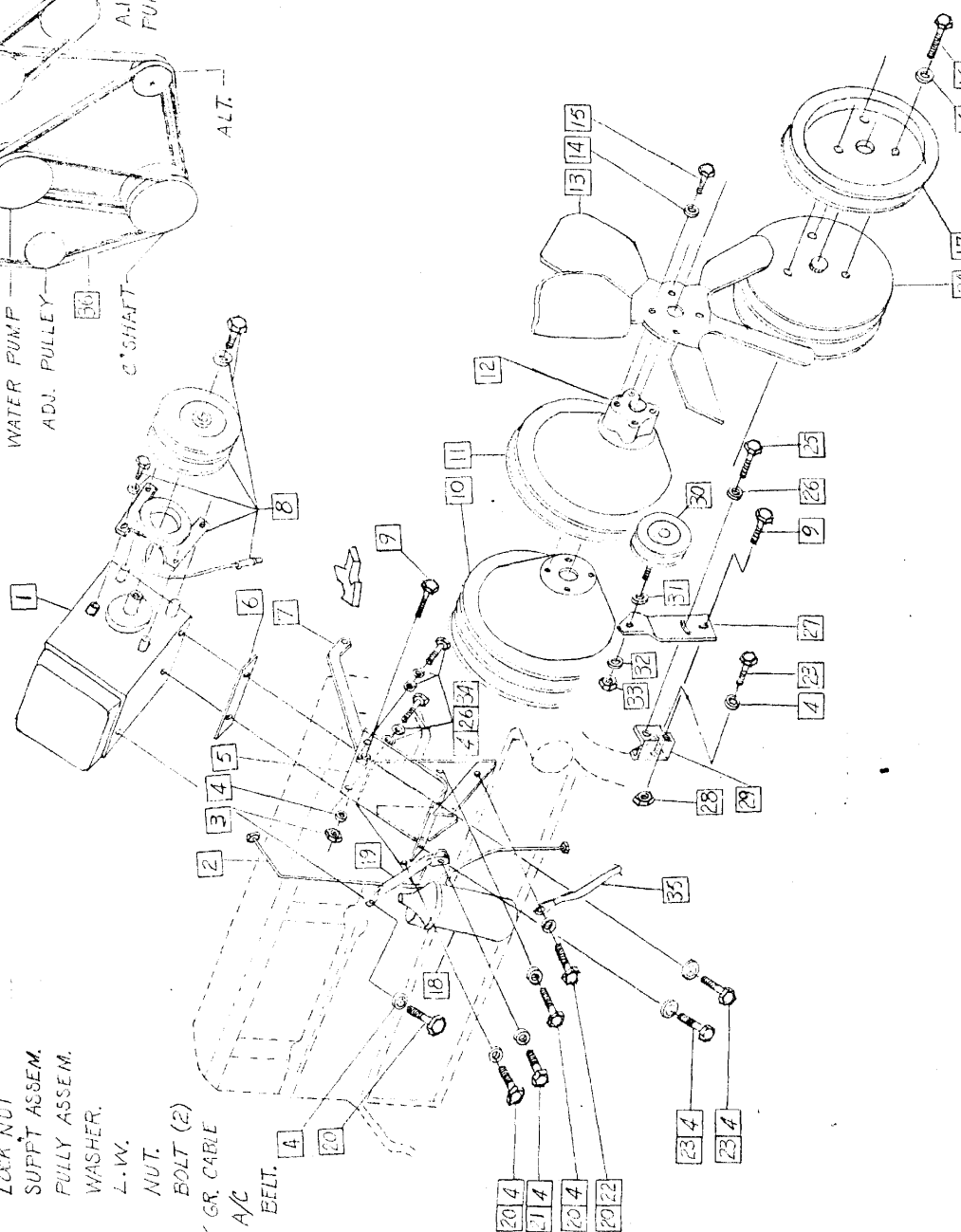
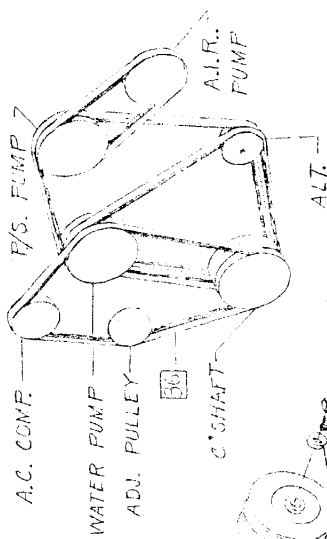

VIEW IN DIRECTION OF ARROW

OBSOLETE - SEE G.I. 406-A