

CHECKER MOTORS CORP. KALAMAZOO, MICH.

EFFECTIVE SEPT 1, 1968

DWN. DENKER	SHEET NO. 413-A
CHK. JONAS	
APPVD. MODEL YEAR 1969	

MODEL: DIESEL	DATE 10-23-68	GRAPHIC ILLUSTRATION
		A/C COMPRESSOR* MTG. - DIESEL (FRIGIDAIDE)

1. 703389 COMPRESSOR & CLUTCH ASSEM.
2. 703132 BRACKET ASSEM. - FRONT
3. 120369 NUT $\frac{3}{8}$ "-24 HEX. (2)
4. 120362 L.W. $\frac{3}{8}$ " MED. SPRING (6)
5. 703100 BRACKET ASSEM. - REAR
6. 181608 BOLT $\frac{3}{8}$ "-24 * 1 HEX. (2)
7. 120214 L.W. $\frac{3}{8}$ " MED. SPRING (4)
8. 704213 PLATE
9. 704211 SPACER
10. 180128 BOLT $\frac{3}{8}$ "-16 * 1 $\frac{1}{4}$ " HEX.
11. 704212 SPACER
12. 454906 BOLT $\frac{3}{8}$ "-16 * 1 $\frac{1}{2}$ " HEX.
13. 120377 NUT $\frac{3}{8}$ "-16 HEX.
14. 181595 BOLT $\frac{3}{8}$ "-24 * $\frac{3}{4}$ " HEX (2)
15. 704223 BRACE
16. 446363 WASHER $\frac{3}{8}$ " I.D. * $\frac{7}{8}$ " O.D.
17. 181637 BOLT $\frac{3}{8}$ "-24 * 1 HEX.
18. 701668 BRACKET ASSEM.
19. 120554 BOLT $\frac{1}{4}$ "-20 * $\frac{3}{8}$ " HEX.
20. 120380 L.W. $\frac{1}{4}$ " MED. SPRING

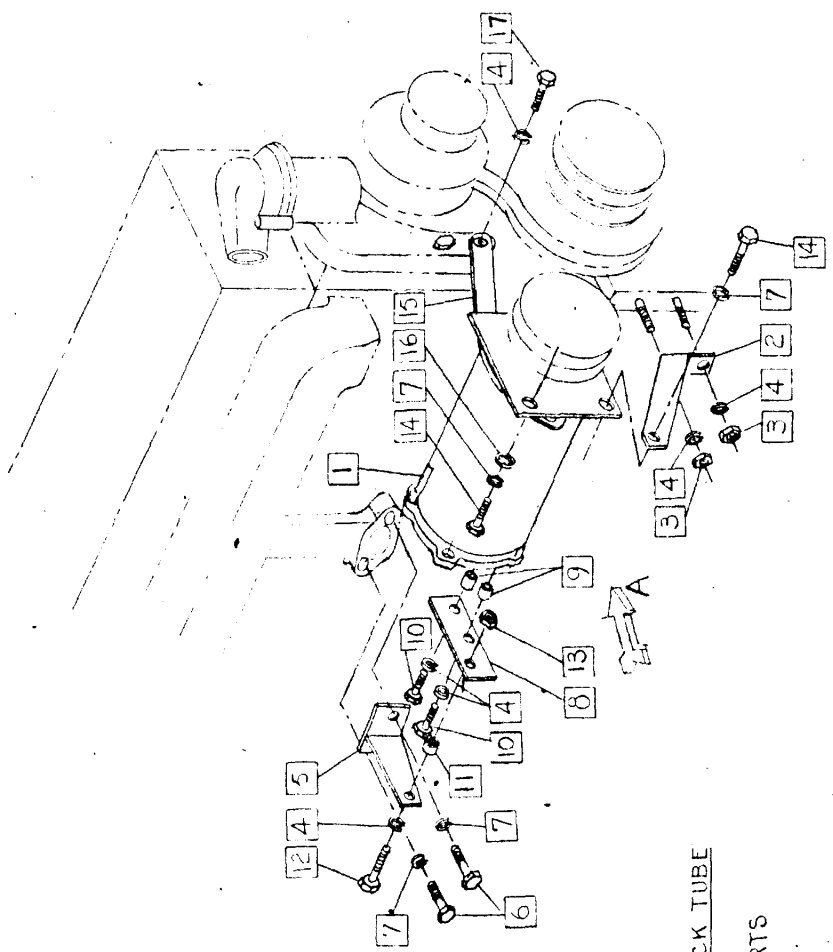

RELOCATION OF OIL DIPSTICK TUBE
ARROW 'A'

