

REVISED: 10-28-64 / 11-6-64 / 5-13-65 / 8-18-66 / 9-27-66 / 1/22/67 /
 ZGF J.K. RCF X.G.
 24

CHECKER MOTORS CORP., KALAMAZOO, MICH.

MODEL B-11 CHASSIS	DATE 2-26-64	CHECKED R.E. 2-25-64	SHEET NO. 221
ALSO APPLIES TO B-12 B-12F B-12WG B-12WB		APPROV. 3-2-64	
GRAPHIC ILLUSTRATIONS			
STARTING MOTOR			

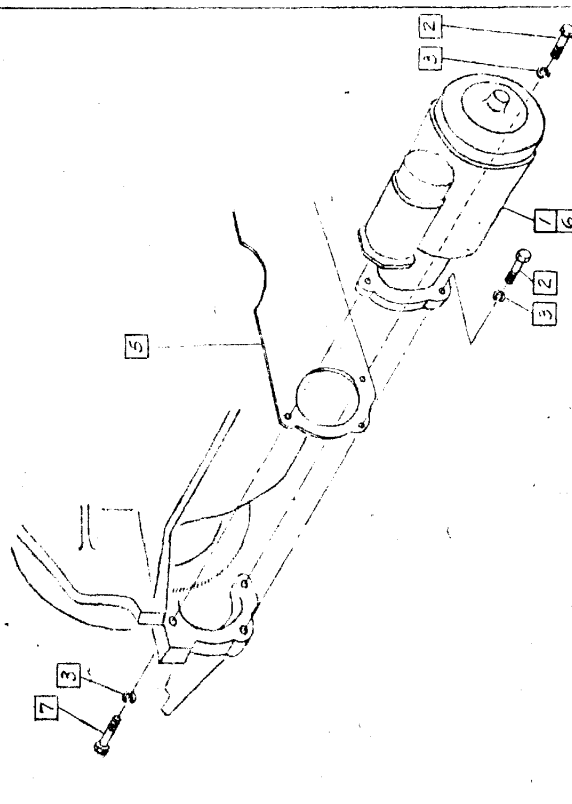

- 1 701547 - MOTOR ASSEM.-STARTING (CYCL & V-8)
- 2 180124 - BOLT (2)
- 3 120382 - L.W. (3)
- 5 PART OF ENGINE AS PURCHASED
- 6 701950 - MOTOR ASSEM.-STARTING (AEROBUS)
- 7 150128 - BOLT (AEROBUS)

▲ 17-25 LBS. FT.

STD. TRANS.
 6CYL & V8-283 cu. in.
 & AEROBUS-327 cu. in.

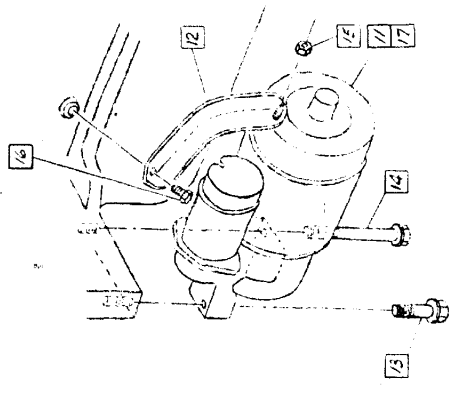

- 1 701949 - MOTOR ASSEM.-STARTING (283 V-8)
- 2 702204 - BRACE
- 3 702203 - BOLT
- 4 702202 - BOLT
- 5 98446-NUT (ELASTIC STOP)
- 6 273867 - SCREW
- 7 701951 MOTOR ASSEM.-STARTING (AEROBUS & HI-PERF)

▲ 30-40 LBS. FT.
 ▲ 15-20 LBS. FT.
 ▲ 5-6 LBS. FT.

AUTO. TRANS.
 V8-283 cu. in.
 & AEROBUS 327 cu. in.
 & HI-PERF 327 cu. in.

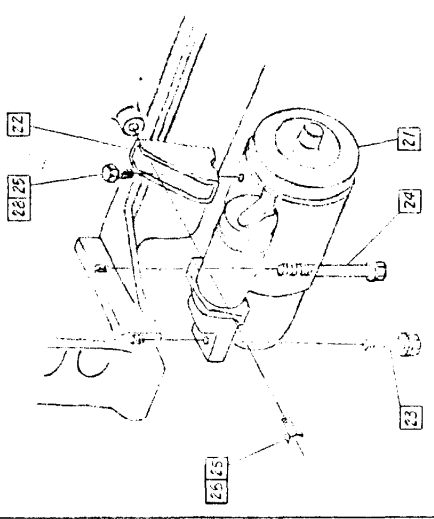

- 1 701945 - MOTOR ASSEM.-STARTING
- 2 702201 - BRACE
- 3 702203 - BOLT
- 4 702202 - BOLT
- 5 273867 - SCREW (2)
- 6
- 7

TIGHTEN TO RECOMMENDED TORQUE AFTER STARTING AND ALL ATTACHING BOLTS HAVE BEEN TORQUED

▲ 30-40 LBS. FT.
 ▲ 15-20 LBS. FT.

AUTO. TRANS.
 6CYL.

(1) ADD'L COPY - B. SUTHERLAND