

REVISED: 1-6-66

CHECKER MOTORS CORP., KALAMAZOO, MICH.

MODEL A-12 W BODY DATE 7-9-65 SHEET 10 269

GRAPHIC ILLUSTRATION
SEAT-REAR MANUAL (STATION WAGON)
DRAWN BY G.E.B. 6-8-65
CON. SKINNER 7-9-65
APPROVED BY [Signature]

1 635101 FRAME ASSEM.-REAR CUSHION

2 635167 BRKT. ASSEM. (2)

3 273802 NUT - LOCK (6)

4 635077 PANEL ASSEM.-L.H.

5 635078 PANEL ASSEM.-R.H.

6 626480 SCREW, L.W. (4)

7 636124 PLATE - ANTI-SKID (4)

8 636196 BUSHING (2)

9 636195 BUSHING (12)

10 626482 "X" WASHER (12)

11 635129 LINK ASSEM.-L.H.

12 635130 LINK ASSEM.-R.H.

13 626478 WASHER - WAVE (10)

14 635177 HINGE ASSEM. (2)

15 626467 SCREW, L.W. (16)

16 636369 LINK - L.H.

17 636370 LINK - R.H.

18 639897 TUBE ASSEM.

19 639873 BRKT. ASSEM.-L.H.

20 639874 BRKT. ASSEM.-R.H.

21 626448 JACK NUT (6)

22 626516 L.W. (6)

23 189129 SCREW (6)

24 643525 PANEL ASSEM.-FOLLOWER

25 168288 SCREW (7)

26 643523 PANEL ASSEM.-FRONT AUX. FLOOR

27 643527 PANEL ASSEM.-REAR SEAT BACK

28 622702 BUMPER (2) - INSTALL IN FLOOR PAN

29 643524 PANEL ASSEM. TIRE DOOR FLATEN

30 622542 BUMPER (2)

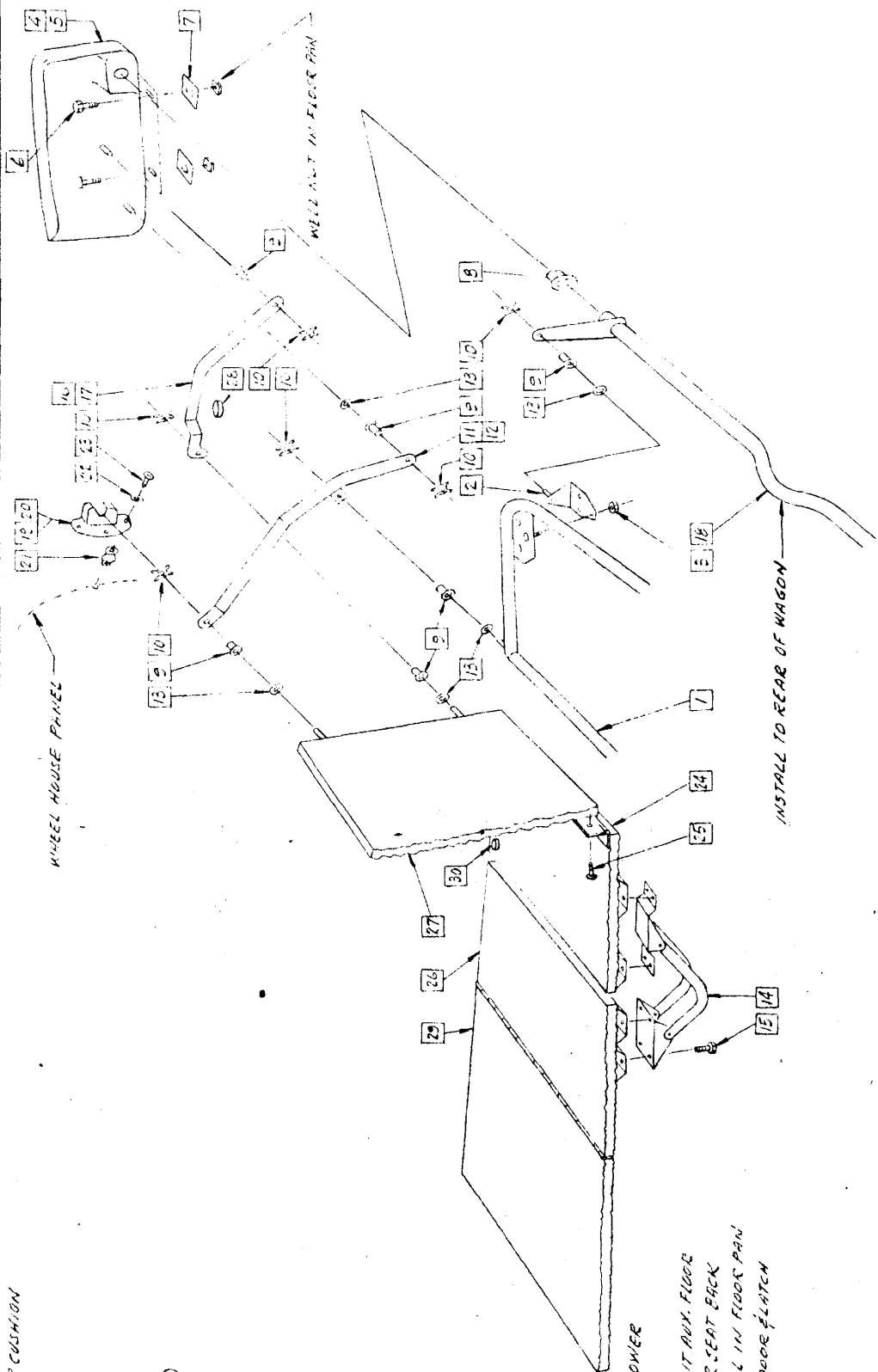

(1) ADDL. COPY BODY ENGR.

