

REVISED: 5-24-65 / J.K. / J.K. / 2-E-65-331-66 / 10-26-66 (3-20-67)

210
 DRAWN BY: J. A. G. /
 CHECKED BY: J. A. G. /

(B-12WB)

5-19-65

MODEL B-12WB

- 1. 701817 EXPANSION PIPE (8)
- 2. 702274 EXTENSION #1
- 3. 701645 BRKT. ASSEM.
- 4. 98560 L. END BRKT. #2
- 5. 701695 R. END BRKT. #2
- 6. 702560 PIP. MOUNTING BRKT.
- 7. 97590 RESONATOR ASSEMB.
- 8. 196060 SPRNG. (2)
- 9. 701877 WAVE ASSEMB.
- 10. 702122 BRKT. #2
- 11. 702274 EXTEN. #1
- 12. 702275 FRAME
- 13. 626779 LOCK NUT (6)
- 14. 501457 SCREW (7)
- 15. 702551 CLAMP (2)
- 16. 702435 SPRNG. (2)
- 17. 502255 SCREW (2)
- 18. 502256 SCREW (2)
- 19. 102725 COLL. (8)
- 20. 102726 WASHER (9)
- 21. 102727 STAINL. (8)
- 22. 102728 WASHER (8)
- 23. 102729 COLL. (8)
- 24. 102730 WASHER (8)
- 25. 102731 COLL. (8)

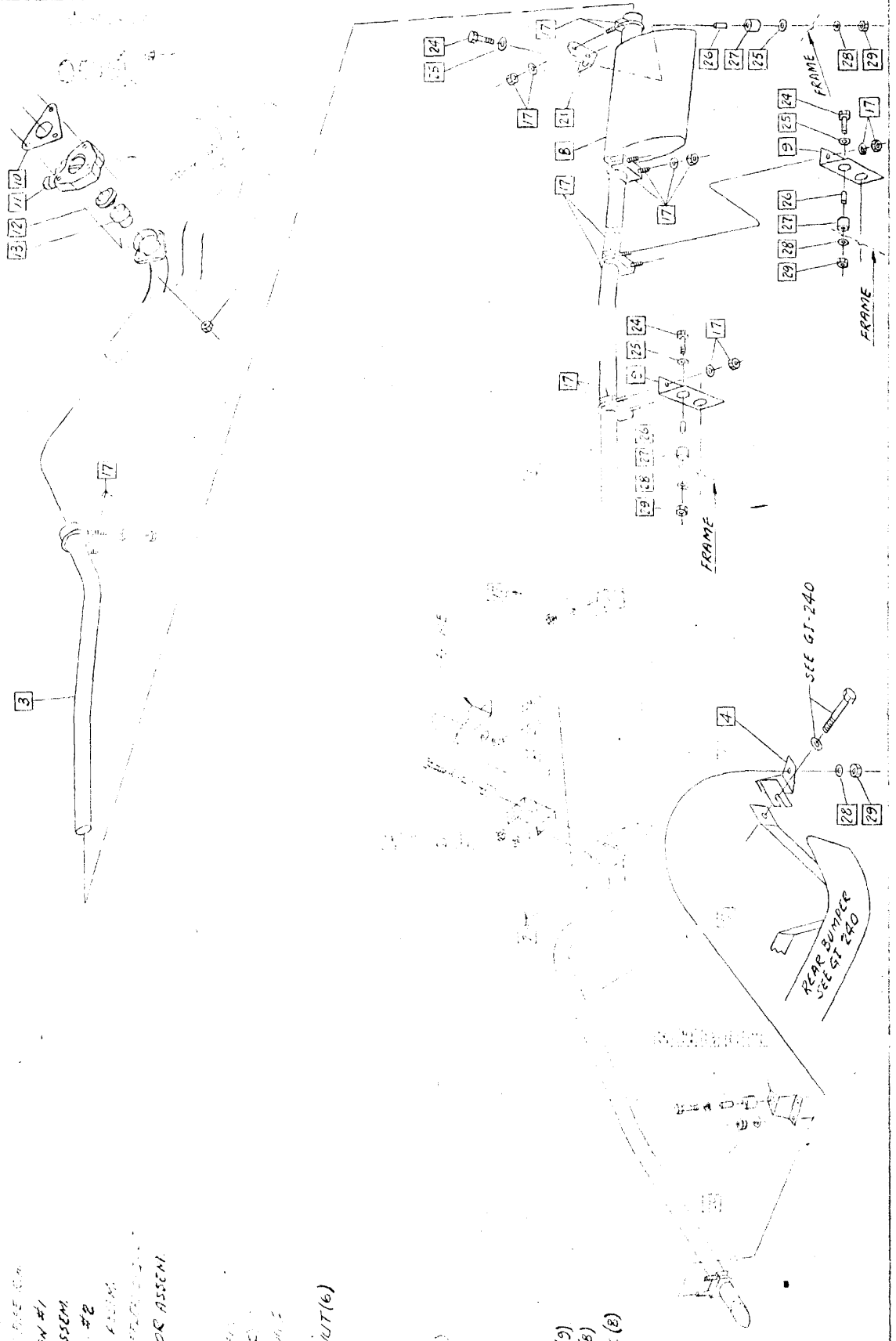

REVISED: 18-8-65 JAK
 18-8-65 JAK
 10-26-65/3-20-67

CHESTER MOTOR CO. CALAMAZOR MACH.

MODEL 3-12KW6	SHEET NO. 53465	210A
DATE 6-1-65	DATE 10/1/64	
	APP'D	

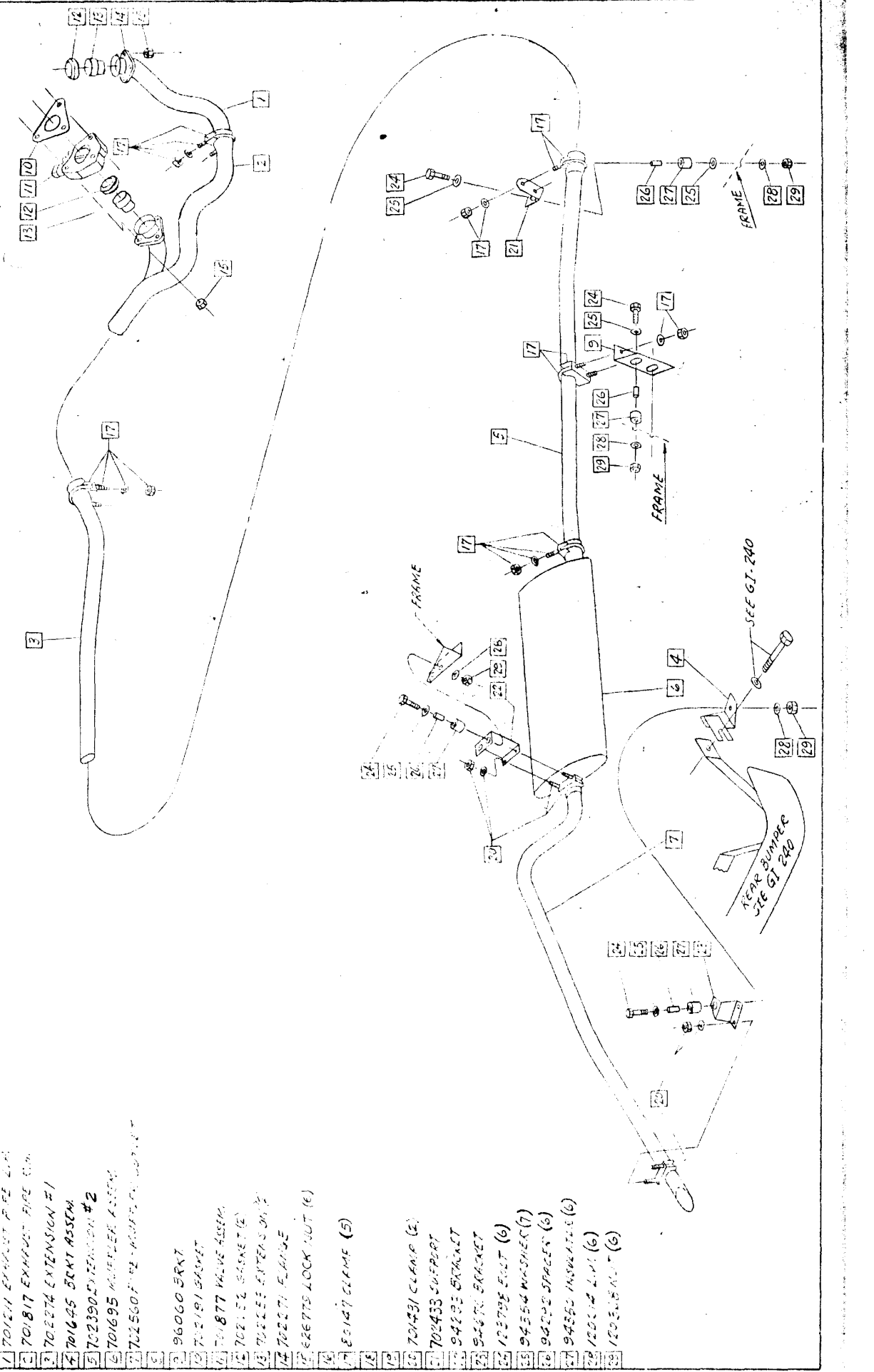

- 1 701211 EXHAUST PIPE 210
- 2 701817 EXHAUST PIPE 210
- 3 702274 EXTENSION #1
- 4 701645 BRKT ASSEM.
- 5 702390 EXTENSION #2
- 6 701695 MUFFLER ASSEM.
- 7 702500 F-42 MUFFLER 210
- 8 96060 BRKT
- 9 7012191 BRKT
- 10 701877 VALVE ASSEM.
- 11 702152 WASHER (E)
- 12 702223 EXTENS. ONLY
- 13 702227 FLANGE
- 14 866715 LOCK NUT (E)
- 15 80147 CLAMP (S)
- 16 701231 CLAMP (E)
- 17 702433 SUPPORT
- 18 94123 BRACKET
- 19 94124 BRACKET
- 20 123795 FLAT (6)
- 21 94554 WASHER (7)
- 22 95225 SPACER (6)
- 23 94550 INSULATOR (6)
- 24 120012 LAMP (6)
- 25 120012 LAMP (6)