

PER ENGR. MEMO #179

CHECKER MOTORS CORP. KALAMAZOO, MICH.

MODEL: A-11 & A-12

DATE: 6/29/67

GRAPHIC ILLUSTRATION

DWN: KING

CHK: BRO 7-11-67

PEDAL SUPPORT- STANDARD TRANSMISSION

SHEET 316

QTY	PART NO.	DESCRIPTION	POWER	NON-POWER
1	703011	SUPPORT ASSEM.	1	1
2	94435	SHAFT	1	1
3	120362	LOCKWASHER	1	1
4	120369	NUT, 3/16-24 HEX.	4	4
5	94431	COVER	2	2
6	703010	PEDAL ASSEM-BRAKE	1	1
7	701248	PEDAL ASSEM-CLUTCH	1	1
8	133115	SCR. 3/16-18 X 3/4	1	1
9	144254	CLEVIS	1	1
10	103585	COTTER PIN-1/8X1	1	1
11	702072	ROD	1	1
12	114785	PIN-CLEVIS	1	2
13	124824	NUT, 5/16-18 HEX. JAM	2	2
14	94771	CAP	1	1
15	702089	SPRING	1	1
16	103573	COTTER PIN- 3/32 X 3/4	1	2
17	701904	BRKT. & SWITCH ASSEM.	1	1
18	701905	RETAINER ASSEM.	1	1
19	120214	LOCKWASHER 5/16 MED.	5	5
20	120376	NUT, 5/16-18 HEX.	5	5

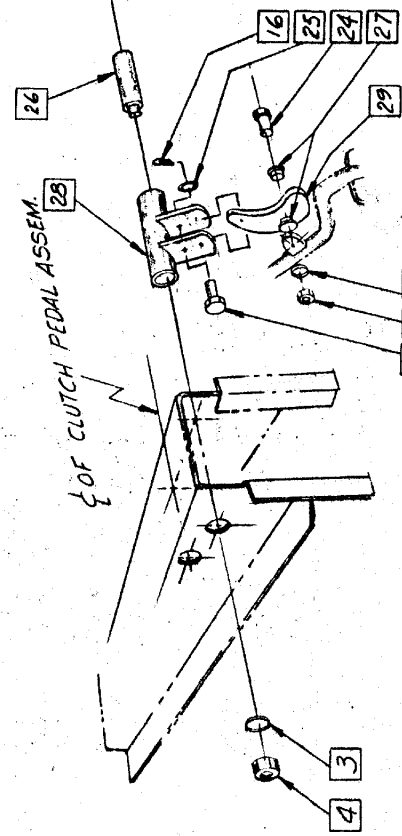
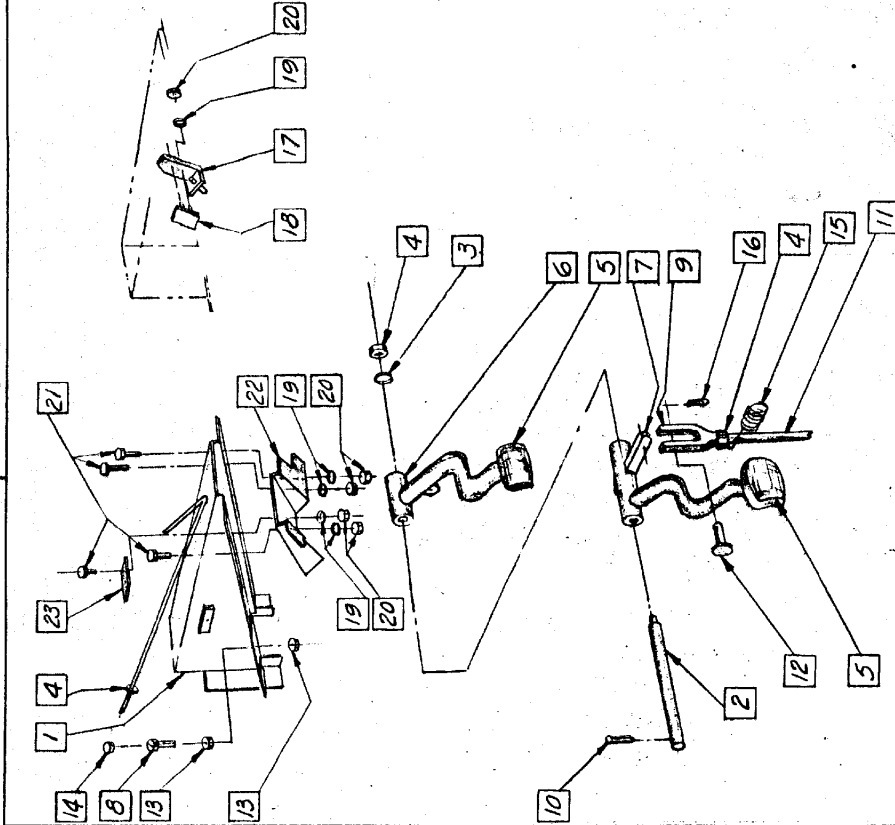

BASIC PEDAL SUPPORT ASSEMBLY

STD. (NON-POWER BRAKE)

POWER BRAKE

PER ENGR. MEMO #179

CHECKER MOTORS CORP. KALAMAZOO, MICH.

MODEL: A-12W648

DATE: 6/30/67

DWN. KING 6/30
CHK. GRO. 7/11/67

SHEET NO. 316 A

GRAPHIC ILLUSTRATION
PEDAL SUPPORT- STD TRANS. & POWER BRAKE APPVD.

USE BASIC PEDAL ASSEM. WITH THE FOLLOWING ALTERATIONS:
(BASIC PEDAL SUPPORT SHOWN ON G.I.316)

ELIMINATE

- 704126 ANCHOR, SPRING
- 701248 PEDAL ASSEM., CLUTCH
- 702089 SPRING

ADD

- 1-701591 - PEDAL ASSEM., CLUTCH
- 2-704125 - ANCHOR, CLUTCH PEDAL ADJ.
- 3-124824 - NUT, 5/16-18 HEX JAM (INCREASE USAGE TO 3)
- 4-70196 - BOLT, CLUTCH SPRING ADJUSTING
- 5-120376 - NUT, 5/16-18 HEX
- 6-70836 - HOOK, CLUTCH SPRING
- 7-70637 - SPRING, CLUTCH PEDAL
- 8-171104 - SCREW, 5/16-18 x 1/2 HEX. HD. TAPP.
- 9-703011 - SUPPORT ASSEM.

