

REVISED BY: [Signature] DATE: 12-13-64
 BY: [Signature] DATE: 6-10-65
 BY: [Signature] DATE: 11-14-66

CHECKER: MOTORS CORP., KALAMAZOO, MICH.

MODEL B-11 CHASSIS	DATE 2-26-64	SHEET No. 560
ALSO B-12 B-1E		
APPLIES TO		
701706 - AIR CLEANER (USE 701686 WITH A.I.R. JOBS)		
12617 - WING NUT		
702284 - GASKET		
702104 - CLAMP (2)		
702483 - HOSE		
124925 - NUT (2)		
702112 - GASKET		
FLUG - FURN WITH ENGINE		
2414204 - SCREW (2)		
701682 - AUTO CHOKE (W/A.I.R. & STD. TRANS.)		
701712 - AUTO CHOKE (ALL JOBS EXCEPT A.I.R. & STD. TRANS.)		
702267 - CLIP		
701392 - VALVE ASSEM. (USE 701871 WITH A.I.R. JOBS)		
702336 - GROMMET		
701330 - STUD ASSEM		
702339 - CONNECTOR		
702321 - HOSE		
702535 - GROMMET		
701539 - CARBURETOR (W/O A.I.R.)		
701804 - CARBURETOR (A.I.R. & STD. TRANS.)		
702478 - CONNECTOR		
120380 - L.W. (2)		
444028 - BUSHING		
702373 - CONNECTOR		
702971 - HOSE		
272846 - CLAMP		
701054 - ARRESTOR - FLAME		
701805 - CARBURETOR (A.I.R. & AUTO TRANS.)		

3-4 LBS. FT.
 17-23 LBS. FT.

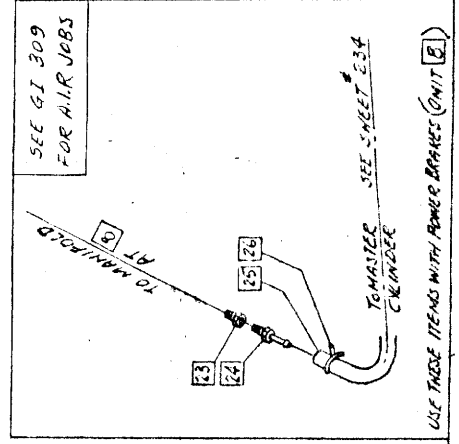
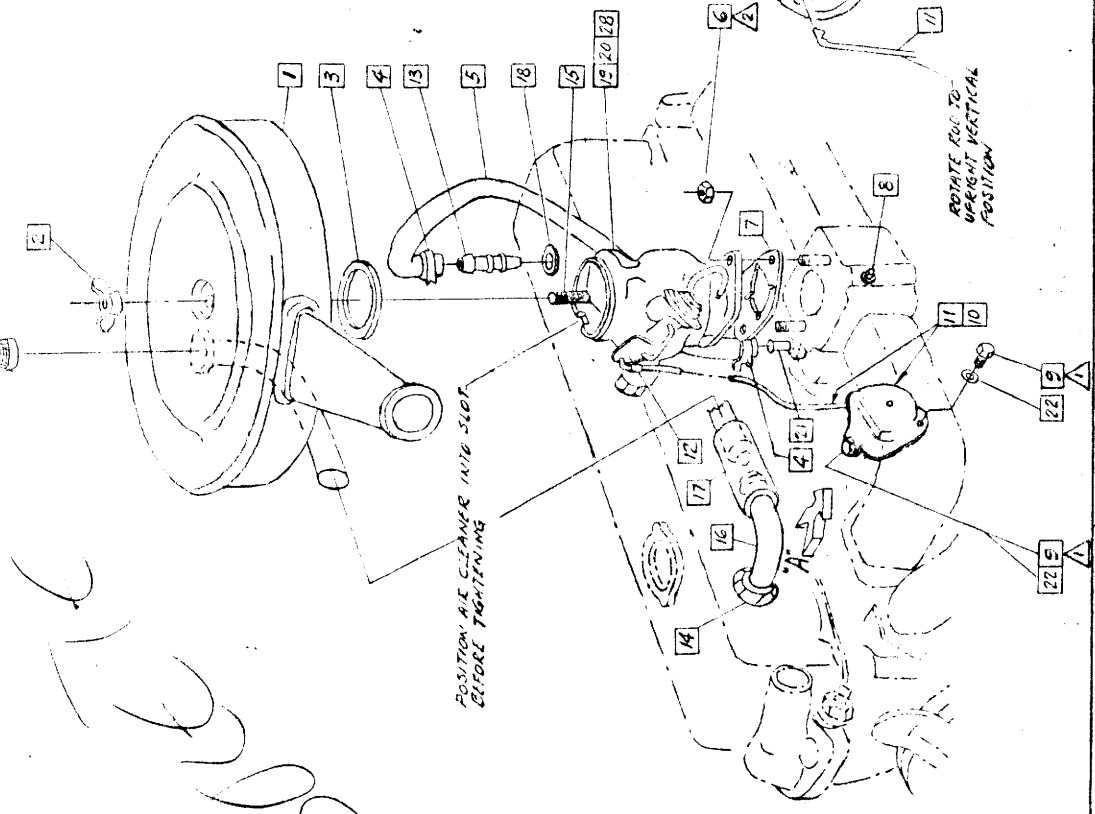

ADD'L. COPY - 8.50 THERLAND