

CHECKER MOTORS CORP., KALAMAZOO, MICH.

CHECKED BY GRO 5-15-64 SHEET NO. 257

GRAPHIC ILLUSTRATION

DATE 5-18-64

MODEL B-11 B-12M CHASSIS

APPROVED 5/15/64

REAR SUSPENSION (1964 F 65)

ALSO APPLIES TO B-12 B-12E

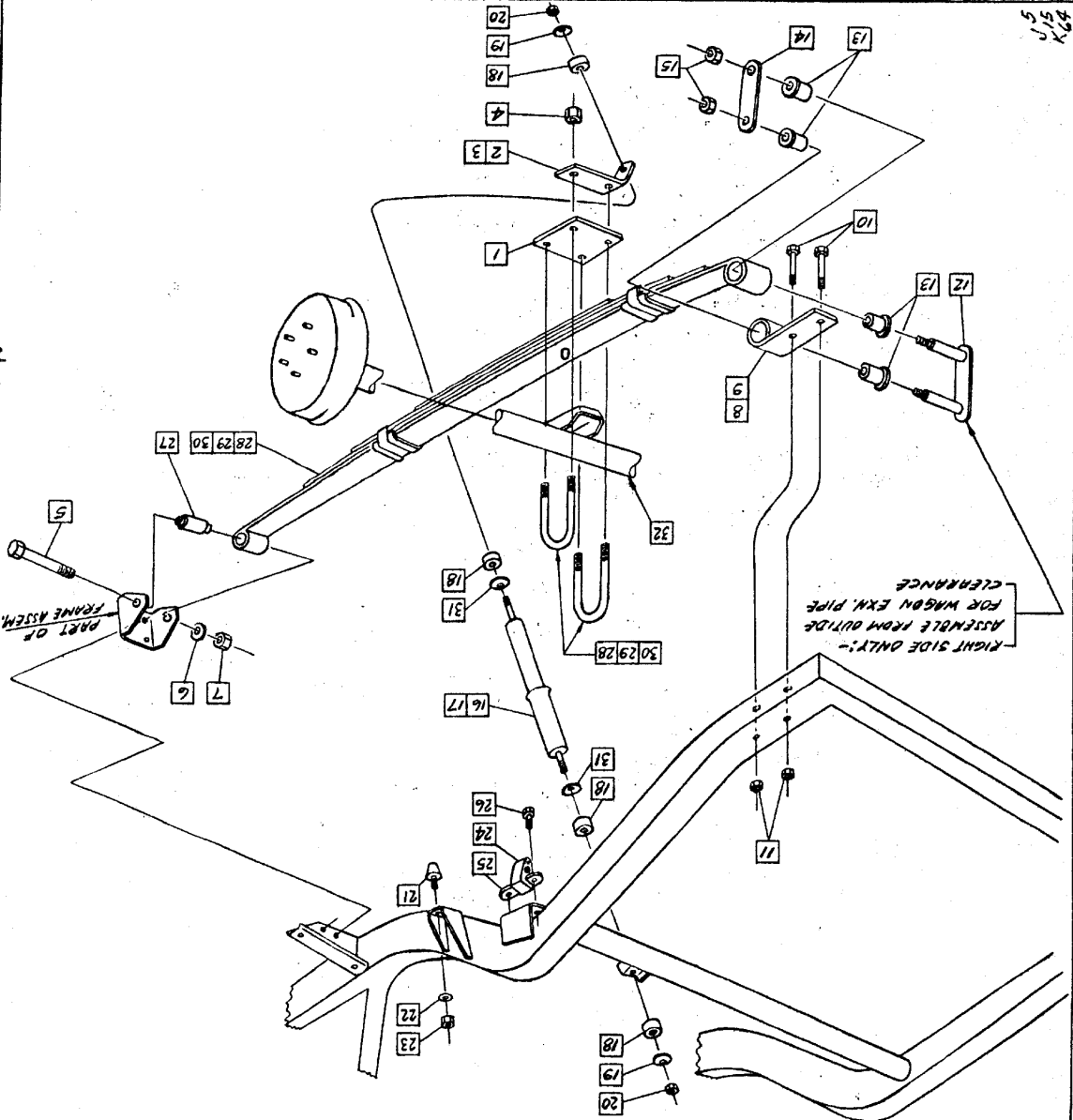

RIGHT SIDE ONLY:-  
ASSEMBLE FROM OUTSIDE  
FOR WAGON EXH. PIPE  
CLEARANCE

- 24 702356 BUMPER (2)
- 25 702354 CLIP (2)
- 26 17104 SCREW (4)
- 27 95644 BEARING (2) FURN. W/SPRING
- 28 97039 SPRING (2) (STD. B-11/B-12/B-12E)
- 28 98308 CLIP (4)
- 29 97339 SPRING (2) (H.D. B-11/B-12/B-12E/B-12E)
- 29 92278 CLIP (4)
- 30 97364 SPRING (2) (STD. B-12)
- 30 98308 CLIP (4)
- 31 94409 WASHER (4) FURN. W/SHOCK
- 32 97310-97317 REAR AXLE
- 7 98300 PLATE (2)
- 2 98301 BRKT.-L.H.
- 3 98302 BRKT.-R.H.
- 4 65198 NUT (8)
- 5 271758 BOLT (2)
- 6 121574 L.W. (2)
- 7 121358 NUT (2)
- 8 96135 BRKT.-L.H.
- 9 96136 BRKT.-R.H.
- 10 189330 BOLT - (4)
- 11 96101 NUT - (4)
- 12 95634 - PLATE & PIN (2)
- 13 96153 BUSHING (2)
- 14 80768 PLATE (2)
- 15 443340 NUT (4)
- 16 93880 SHOCK ABS.-REG. (2)
- 17 95091 SHOCK ABS.-H.D. (2)
- 18 94407 INSULATOR (3)
- 19 94408 WASHER (4)
- 20 442828 NUT (4)
- 21 701015 BUMPER (2)
- 22 120382 L.W. (2)
- 23 120369 NUT (2)

5  
J-15  
K-64

CHECKER MOTORS CORP., KALAMAZOO, MICH.

B11 B12 BIEN CHASSIS

DATE

7-9-64

GRAPHIC ILLUSTRATION

SHEET NO.

237-A

ALSO APPLIES TO

BY G-RO 7-9-64

HELPER SPRING

1 98326 - CLIP (A)

2 U" BOLT (A)

3 SPRING ASSEMBLY (2)

4 BUMPER (A)

5 PLATE (A)

6 LOCK NUT (12)

FURN. IN KIT # 97399

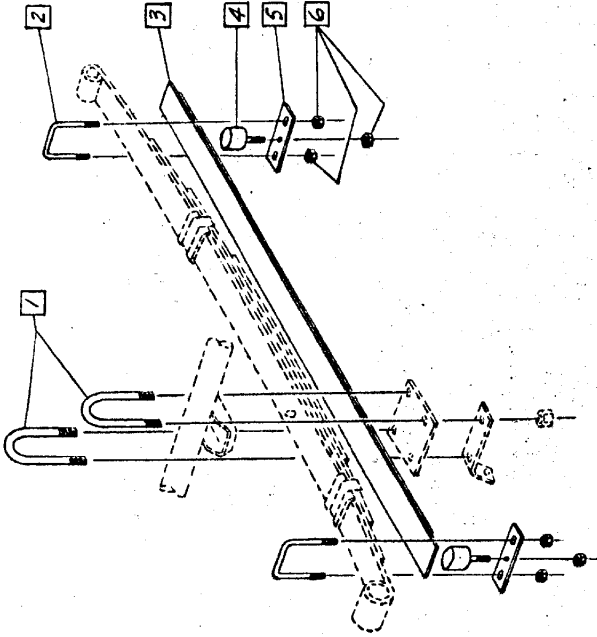

FOR ITEMS NOT IDENTIFIED - SEE SHEET 237 #