

SPRING

Removal

1. Raise and support vehicle so rear axle is suspended to permit raising and lowering.
2. Raise axle enough to relieve tension from shock absorbers.
3. Disconnect shock absorbers from lower mounting bracket.
4. Lower axle enough to relieve tension from springs.
5. Remove spring clip nuts, shock absorber bracket, clip plate and clips.

6. Disassemble shackle and suspend spring from front mounting bracket.

CAUTION

When shackle plate and pin are removed from the vehicle frame and spring, the spring will swing down unless supported or held.

7. Remove bolt from front mounting bracket and remove spring from vehicle.
8. Inspect all parts and replace if worn or damaged.

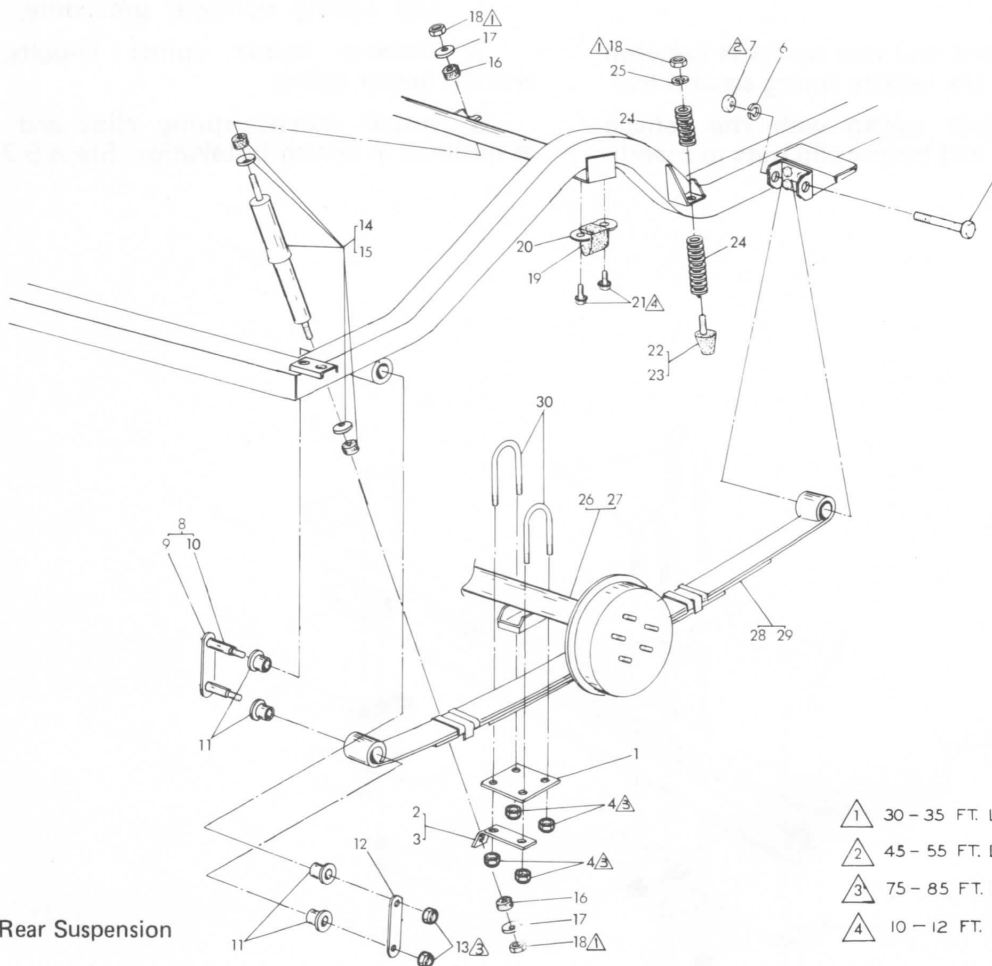

FIGURE 1—Rear Suspension

Installation

1. Replace spring bumper if worn or damaged.
2. Assemble spring on front mounting bracket.
3. Assemble shackle to vehicle frame and spring.
4. Torque shackle nuts and front mounting bracket bolt to specification. See Figure 1.
5. Install spring clips, clip plate, shock absorber bracket and clip nuts. Torque to specification.
6. Raise axle enough to reinstall shock absorbers to lower mounting bracket.

7. Lower vehicle and check for proper curb height.

NOTE

In some cases when rear springs are replaced on older vehicles, the curb height will be higher at the rear. If this is the case, the vehicle should be checked for proper front end alignment. See Group 2, Front Suspension for procedure and specifications.