

Cute Newt

Make this sweet woodland pendant from polymer and resin



TECHNIQUES WE WILL EXPLORE:

- sculpting with polymer
- accenting polymer with beads
- using UV resin
- using powders/glitters with polymer and with resin

Newts have a special place in my heart - as a kid I roamed my nearby woods and often spotted the cute wee things in the little mossy creeks. It was magical.

In this project I wanted to recreate the feeling of a cute little amphibian in a mossy water space.

For this project you will need:

(see Resources at the end for source info)

- . **polymer clay:** I recommend Premo™ clay in: Blue Glitter, Peacock, Ultramarine Blue, Twinkle Twinkle (or Black), Cad.Yellow and Red Glitter, or you can use similar colors in any brand of polymer clay that you prefer
- . **bezel:** I recommend my “Flow” Creative Form bezel
- . **tools:** needle tool, sculpting tools (I recommend the CF “Can’t Live Without It” tool), soft paintbrush, toothpick
- . **eyes:** I recommend two 3-4mm, round garnet beads (or other dark stone/glass)
- . **powders and glitters:** I recommend several from my CF SurfaceFX line: “Flash” (gold mica powder), “Kelp” (deep green micro-glitter) and “Tortuga” (minty-green mica powder). You can use anything similar.
- . **clear tape:** a small piece of wide, clear tape (like shipping tape)
- . **resin:** I recommend MagicGlos™ UV resin, or something similar
- . **UV resin lamp** (or substitute natural sunlight)
- . **disposable containers:** two small containers for mixing resin & powder/glitter, (like a condiment cup)
- . **glazed ceramic tile** (or glass one)
- . **oven, oven thermometer**

GOT BEZEL?

You'll need a bezel. I like using the "Flow" Creative Form because it has a nice woodland, watery feel to it. Any open bezel will work, preferably a round or oval shaped one.



CONDITION CLAY AND MIX COLORS

Newts come in lots of colors. This one is a blue-black. Gather your clays and blend them together.



Luckily blending the clays is the same process as conditioning so you can do both at once. Just roll, fold, twist and smush until the clays are blended and soft and flexible! If you have a pasta machine, use it!

MAKE THE BODY

We'll only need a small ball for the body, about the size of a grape.



Now shape the ball into a long teardrop shape.



To separate the head blob from the body blob, let's make a neck! Use a tool and roll back and forth over the clay to create an indentation.

Smooth the indentation with your fingers to make it more natural-looking.

The tail should be flattened. It's a newt thing. Use your fingers to flatten it and curve it too so it will tuck into the bezel better. See how it will fit in the bezel and adjust the curve accordingly.



MAKING THE LEGS

What are the limbs on a newt called? Paws? Legs? Fins? Whatever. Let's make them.

Roll out more of the blue-blend clay into a small ball and then roll that ball into a log to make the hand/leg. Use a tool to cut

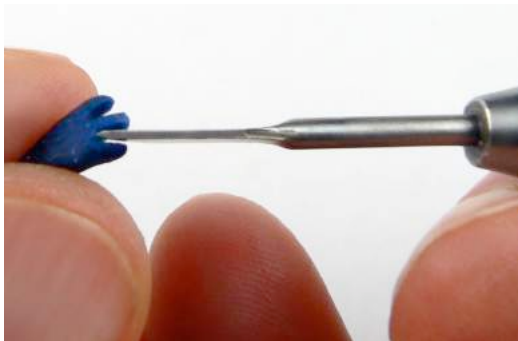

slices into the end to separate it into fingers or whatever. I sliced twice to create three fingers.

Cut off any excess clay length. Press the limb onto the body – one front and one back. Use a tool to blend the limb into the body.

Note: I decided to only do one set of limbs and make him curved into the edge of the bezel so that we wouldn't see (and I wouldn't need to make) the other set of limbs!





ADDING EYES

I like to use garnet beads for the eyes. Garnet beads have a nice glow to them, which looks really nice when you're making creatures.

Use a needle tool to make a hole for

the eye bead on each side of the head. Poke the needle in and roll it around a bit to widen the hole enough for the bead to press in.

Push the beads in so that the holes are hidden. Push so that they embed at least halfway into the clay.

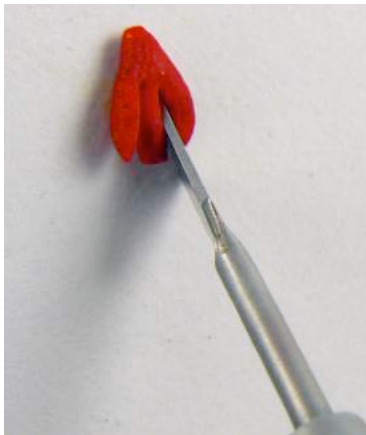

ADDING GILLS

Not all newts have those feathery gills visible on the sides of their head, but I like how they look, so this one will!

Roll out a tiny ball of red clay and shape it into a teardrop. Flatten it with

your fingers. Use a tool to cut slices in it as if you were making another set of fingers.

Make two of these.



Press one on your fingertip and then dip it into red glitter (cuz it's a sparkly newt for some reason!) Repeat with the other gill.

Press the gills onto the side of the head, behind the eyes and press to attach.





Isn't he cute so far!

(By the way, you can use a little bit of clear tape to pick off any wayward red glitter from the body of your newt!)

ADDING DOTS
Some newts have dots on their bodies. This one does! Just roll out teensy balls of yellow clay (or some other color if

you prefer) and press them onto the body, following the curve from gill to tail.



If you want, a swipe of golden mica powder over the dots and along the edge of the tail will add some highlights.

POSITION THE NEWT
Place the bezel onto a ceramic or glass tile. Now position the newt inside, curved into the side. Press him in place and try not to have a gap between the clay and

the metal. Gently push the newt down so the backside flattens slightly, on to the tile.

This will help later when we add the resin.

BAKING

Polymer must be baked before adding resin.

Preheat your oven to the temperature recommended by the brand of clay you are using. For Premo™ it's 275°F (130°C). Use an oven thermometer inside the oven to monitor temperature accuracy.

Bake on the tile (the bezel can go it too, of course) for the time recommended by the brand of clay you are using. For Premo™ it's about 45 – 60 minutes.



After baking, let it cool completely (remember the metal bezel stays hot longer than the clay).



PREPPING FOR RESIN

Ok, so now let's make the water! Position the bezel and newt onto a large, flat piece of tape (sticky side facing up).



Use your fingers to rub firmly on the back of the bezel and on the back of the newt to make sure there are no creases or bubbles for the resin to leak from.

This is why we used the tile – that smooth flat surface makes sure the piece stays flat, which is important now when we add the resin!

The glue on the tape acts as a resist for the resin, and we'll be able to peel the tape away once all the resin is cured.



ADDING THE RESIN

I'm using UV resin so that we can add layers quickly and easily.

First squeeze in enough resin to make a very thin coating all around the newt, touching the sides of the bezel all around.

Cure it in your UV light source (a special uv-curing lamp or natural sunlight) for about 10 minutes, or until the surface is hard, not gummy.

Add another very thin layer, again covering the entire piece from newt to bezel edges. Cure it.

ADDING MOSS

Powders and glitters mix perfectly with resin. I used several to create a mossy color, which we'll then add to the edges of our newt's little pond.

Use a small, disposable container and squeeze a little resin into it. Now add just a bit of green and gold mica powders and some green micro-glitter. Use a toothpick to mix them all together.



Spread some of this mossy mixture around the newt and around the edges of the bezel. You can extend it up into the creases of the bezel too.

Cure it.

The moss will look better and more mossy if there are variations in color. So get another little container, add a squirt of resin and then mix in just the green glitter.

Add some of that new color to spots of the mossy areas – not all over, just pops of color!

Cure this layer too, of course.





REMOVE THE TAPE AND FINISH THE RESIN

Once all the resin is cured so it's hard, carefully peel the tape off the back of the bezel.

If any sticky residue is left behind, use a fresh piece of tape to pick it off.

Sometimes the tape leaves ripples or wrinkles, so I always like to add one more layer over the surface of the backside. That also helps secure the resin to the bezel completely.



Cure this last resin layer.

And you're done!
Isn't he a cute newt?



RESOURCES

There's a kit for this project!

It contains all the embellishment supplies – resin, bezel, powders/glitters and garnet eyes (you're on your own for clay).

Or you can just get any of the supplies separately. Tools are also available.

Find them all in my online store at www.ChristiFriesen.com

