

Features

- Full port design for unrestricted flow
- Stainless hand lever with latch locking device
- Actuator ready ISO5211 direct mounting pad
- 316SS 3-piece investment cast body
- Swing-out center section
- RTFE (reinforced Teflon) ball seats
- Triple RTFE/Viton live loaded stem seals, adjustable
- Anti-static device
- Silicone free
- Valves tested per API598

Applications

Stainless steel ball valves with RTFE/Viton seals are typically used for on-off control of water, air, oil, vacuum and other media compatible with the materials of construction. Unique 3-piece investment cast bolted body design offers the advantage of a swing-out body for easy inline maintenance. Valves can be direct mounted to air or electric actuators using the standard ISO5211 mounting pad, eliminating the need for extra mounting brackets and couplings. Suitable for vacuum service up to 29inHg.

Pressure-Temperature Range

Pressure Rating*: 1000 PSI (69 Bar) CWP non-shock 1/4" to 2" sizes
800 PSI (55 Bar) CWP non-shock 2-1/2" and 3" sizes
Vacuum 29inHg, Saturated Steam 125 PSI

Temperature Rating: -4 to 356° F (-20 to 180°C)

*See P/T chart

Construction

Valve Body	316SS ASTM A351, CF8M
Ball	316SS CF8M
Stem	316SS
Ball Seats	RTFE (reinforced Teflon)
Stem Seals	RTFE, Viton
Anti-static Device	Ball to stem (1/4" - 3") + Stem to Body (1-1/2" - 3")
Hand Lever	304SS with vinyl cover
Belleville Washers/Adjust. Nut	304SS
Bolts, Washers and Nuts	304SS



Operation

Turning the hand lever one quarter-turn (90°) rotates the ball from closed to the open position. A latch locking device allows for pad locking the valve in either the open or closed position for safety lockout applications. The valve is actuator ready with standard ISO5211 mounting pad and square output shaft.

Description

Investment cast 3-piece full port stainless steel body/ball for unrestricted flow and minimum pressure loss. Adjustable live loaded stem seal packing helps compensate for wear, pressure or temperature fluctuations, extending the cycle life of the valve. Blow-out proof stem. Valve body held together with bolts for easy maintenance.

Options

- Air Actuators
- Electric Actuators

Specifications (English units)

Stock Number	Pipe Size (NPT)	Orifice Diameter (inch)	Cv	Pressure* (PSI)	Torque (inch lbs)	ISO5211 Mount	Weight (lbs)
551502A	1/4	0.45	8	1000	45	F03/F05	1.3
551503A	3/8	0.49	10	1000	45	F03/F05	1.3
551504A	1/2	0.59	15	1000	45	F03/F05	1.3
551506A	3/4	0.79	35	1000	75	F03/F05	1.6
551508A	1	1.00	60	1000	126	F03/F05	2.3
551510A	1-1/4	1.25	90	1000	145	F03/F05	3.5
551512A	1-1/2	1.50	125	1000	220	F05/F07	5.5
551516A	2	2.00	240	1000	304	F05/F07	7.6
551520A	2-1/2	2.56	320	800	432	F07/F10	14
551524A	3	3.15	580	800	826	F07/F10	25

Cv = The GPM of water at 60° F that will pass through the valve with 1 PSI pressure drop

* Pressure @ 0-100° F (reduced pressure at higher temperatures—see P/T chart)

• Torque at 0 PSI and 75°F

Specifications (Metric units)

Stock Number	Pipe Size (NPT)	Orifice Diameter (mm)	Kv	Pressure* (Bar)	Torque (Nm)	ISO5211 Mount	Weight (Kg)
551502A	1/4	11.5	7	69	5	F03/F05	0.59
551503A	3/8	12.5	8.6	69	5	F03/F05	0.59
551504A	1/2	15	13	69	5	F03/F05	0.59
551506A	3/4	20	30	69	7	F03/F05	0.71
551508A	1	25	52	69	14.2	F03/F05	1.03
551510A	1-1/4	32	77	69	16.4	F03/F05	1.56
551512A	1-1/2	38	107	69	24.9	F05/F07	2.50
551516A	2	50	206	69	34.4	F05/F07	3.44
551520A	2-1/2	65	275	55	49	F07/F10	6.40
551524A	3	80	499	55	93.4	F07/F10	11.20

* Pressure range @ -18 to 38° C (reduced pressure for higher temperatures—see P/T chart)

Pressure/Temp. Chart - 1000 PSI (69 Bar)

P/T Chart (PSI/°F)								
PSI	1000	1000	1000	950	875	750	375	100
°F	0	50	100	150	200	250	300	330
P/T Chart (BAR/°C)								
Bar	69	69	69	65.5	60	52	26	7
°C	-18	10	38	66	93	121	149	166

Pressure/Temp. Chart - 800 PSI (55 Bar)

P/T Chart (PSI/°F)								
PSI	800	800	800	725	675	650	450	100
°F	0	50	100	150	200	250	300	330
VP/T Chart (BAR/°C)								
Bar	55	55	55	50	47	52	31	7
°C	-18	10	38	66	93	121	149	166

Dimensions: (inches)

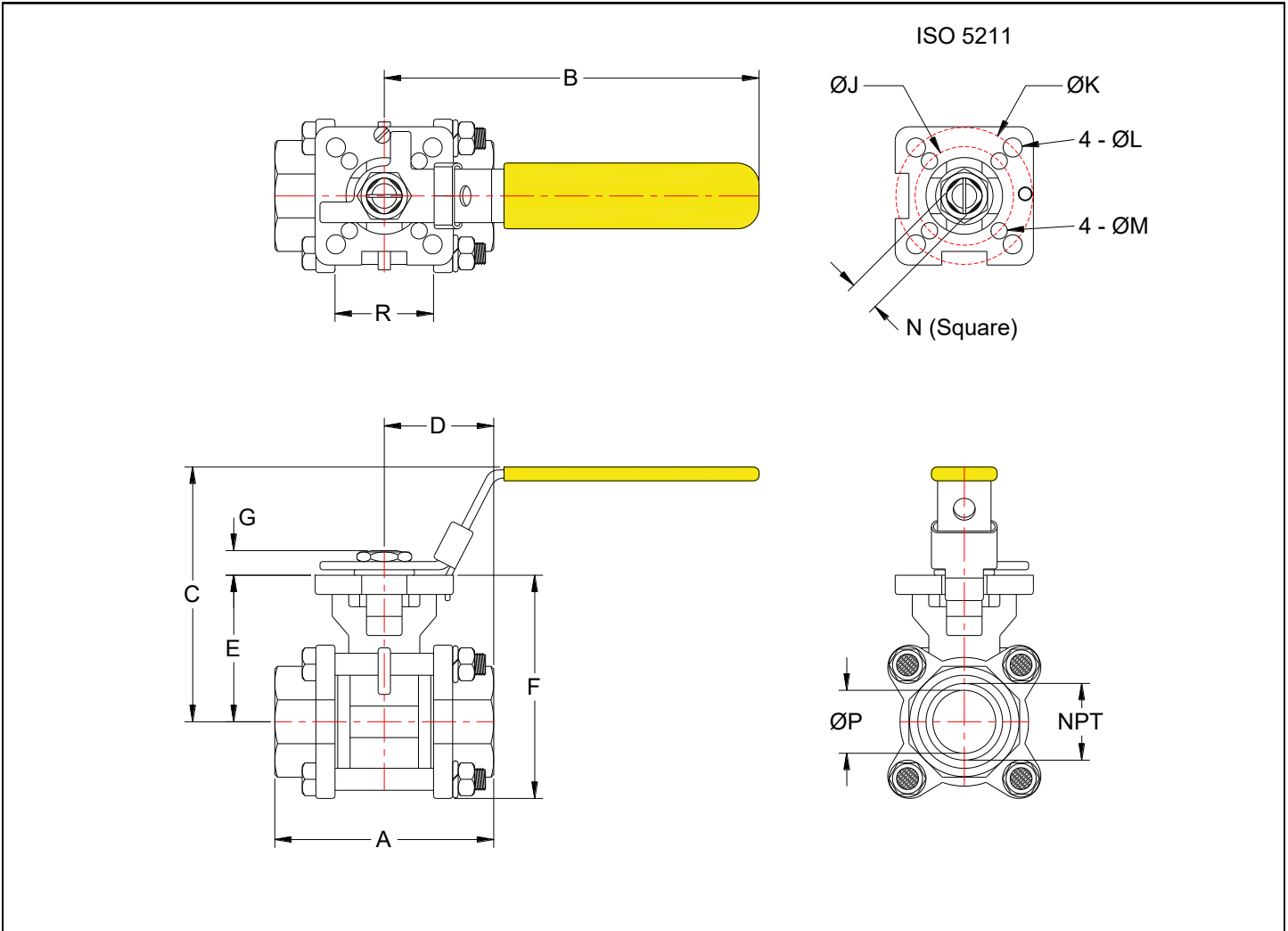

Pipe NPT	A	B	C	D	E	F	G	J	K	L	M	N	P	R	ISO	Weight (lbs)
1/4	2.50	4.41	2.87	1.25	1.46	2.36	0.33	1.42	1.97	0.28	0.24	0.35	0.45	0.89	F03/F05	1.40
3/8	2.50	4.41	2.87	1.25	1.46	2.36	0.33	1.42	1.97	0.28	0.24	0.35	0.49	0.89	F03/F05	1.35
1/2	2.50	4.41	2.87	1.25	1.46	2.36	0.33	1.42	1.97	0.28	0.24	0.35	0.59	0.89	F03/F05	1.30
3/4	2.85	4.41	3.18	1.43	1.77	2.74	0.33	1.42	1.97	0.28	0.24	0.35	0.79	1.08	F03/F05	1.65
1	3.19	5.35	3.56	1.59	2.11	3.20	0.45	1.42	1.97	0.28	0.24	0.35	0.98	1.34	F03/F05	2.30
1-1/4	3.72	7.28	3.89	1.86	2.32	3.64	0.45	1.42	1.97	0.28	0.24	0.35	1.26	1.67	F03/F05	3.55
1-1/2	4.25	7.79	4.54	2.13	2.94	4.45	0.55	1.97	2.76	0.35	0.28	0.55	1.50	2.05	F05/F07	5.50
2	4.78	7.79	4.88	2.39	3.29	5.08	0.54	1.97	2.76	0.35	0.28	0.55	1.97	2.50	F05/F07	8.00
2-1/2	6.20	10.51	6.10	3.10	4.28	6.46	0.71	2.76	4.02	0.43	0.35	0.67	2.56	3.37	F07/F10	17.60
3	7.48	10.51	6.69	3.74	4.66	7.20	0.71	2.76	4.02	0.43	0.35	0.67	3.15	4.02	F07/F10	24.65

Dimensions: (mm)

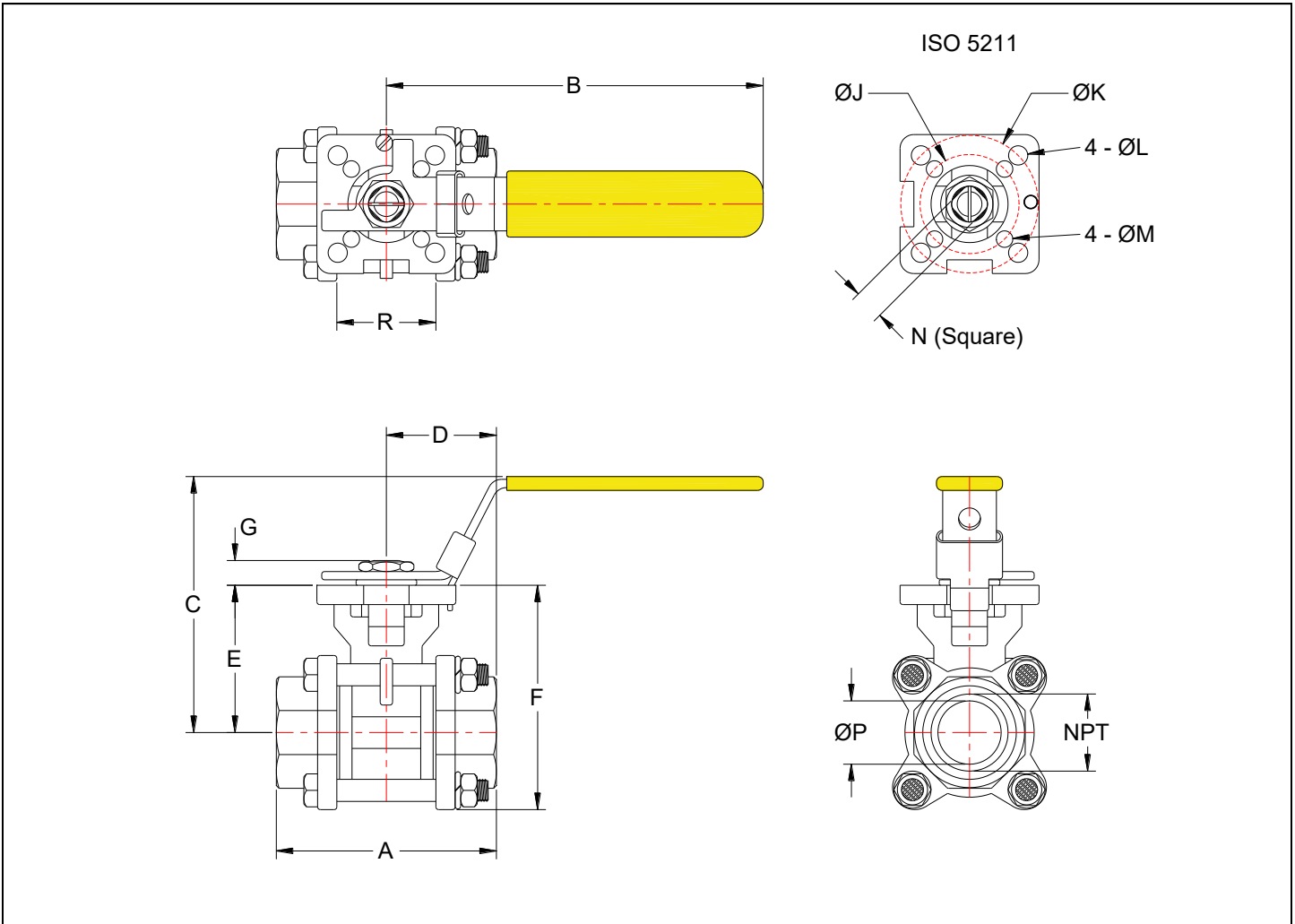

Pipe NPT	A	B	C	D	E	F	G	J	K	L	M	N	P	R	ISO	Weight (kg)
1/4	63.5	112	73	31.8	37	60	8.5	36	50	7	6	9	11.5	22.5	F03/F05	0.64
3/8	63.5	112	73	31.8	37	60	8.5	36	50	7	6	9	12.5	22.5	F03/F05	0.62
1/2	63.5	112	73	31.8	37	60	8.5	36	50	7	6	9	15	22.5	F03/F05	0.60
3/4	72.5	112	80.8	36.3	45	69.6	8.5	36	50	7	6	9	20	27.5	F03/F05	0.76
1	81	136	90.5	40.5	53.5	81.3	11.4	36	50	7	6	9	25	34	F03/F05	1.04
1-1/4	94.5	185	98.7	47.3	59	92.4	11.4	36	50	7	6	9	32	42.5	F03/F05	1.62
1-1/2	108	198	115	54	74.8	113	14.0	50	70	9	7	14	38	52	F05/F07	2.50
2	122	198	124	60.8	83.5	129	13.7	50	70	9	7	14	50	63.5	F05/F07	3.64
2-1/2	158	267	155	78.8	109	164	18.0	70	102	11	9	17	65	85.5	F07/F10	8.00
3	190	267	170	95.0	118	183	18.0	70	102	11	9	17	80	102	F07/F10	11.18