

## SKIN

R&D POLIFORM (2016)

**Poliform**



### DESCRIPTION

Skin, design R&D Poliform, is a wardrobe characterized by the peculiar door working. The versatility of the Senzafine system allows it to be placed in every room, offering the greatest space in any situation.

## SKIN

R&D POLIFORM (2016)

**Poliform**



### TECHNICAL DESCRIPTION

#### TYOLOGY

doors Senzafine collection

#### OPENING

leaf door and sliding door

#### Door finishing

panel of wooden particles mat lacquered colours

#### Profile finishing

painted aluminium/mat lacquered

# SKIN

R&D POLIFORM (2016)

# Poliform

## DIMENSIONS

wardrobes

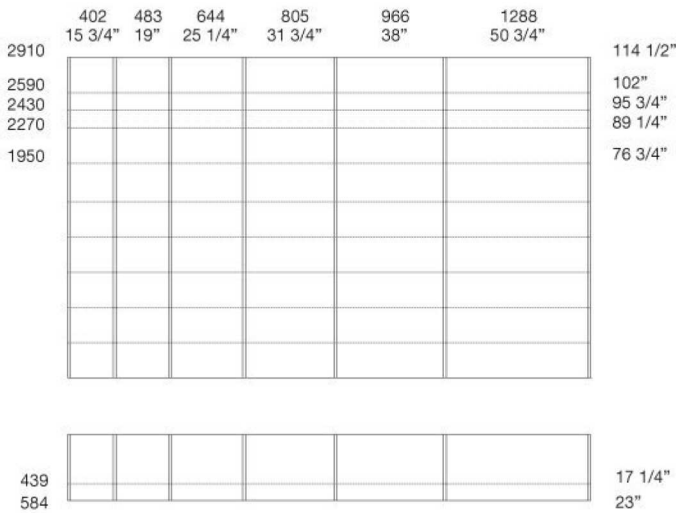

Size calculation with side thickness 25 - 1"

To obtain the total width, add to the sum of the columns mm 25 - 1" for the lateral side.

## SKIN design CR&S Poliform senzafine doors collection

### unit widths

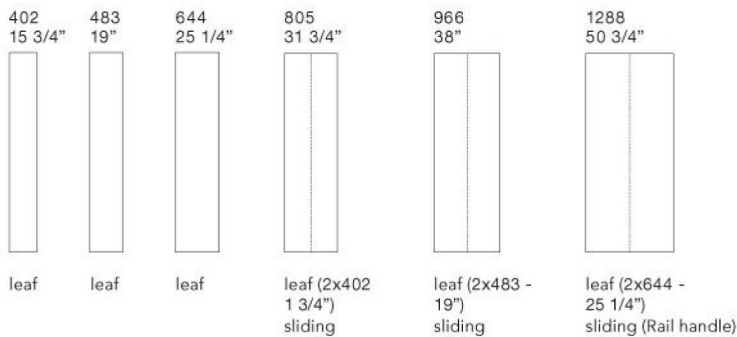

### unit heights

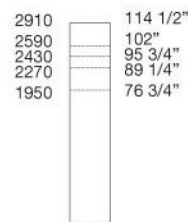

### Door section

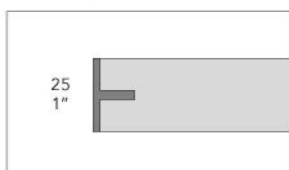

### Note

Lateral sides: not available in melamine Skin mat lacquered colours finishings.  
Sliding door width mm 1288 - 50 3/4" is available only with Rail handle up to h 2590 - 102".