



Flea Secure™ Light Trap

FLEA SECURE™ LIGHT TRAP FACTS

The flea trap attracts and captures adult fleas. Use it as a part of your complete flea control program from your home and pets. Catching one female flea may prevent 200 or more eggs from being laid. Trapping one female now is like catching 200 fleas later. The flea trap will reduce the number of fleas where ever it is used. Under certain conditions, it will also eliminate fleas. Fleas on your pet are unlikely to leave and go to the trap. Remove fleas from your pet with a flea comb or flea soap. Make sure the flea trap is maintained for bet results. Fleas and dust will reduce the stickiness of the pad. Replace the sticky pad every 3 months or sooner, if needed. Replace the light bulb with a 5 watt or smaller nightlight bulb as needed.

SAFETY FACTORS

1. CAUTION - This product is intended for use indoors only in households. To avoid risk of fire or electrical shock, do not use where it may be exposed to water, including roofed, but open porches.
2. Don't abuse cord - never carry product by cord or yank it to disconnect from receptacle. Keep cord from heat, oil, and sharp edges.
3. Disconnect the product from the power supply when not in use, before servicing, when changing bulbs, cleaning and the like.
4. Do not insert foreign objects into this product. Use extension cords if needed marked SPT-2 18 gauge type or equivalent.
5. Use only extension cords which have plugs and receptacles which accept the product's plug. Replace or repair damaged cords. Devices are available for retaining an extension cord connection to the power-supply cord.

HOW THE FLEA SECURE™ LIGHT TRAP WORKS

The Flea Secure Light Trap works by catching adult fleas that are looking for a pet to infest. The light, heat and infra-red rays from the light bulb are strong attractants for fleas. The fleas jump on the sticky pad. Each flea caught may prevent 200 more fleas from infesting your home. Use more Traps for severe infestations or fastest relief. Catches 4 times more fleas than other older-style traps

READY TO USE - NO ASSEMBLY REQUIRED

RECOMMENDED LOCATIONS FOR FLEA SECURE LIGHT TRAP

1. Place the flea trap at or near places where fleas are present, such as where your pet sleeps, rests, eats and walks.
2. Position your trap so that fleas can see it. Fleas only go to the trap when they can see the light. Locations under furniture are very effective, but skirting around the furniture reduces results.
3. Use several traps for best coverage and superior results. Leave the traps on ALL the time for best effects. The trap is a permanent system which will remove fleas for many years when properly maintained.

INSTRUCTIONS FOR USE

1. Activate the Flea Secure Sticky Pad by pulling the release paper from its front.
2. Remove the protective screen from the trap and place the sticky pad in the base, **Sticky Side Up!**
3. Replace the protective screen over the sticky pad.
4. Place your flea trap at a "Recommended Location" and plug it into a regular electrical outlet.

In case of contact, the sticky glue can be removed from hands with vegetable oil.



Number of Traps to Use

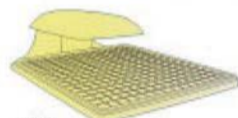

Number of Pets

1	1	2	3
2	3	4	

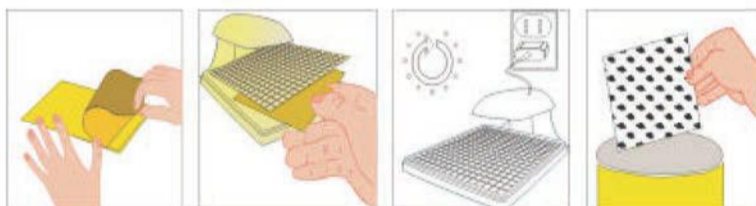
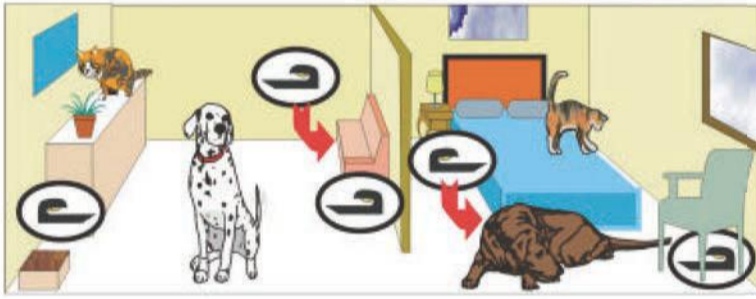

EPA Est. No. 66433-WA-1
U.S. Pat. No. 5,353,542
U.S. Pat. D 349,745
CAN R.D. ENT. 1993

CSA Listed - meets or exceeds UL

CONTENTS: 1 Flea Secure™ Light Trap, 1 Flea Secure™ Sticky Pad (Pad lasts 3-6 months or 10,000 fleas)

Flea Secure™ Light Trap Sku# 3257

Manufactured For:
Gardens Alive!® Inc.
5100 Schenley Place
Lawrenceburg, IN 47025
513-354-1483
www.GardensAlive.com



Flea Secure™ Sticky Pads Effective - Safe - Easy to Use

Directions:

1. When replacing the Flea Secure™ Sticky Pads in your Gardens Alive! Flea Secure™ Light Trap, unplug the trap and remove the protective screen from the trap.
2. Discard the used Flea Secure Sticky Pads.
3. Peel off the protective sheet from the sticky pad and place it in the trap sticky side up and replace the protective screen.
4. Plug in the trap.

Note: In case of contact with skin, the sticky glue can be removed with vegetable oil.

Placement of your Flea Secure™ Light Trap

Place your Gardens Alive! Flea Secure Light Trap near areas where fleas are present such as where pets sleep, rest, or eat. The Flea Trap must be placed where the pet spends most of their time. Using more than one Flea Secure Light Trap will give better coverage and best results. The Flea Trap should remain on at all times for best results. For indoor use only. Replace the Flea Secure Sticky Pads every 3 months or sooner if needed.

EPA Est. No. 66433-WA-01

Flea Secure™ Sticky Pads
2 Capture Pads
Sku #3258

Manufactured For:
Gardens Alive!® Inc.
5100 Schenley Place
Lawrenceburg, IN 47025
www.GardensAlive.com



Flea Secure™ Sticky Pads Effective - Safe - Easy to Use

Directions:

1. When replacing the Flea Secure™ Sticky Pads in your Gardens Alive! Flea Secure™ Light Trap, unplug the trap and remove the protective screen from the trap.
2. Discard the used Flea Secure Sticky Pads.
3. Peel off the protective sheet from the sticky pad and place it in the trap sticky side up and replace the protective screen.
4. Plug in the trap.

Note: In case of contact with skin, the sticky glue can be removed with vegetable oil.

Placement of your Flea Secure™ Light Trap

Place your Gardens Alive! Flea Secure Light Trap near areas where fleas are present such as where pets sleep, rest, or eat. The Flea Trap must be placed where the pet spends most of their time. Using more than one Flea Secure Light Trap will give better coverage and best results. The Flea Trap should remain on at all times for best results. For indoor use only. Replace the Flea Secure Sticky Pads every 3 months or sooner if needed.

EPA Est. No. 66433-WA-01

Flea Secure™ Sticky Pads
2 Capture Pads
Sku #3258

Manufactured For:
Gardens Alive!® Inc.
5100 Schenley Place
Lawrenceburg, IN 47025
www.GardensAlive.com