

## Adjusting the Stop Position – CrockMaster 680

**WARNING:** Any maintenance work undertaken on a James Heal instrument must be done so by a trained and competent person. Where electrical work is detailed, this should only be completed by a qualified engineer. James Heal is not responsible for damage or injury arising from work carried out by any person not qualified to do so. If in doubt, please contact James Heal or your local James Heal Agent.

Inside the Crockmaster there is a drive pulley.  
On this pulley there is a screw which is used as a flag to operate the proximity switch.  
The Crock master will stop just after the screw has passed the switch.

To change the stop position you need to change the position of this flag screw relative to the crocking arm.

1. Disconnect the electrical supply to the Crockmaster.
2. Remove the 3 screws [ A ] on the left side of the top cover.

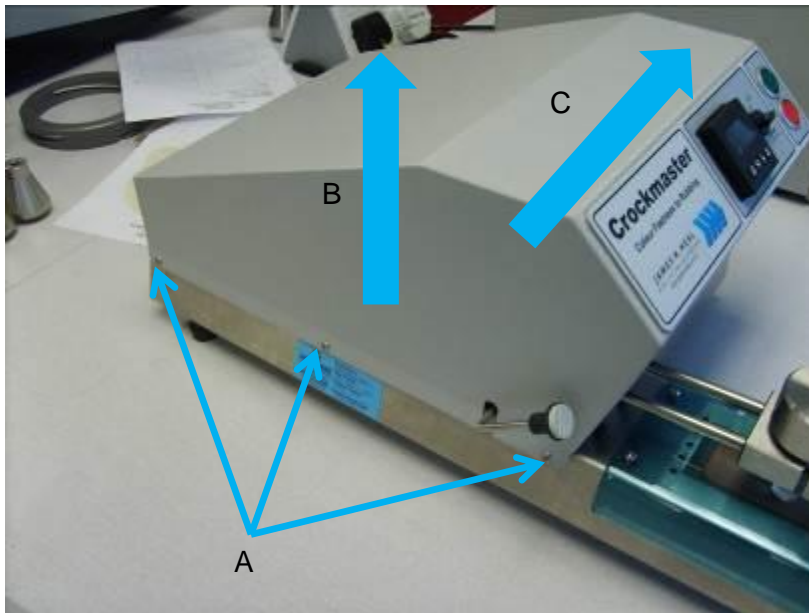

3. Lift the left side of the cover up approximately 3cm [ B ] then slide the cover to the right [ C ] and rest it next to the Crockmaster.
4. Very carefully re-connect the power to the unit and run it until it stops.  
At this point turn the power back off.

5. Slacken the grub screws on the pulley.  
Remove the proximity switch screw, do not change the position of the lock nut if possible.  
Completely remove 1 on the grub screws and then tighten it into the 3<sup>rd</sup> hole to free the pulley on the shaft.

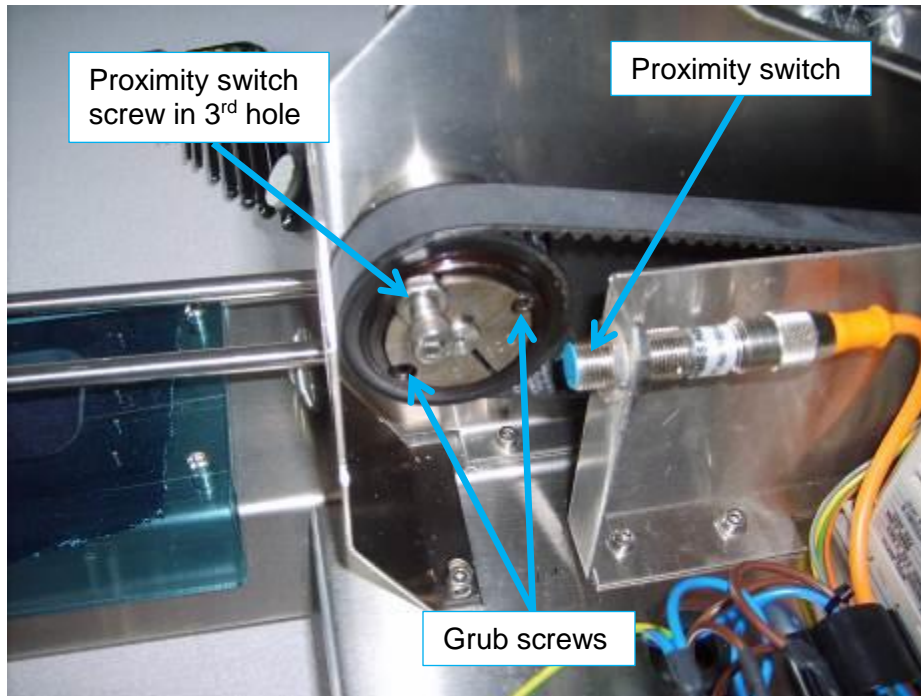

6. Hold the pulley in its stop position and manually move the crocking arm to its stop position.
7. Put the grub screws back into their original holes and tighten them.

Put the proximity flag screw back into its hole and tighten it making sure it is far enough out to operate the proximity switch, at this point tighten its lock nut.