

SYSTEM CONNECTIONS

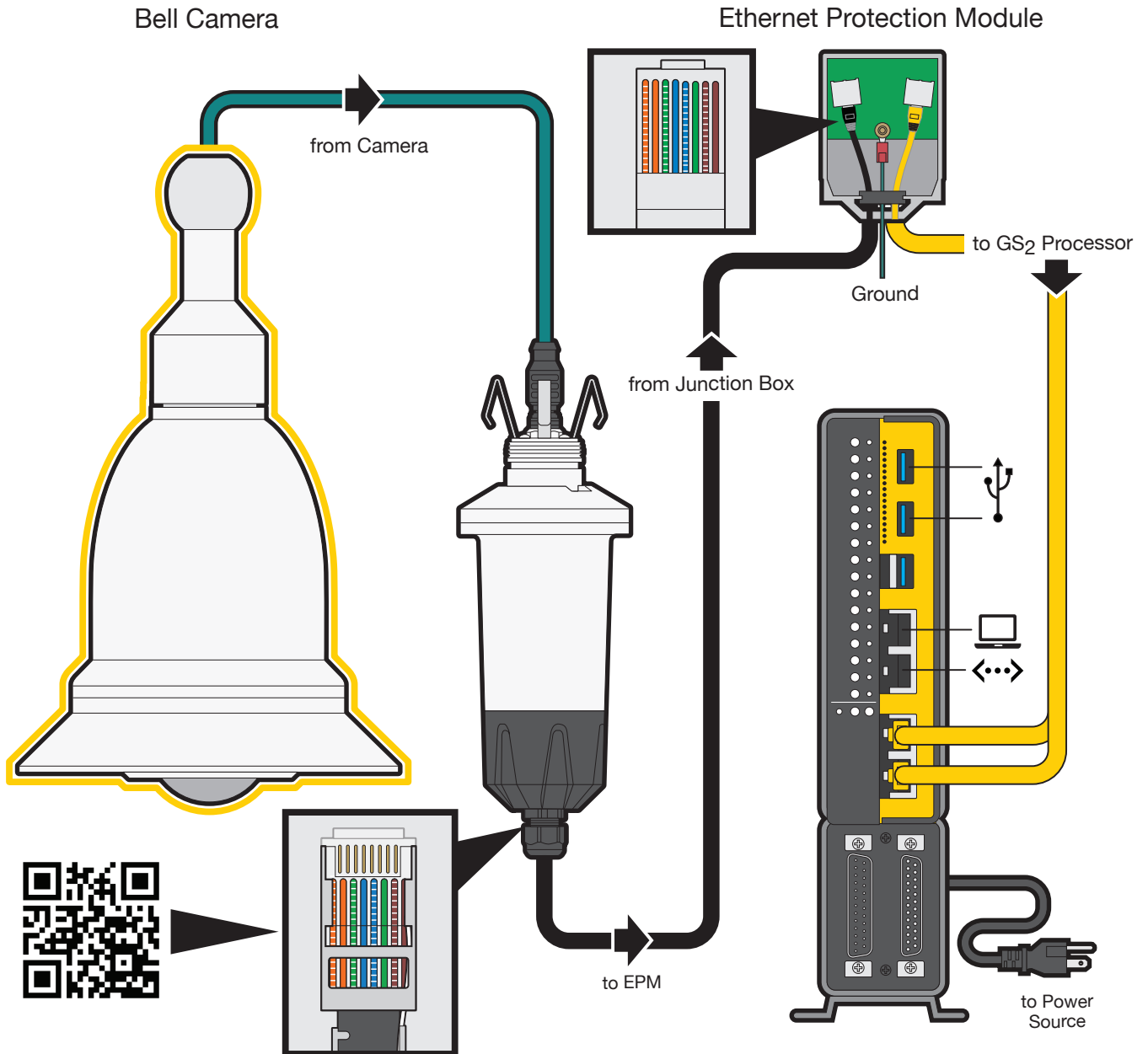

Pro Tips (Before Beginning Installation):

- Test Bell Camera (while still in foam packaging).
- Make sure unit is grounded correctly.
- Make sure Bell Camera is level and in front of stop bar.
- Check TS1 Wiring Harness Insert – TS1 connection.
- Check “Tool List” in installation guide.

SYSTEM OVERVIEW

