

sinopé

TH1123ZB TH1124ZB

Installation Guide

Smart Thermostat for
Electric Heating

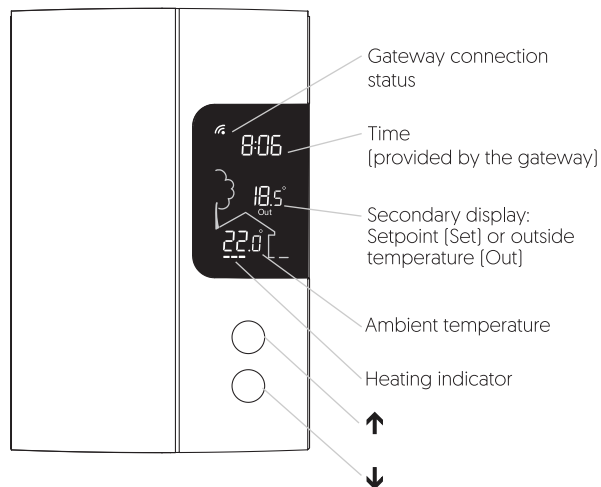

Warnings

The installation of this thermostat should be made by a certified electrician and must be installed in conformity with the national and local Electrical Codes.

Make sure that the breakers for your heating system are off at the main electrical panel.

The thermostat must be installed in series with your heating device. Connecting the thermostat directly to the line voltage source will damage the unit.

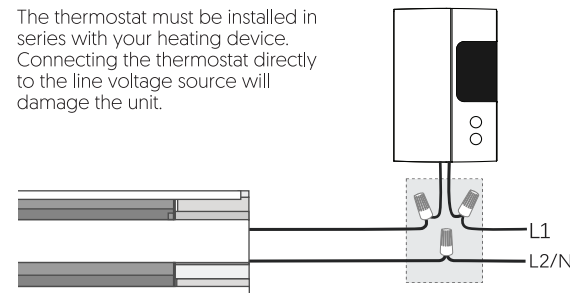

Note: The wires of this thermostat are non-polarized.

zigbee 3.0

INSTALL YOUR THERMOSTAT

- 1** Remove your old thermostat. It should be connected on 2 wires. If you have more than 2 wires, refer to our Website [FAQ].

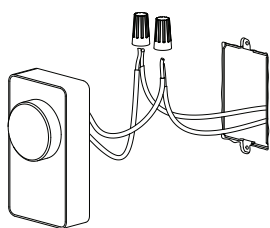

- 2** Unlock and lift the thermostat cover.

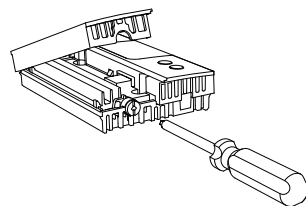

- 3** Use the provided connectors to connect the two wires of the thermostat to the wires previously connected to your old thermostat.

Use the two screws to secure the thermostat to the electrical box.

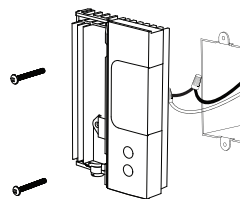

- 4** Replace the cover and lock.

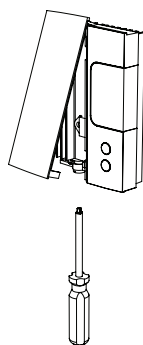

- 5** Power up the thermostat.



Make sure to firmly tighten the wire connectors for a secure connection. A loose connection can be a fire hazard. Special CO/ALR solderless connectors must be used when connecting with aluminum conductors.

TECHNICAL SPECIFICATIONS

Operating voltage: 120 / 208 / 240 Vac, 60 Hz

• **TH1123ZB Thermostat**

Maximum load:
12.5 A / 3000 W @ 240 Vac
Resistive load only.

Minimum load:
1.25 A / 300 W @ 240 Vac

• **TH1124ZB Thermostat**

Maximum load:
16.7 A / 4000 W @ 240 Vac
Resistive load only.

Minimum load:
1.25 A / 300 W @ 240 Vac

Setpoint range: 5 °C to 30 °C [41 °F to 86 °F]

Display range: 0 °C to 50 °C [32 °F to 99 °F]

Resolution: ± 0.5 °C [± 1 °F]

Storage: -20 °C to 50 °C [-4 °F to 122 °F]

Operation: 0 °C to 50 °C [32 °F to 122 °F]

Zigbee 3.0 profile

Frequency: 2.4 GHz

Transmission power: +20 dBm

Receiver sensitivity: -108 dBm

Compatible with an electric heating system such as:

- Baseboard heater (short cycle)
- Convector (short cycle)
- Fan-forced convector (long cycle)

ADD YOUR THERMOSTAT TO THE GT130 GATEWAY AND NEVIWEB

- 1 If you do not have an account yet, download the Neviweb app for iOS or Android to open an account and add your device.



- 2 Tap the then select "Add Device"

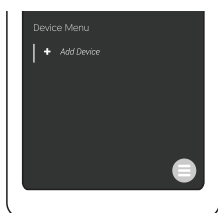

- 3 Follow the steps of the Installation Wizard

CONNECT YOUR THERMOSTAT TO A COMPATIBLE ZIGBEE SYSTEM

- 1 Initiate the connectivity session of your compatible Zigbee hub by referring to the device's user guide.



- 3 Connect all your devices the same way, by going to the next closest device.

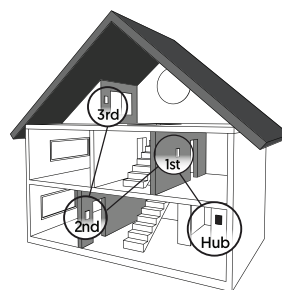

- 2 Connect your thermostat to the network by pressing simultaneously on the and buttons.

On the thermostat display:
Flashes: Connecting
Remains lit: Connected

If the connectivity fails, the symbol will disappear from the display. Refer to our Website to troubleshoot the unit.

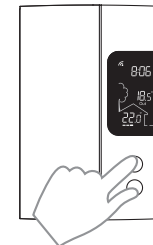

- 4 When all the thermostats are connected, close the connectivity session of your compatible Zigbee hub.



DISCONNECT YOUR THERMOSTAT FROM THE GT130 GATEWAY OR A COMPATIBLE ZIGBEE SYSTEM

To disconnect your thermostat from the GT130 gateway or a compatible Zigbee hub, press the and buttons simultaneously for 10 seconds. The symbol will disappear from the display.

Cycle Length

To change the cycle length according to your heating system, you must:

Get the setpoint to its minimum and hold the button for 3 seconds to access the menu.

Press the button to change the setting.

Press and hold the button for 3 seconds to exit the menu and return to normal display.

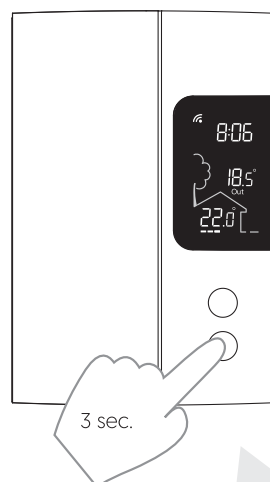

Transmitter Module IC: 22394-ZBM1501 / FCC ID:2AK2T-ZBM1501

This device complies with Industry Canada license exempt RSS standard(s). Operation is subject to the following two conditions:
 (1) this device does not cause interference, and (2) this device must accept any interference, including interference that may cause undesired operation of the device.

This equipment has been tested and found to comply with the limits for a Class B digital device, pursuant to part 15 of the FCC Rules. These limits are designed to provide reasonable protection against harmful interference in a residential installation. This equipment generates, uses and can radiate radio frequency energy, and if not installed and used in accordance with the instructions, may cause harmful interference to radio communications. However, there is no guarantee that interference will not occur in a particular installation. If this equipment does cause harmful interference to radio or television reception, which can be determined by turning the equipment OFF and ON, the user is encouraged to try to correct the interference by one or more of the following measures:

- Reorient or relocate the receiving antenna.
- Increase the separation between the equipment and receiver.
- Connect the equipment into an outlet on a circuit different from that to which the receiver is connected.
- Consult the dealer or an experienced radio/TV technician for help.

3-year limited warranty

SINOPÉ TECHNOLOGIES INC. warrants the components of their products against defects in material and workmanship for a 3 year period from the date of purchase, under normal use and service, when proof of purchase of such is provided to the manufacturer. This warranty does not cover any transportation costs that may be incurred by the consumer. Nor does it cover a product that has been improperly installed, misused or accidentally damaged. The obligation of Sinopé Technologies Inc., under the terms of this warranty, will be to supply a new unit and this releases the manufacturer from paying the installation costs or other secondary charges linked to replacing the unit or the components.

Parameter	Display
Cycle SHT [short cycle for electric baseboard] FAN [long cycle for fan forced heater]	

sinopé

For more information, visit our Website:

www.sinopetech.com

