

Wireless Setup

Enabling Wireless LAN (Infrastructure)

- Wireless (Infrastructure) and Wireless (AP Mode) cannot be enabled at the same time.
- A router (access point) is necessary to set up a wireless connection.
- Do not place any electric products that emit weak radio waves (such as microwaves or digital cordless telephones) close to the printer.
- The communication speed of the wireless LAN connection may be slower than that of a wired LAN or USB connection depending on the environment.
- This printer can use a wired LAN and wireless LAN simultaneously. If the wired LAN and wireless LAN are connected to the same subnet, communications may become unstable.

Confirm the SSID and Encryption key, and write them down on the blank space as shown below.

SSID: _____

Encryption key: _____

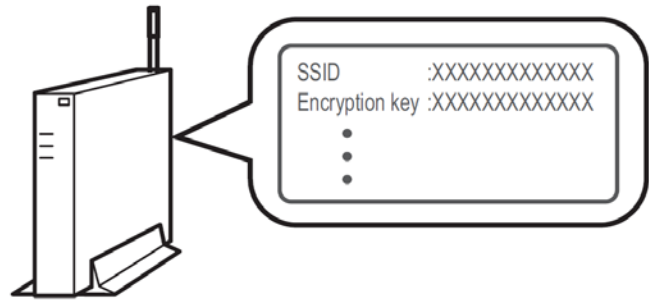

Connecting with WPS

- If the wireless LAN access point supports WPS, you can easily connect to the wireless LAN with the easy setup button (WPS button).
- 1) Check the position of the WPS button by referring to the instruction manual that is included in a wireless LAN access point or other document.
 - 2) Check that the wireless LAN access point starts and is operating properly.
 - 3) Turn on the printer.
 - 4) Press the down scroll button several times to select [Wireless(Infrastructure) Setting], and press the «ENTER» button.
 - 5) Enter the administrator password using the numeric (0-9) keys, and press the «ENTER» button. Enter the administrator password (see page 9).
 - 6) As [Wireless(Infrastructure)] is [Disable], press the scroll button to select [Enable] and press the «ENTER» button.
 - 7) Press the down scroll button several times to select [Automatic setup(WPS)] and press the «ENTER» button.
 - 8) Select [WPS-PBC], and press the «ENTER» button.

- 9) When [Pushbutton method] is displayed, select [Yes] and press the «ENTER» button.
 - The printer starts searching for wireless LAN access points. The "Running push button method..." message is displayed on the screen.
- 10) Press and hold WPS button on the wireless LAN access point for a few seconds while the message is displayed.
- 11) When [WPS connection successful.] is displayed, it indicates that the wireless LAN setup has completed.
- 12) If the antenna mark is displayed at the top right of the display screen, the connection is established correctly.
 - If [Connection failed. Timeout] is displayed, repeat the procedure from step 6.

Configuring Settings Using the Operator Panel

- If the wireless LAN access point does not support WPS, you can specify a wireless LAN access point you want to use from the wireless LAN access points that the printer detects to establish a connection. In such a case, you must enter an encryption key.
- 1) Follow steps 1 – 6 as indicated in the above Connecting with WPS section.
 - 2) Press the scroll button several times to select [Wireless Network Selection] and press the «ENTER» button.
 - The printer will search for available wireless LAN access points. This may take a minute or two.
 - 3) A list of available wireless LAN access point SSIDs are displayed. Press the up or down scroll button and select a wireless LAN access point to connect, and then press the «ENTER» button.
 - If only [Manual Setup] is displayed, or the SSID of the wireless LAN access point you want to use is not included in the list, set it by following the procedure in the next section 'Connecting by Manual Setup from Operator Panel'.
 - 4) Enter the encryption key, and then press the «ENTER» button.
 - 5) When 'Connection successful.' is displayed, select [Close], and then press the «ENTER» button.
 - If 'Connection failed.' is displayed, repeat the procedure from step 2.
 - If the antenna mark is displayed at the top right of the display screen, the connection is established correctly.

Configuring Settings Using the Operator Panel

- Set the wireless LAN access point information (the SSID, encryption method and encryption key) manually to connect to the wireless LAN.
- 1) Check the SSID, encryption key, and encryption method by referring to the instruction manual that is included in a wireless LAN access point or other documents, and write the information down.
 - 2) Follow steps 1 – 6 as indicated in the above Connecting with WPS.
 - 3) Press the scroll button several times to select [Wireless Network Selection] and press the «ENTER» button.
 - The printer will search for available wireless LAN access points. This may take a minute or two.
 - 4) A list of available wireless LAN access point SSIDs are displayed. Press the scroll button or, select [Manual Setup] at the end of the list, and then press the «ENTER» button.
 - 5) Enter the SSID you checked in step 1, and then press the «ENTER» button.

- 6) Select the encryption method you checked in step 1, and then press the «ENTER» button.
- 7) The procedure depends on the encryption method you selected in step 5:
 - If you selected [WPA/WPA2-PSK], select [TKIP/AES], and then press the «ENTER» button. Enter the Pre-shared Key afterward and select [Next].
 - If you selected [WPA2-PSK], select [AES], and then press the «ENTER» button. Enter the Pre-shared Key afterward and select [Next].
 - If you selected [WEP], enter the WEP Key, and press [Next].
- 8) If the displayed value is the same as the value that you checked in step 1, press the «ENTER» button.
 - It takes approximately 30 seconds for the printer to detect the wireless LAN access point.
- 9) When the screen indicates that connection is established, select [Close] and press the «ENTER» button.

Connecting the Printer Directly (AP Mode)

Automatic Connection (Push-button)

- Wireless LAN (AP mode) directly connects wireless devices (computers, tablets, smartphones, etc.) to the printer without using a wireless LAN access point.
 - You cannot enable wireless LAN (infrastructure) and wireless LAN (AP mode) at the same time.
- 1) Confirm the position of the WPS button on your wireless device by the manual attached to the device.
 - 2) Turn on the printer.
 - If the "Do you want to Set-up wireless?" message appears, select [No (Do not show next time)].
 - 3) Press the scroll button several times to select [Wireless(AP Mode) Setting] and press the «ENTER» button.
 - 4) Enter the administrator password using the numeric (0-9) keys, and then press the «ENTER» button.
 - 5) Press the up or down scroll button to select [Enable] and then press the «ENTER» button.
 - 6) Press the down scroll button to select [Automatic Setup (PushButton)] and press the «ENTER» button.
 - 7) Select [Yes], and then press the «ENTER» button.
 - 8) Start the WPS-PBC (push button) operation on your wireless device to connect to the printer.
 - When [Connection successful] is displayed, the setup of the wireless LAN is completed.
 - If [Connection failed] is displayed, follow the steps in "Manual Setup" to try again.

Manual Setup

- Wireless LAN (AP mode) directly connects wireless devices (computers, tablets, smartphones, etc.) to the printer without using a wireless LAN access point.
- 1) Turn on the printer.
 - 2) Press the down scroll button several times to select [Wireless(AP Mode) Setting] and press the «ENTER» button.

- 3) Enter the administrator password using the numeric (0-9) keys, and then press the «ENTER» button.
- 4) Press the up scroll button to select [Enable] and then press the «ENTER» button.
- 5) Press the scroll button several times to select [Manual Setup] and press the «ENTER» button.
- 6) Check the [SSID] and [Password] of the printer.
- 7) Input the printer's [SSID] and [Password] that were confirmed in step 6 for your wireless device.

Connecting via USB Cable

- 1) With the printer off, insert the square end of the USB cable into the back of the printer.
 - A USB 2.0 cable is included with your printer. USB 3.0 is not supported.
 - Do not insert the USB cable into the network interface connector. This may cause a malfunction.
- 2) Plug the flat end of the USB cable into your computer to complete the connection.

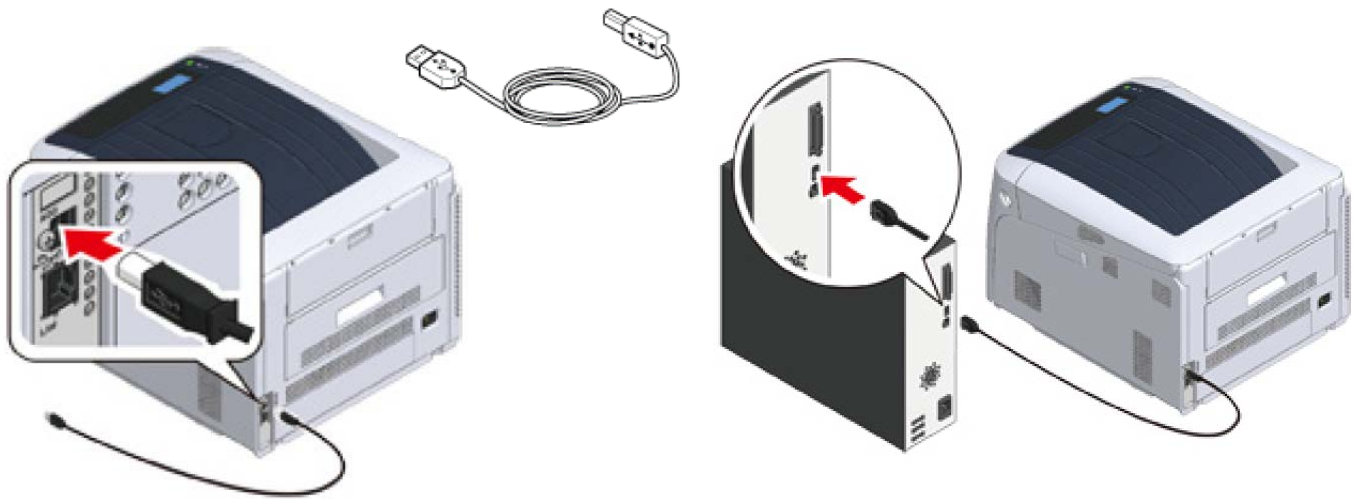

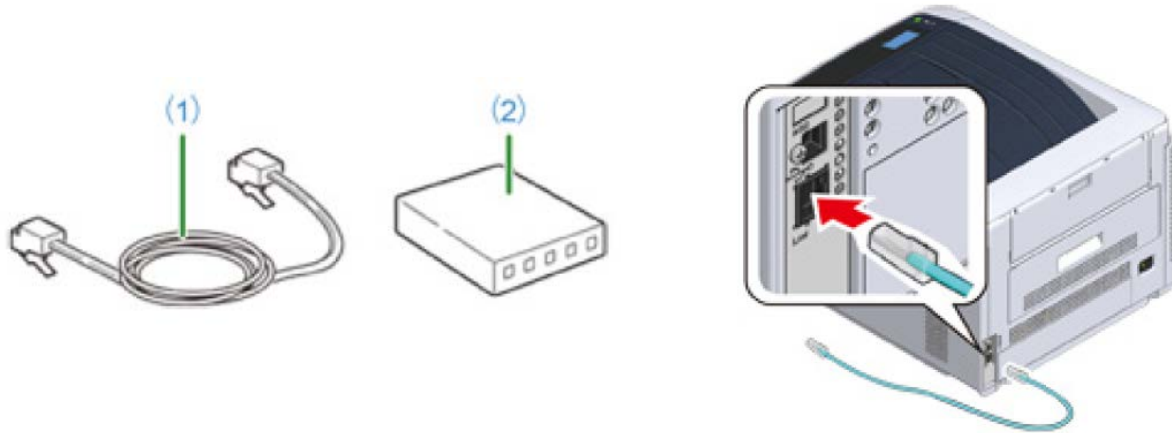

Connecting via Network (LAN) Cable

- 1) Prepare the LAN cable (1) and hub, switch or router (2).
- 2) With the printer off, insert one end of the LAN cable into the back of the printer.
 - A LAN cable is included with your printer.
 - Do not insert the LAN cable into the USB connector. This may cause a malfunction.
 - Do not connect both the LAN and the USB cable at the same time. This may cause a malfunction.

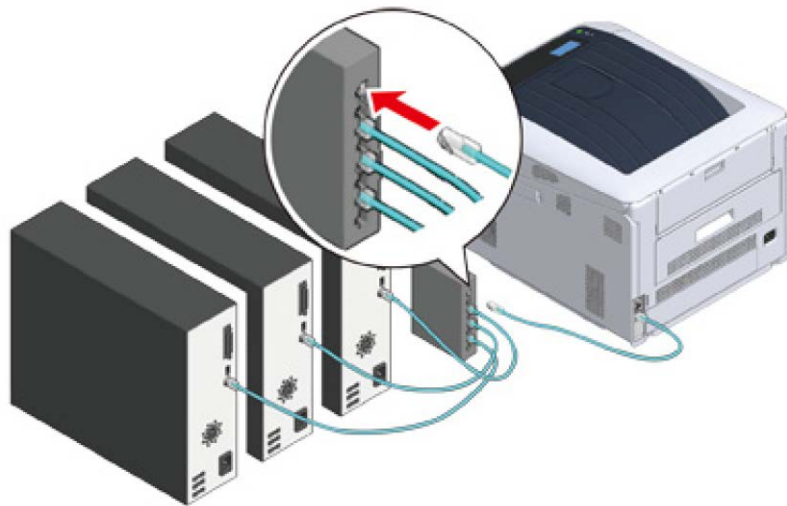

- 3) Plug the other end of the LAN cable into your hub, switch or router to complete the connection.
 - Do not plug this into the LAN connection of your computer. Doing so will not establish a connection.



 If you are connecting via Wi-Fi, it is not necessary to connect either the USB or LAN cable.

Setting a Static IP

! It is recommended to set a static IP to avoid other devices on your network from 'stealing' the printer's IP address when it is powered down.

- 1) With the printer on, press the down arrow several times to select [Admin Setup] and press the «ENTER» button.
- 2) Enter the administrator password, using the numeric (0-9) keys and press the «ENTER» button.
 - The factory default administrator password is "123456". If the administrator password is changed, enter the updated password.
- 3) Check that [Network Setup] is selected, press the «ENTER» button.

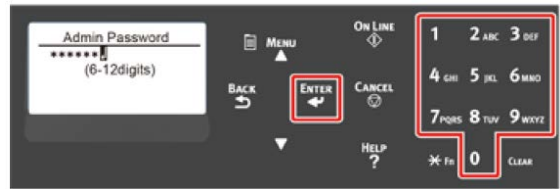
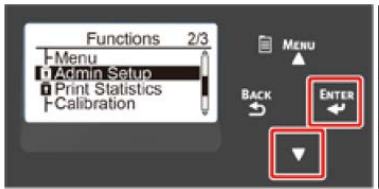

- 4) Press the down scroll button several times to select [IP Address Set], and press the «ENTER» button.
 - If setting the IP address manually, press the down scroll button and select [Manual], and press the «ENTER» button. Proceed to the step 5.
 - If obtaining the IP address automatically, check that [Auto] is selected, and press the «ENTER» button. Proceed to the step 11.

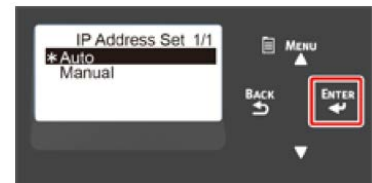
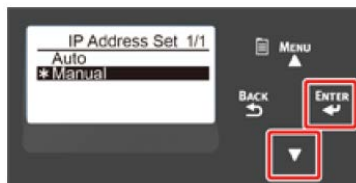

- 5) Press the «BACK» button until [Network Setup] is displayed. Press the down scroll button several times to select [IPv4 Address], and press the «ENTER» button.
- 6) Enter the IP address using the numeric (0-9) keys, and press the «ENTER» button.
 - In the same way, enter the next 3 digits. To move to the next box, press the «ENTER» button.

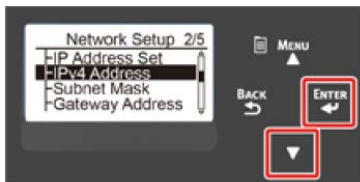

- 7) Press the down scroll button to select [Subnet Mask], and press the «ENTER» button.

8) Enter the subnet mask in the same manner as the IP address. When complete, press the «BACK» button.

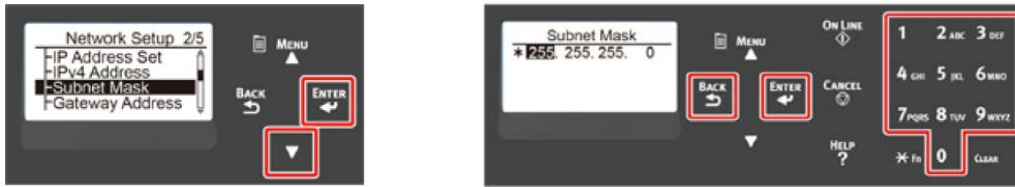

9) Press the down scroll button to select [Gateway Address], and press the «ENTER» button.

10) Enter the Gateway Address in the same manner of IP address. All input was completed, then press the «BACK» button.



11) Press the «ON LINE» button to complete the network settings.

