

# STARTING GUIDE for YUKON 52-58-62cc CHAINSAWS

Please read the safety instructions and manual before attempting to start your saw. Wear correct safety gear. Start by placing the chainaw on even ground. Hold the saw down by placing your boot in the rear handle and a hand on the top handle bar.

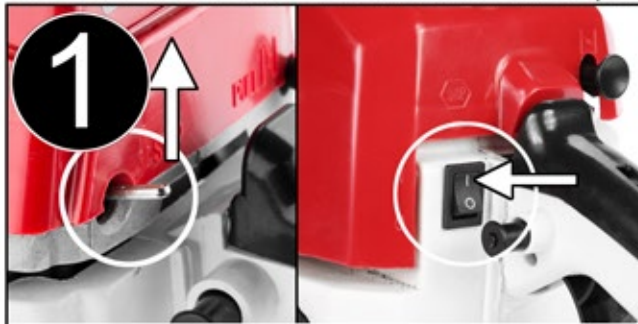

Put the kill switch UP (engine run)



Pull the choke OUT (choke ON)



Lock the throttle into the start position using the throttle-lock button



Engage the chain brake by pushing the safety handle forward until it clicks into place



Pull the starter handle several times until the engine is heard to splutter

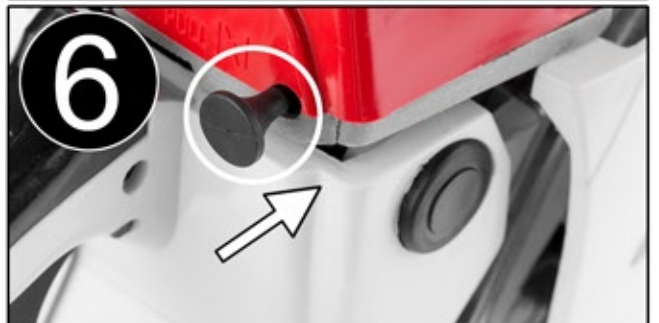

Push the choke IN (choke OFF)



Pull the starter handle several times until the engine starts



Disengage the throttle-lock by pulling and releasing the throttle trigger

Allow the engine to warm up before use. Disengage the chain break before revving the engine. Ensure all safety precautions are adhered to prior to using your saw.