



User Guide

Smart Tracker

There is a Blutrak for your everything

Designed to Find

1. Get the app

Please download our APP “BluTrak” from app store or play store. Or Scan QR code to download the app.



2. Turn on Bluetooth

Make sure your Bluetooth on your phone is on.
On your phone, you can tap “Settings->Bluetooth”



3. Sign Up for New User

Start “BluTrak” APP and tap the Sign up button

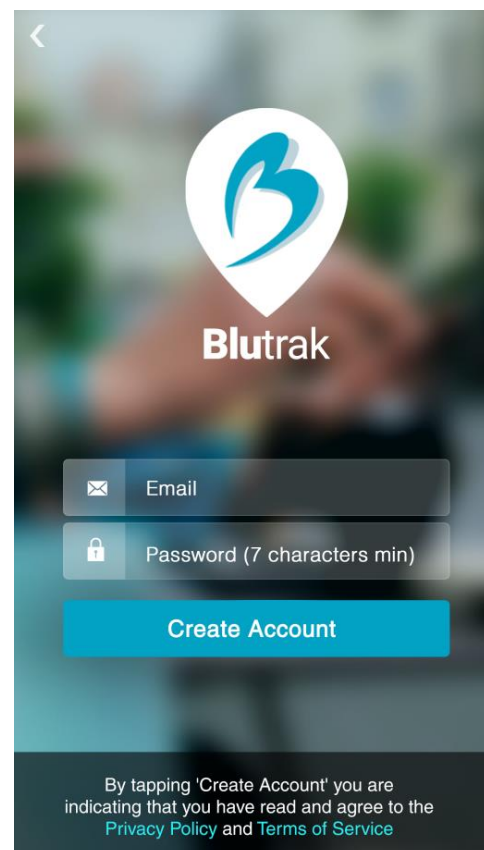
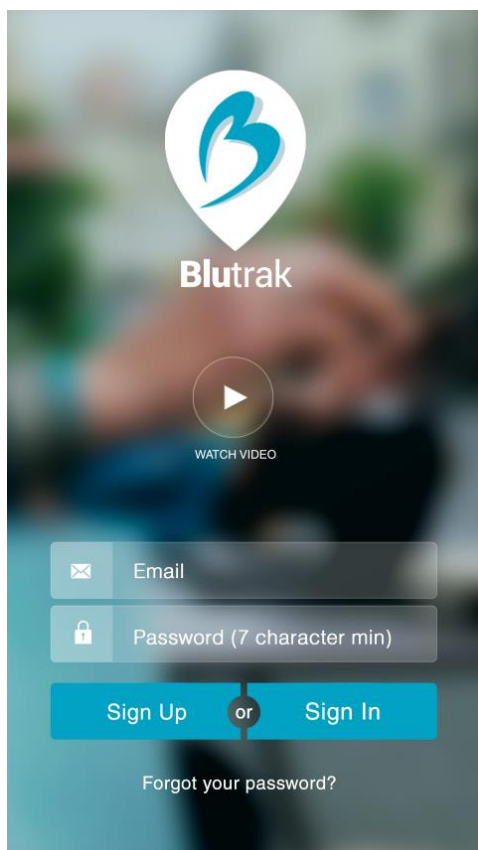

4. Pair the BluTrak to your phone

- 1). Make sure to turn on your phone's Bluetooth.
- 2). Hold the BluTrak device close to your phone.
- 3). Hold the button on the BluTrak device until you hear a beep and the LED starts flashing.



5. Find my phone via BluTrak

When BluTrak is connected to your phone, hold the BluTrak button and your phone will sound alert.

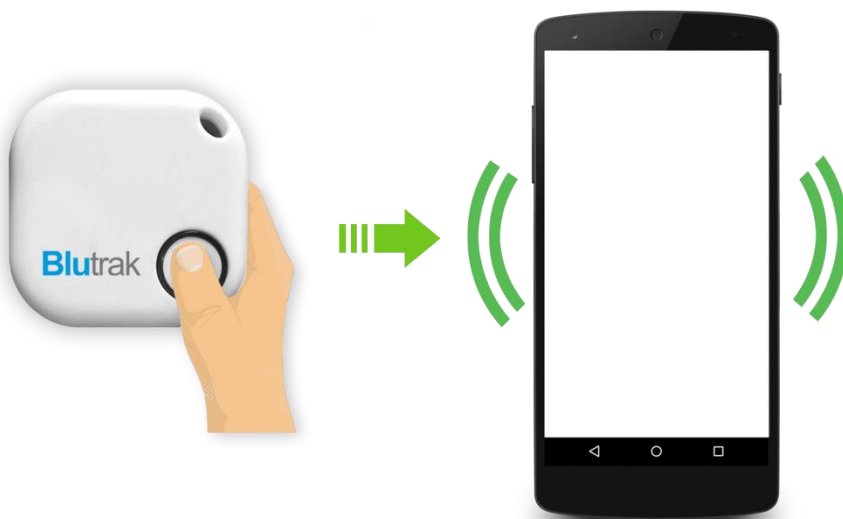

6. Find BluTrak via phone

When BluTrak is connected to your phone, open the BluTrak App and tap the “Ring” icon on the App, the device will beep and LED will flash.



7. Selfie

The button on the BluTrak device can be used to capture your moments. Never be left out of a group picture again.

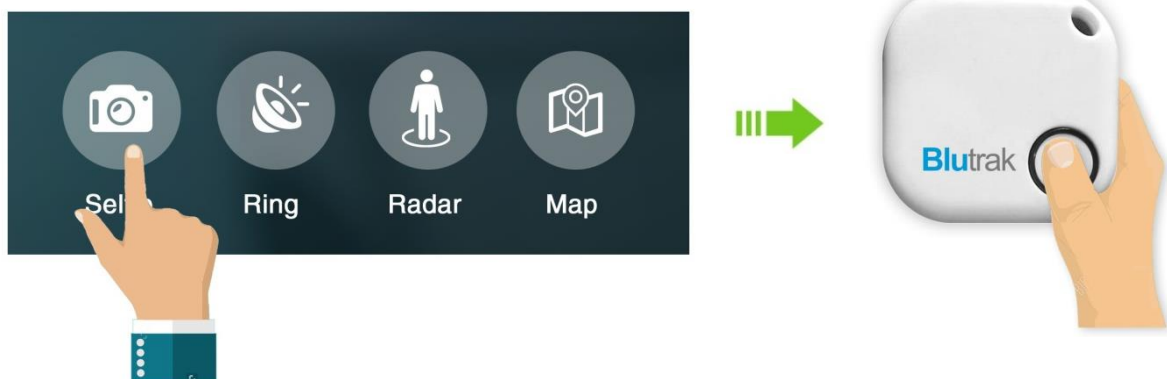

8. Know our BluTrak

1. Strap hole
2. Button: used for pair with phone and wake up the tracker
3. Notch
4. Led

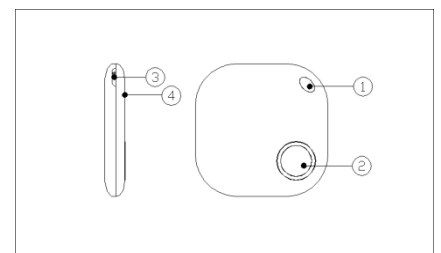

9. Change Battery

1. Open BluTrak from the notch side. If necessary, may require tools as flat-blade charger plug.
2. Take out the old battery and put a new CR2032 battery.
3. Close the BluTrak and press the button, it will restart.

