

# webafrica™

## Quick Start Guide

ZTE MF253

### WHAT'S IN THE BOX

- 1 Pre-Configured Router
- 2 Power Cable
- 3 Yellow Ethernet "LAN" Cable

**LET'S GET YOU SET UP!**  
Your router is pre-configured, so getting started is easy.

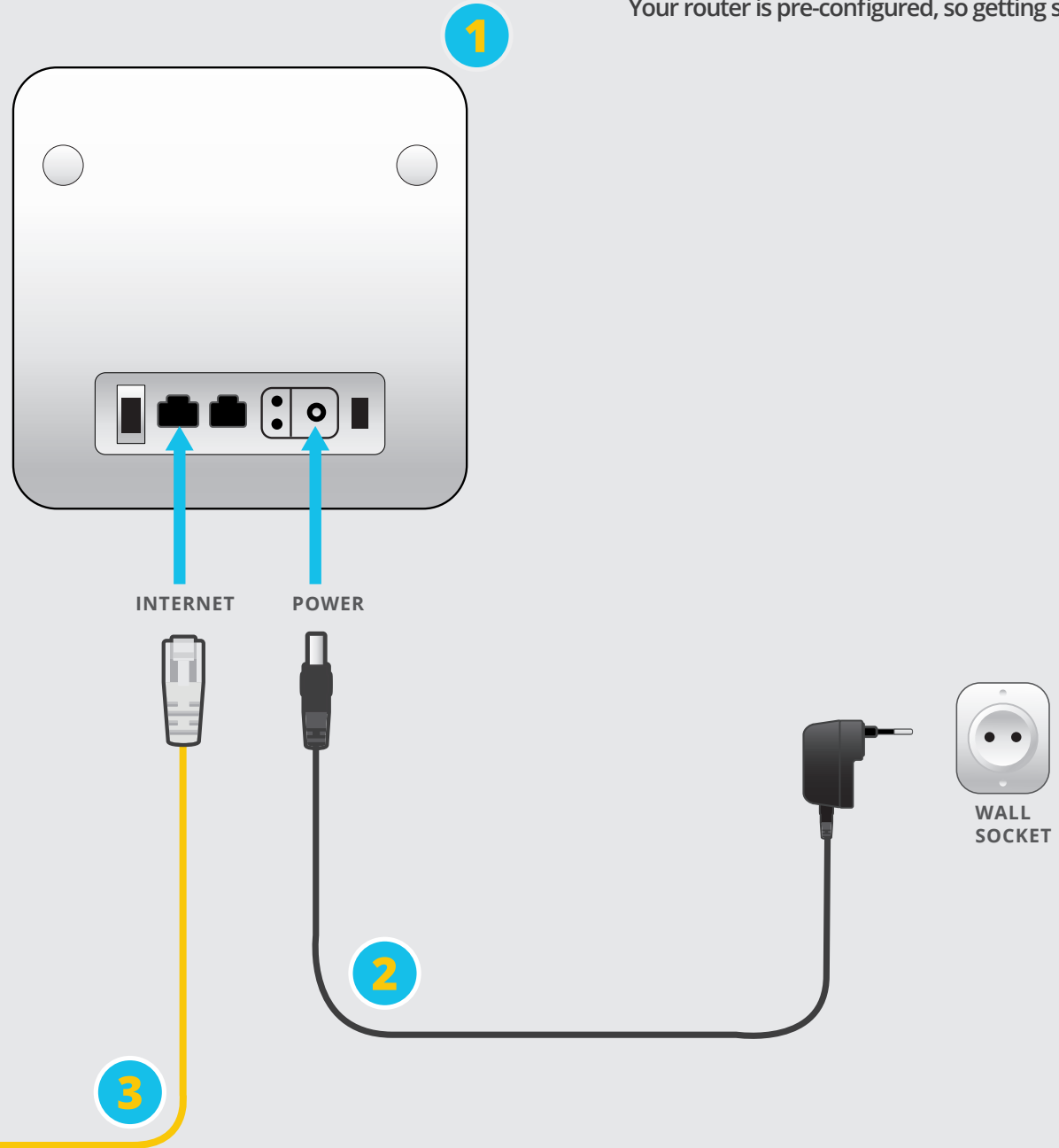

# ZTE MF253 SET UP

## STEP 1

Connect your ZTE router to your PC by either:  
Directly with the yellow LAN cable, or  
By Wifi, using the username and password which you will find on the sticker at the bottom of your router.

## STEP 2

Once connected, open your browser window (Google chrome, Firefox, Internet Explorer, etc.) and type in the following IP address in the URL field: **192.168.0.1**

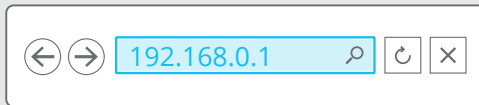

## STEP 3

In the window that opens, enter the default username and password:

**Username:** *admin*

**Password:** *admin*

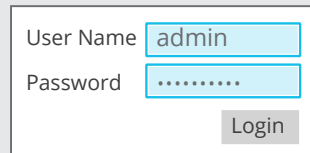
A screenshot of a login form. It has two input fields: "User Name" and "Password". The "User Name" field contains the text "admin". The "Password" field contains a series of dots. Below the fields is a "Login" button.

## STEP 4

Click the Wifi Settings Icon.

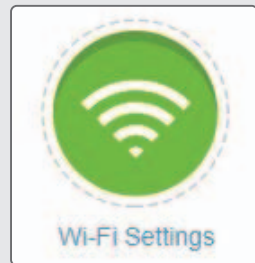

Click on the **"Main SSID"** button.

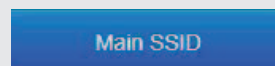

## STEP 5

In the window that opens, you can set your Wifi name and password to whatever you'd like.

*Network name (SSID):* This is where you set your Wifi name

*Password:* This is where you set your password.

A screenshot of the Wifi Settings configuration page. It shows several fields: "Network Name(SSID) \*" with the value "ZTE\_225096"; a checked checkbox for "Broadcast SSID"; an unchecked checkbox for "All the wireless client device is completely isolated"; "Security Mode" set to "WPA2(AES)-PSK"; "Password \*" with a masked password "\*\*\*\*\*"; an unchecked checkbox for "Display Password"; and "Max Station Number" set to "32".

Click **"APPLY"**



That's it! Your done.