

webafrica™

Quick Start Guide

Huawei B525 / B315 / B618 - LTE

WHAT'S IN THE BOX

- 1 Pre-Configured Router
- 2 Power Cable
- 3 Yellow Ethernet "LAN" Cable

LET'S GET YOU SET UP!
Your router is pre-configured, so getting started is easy.

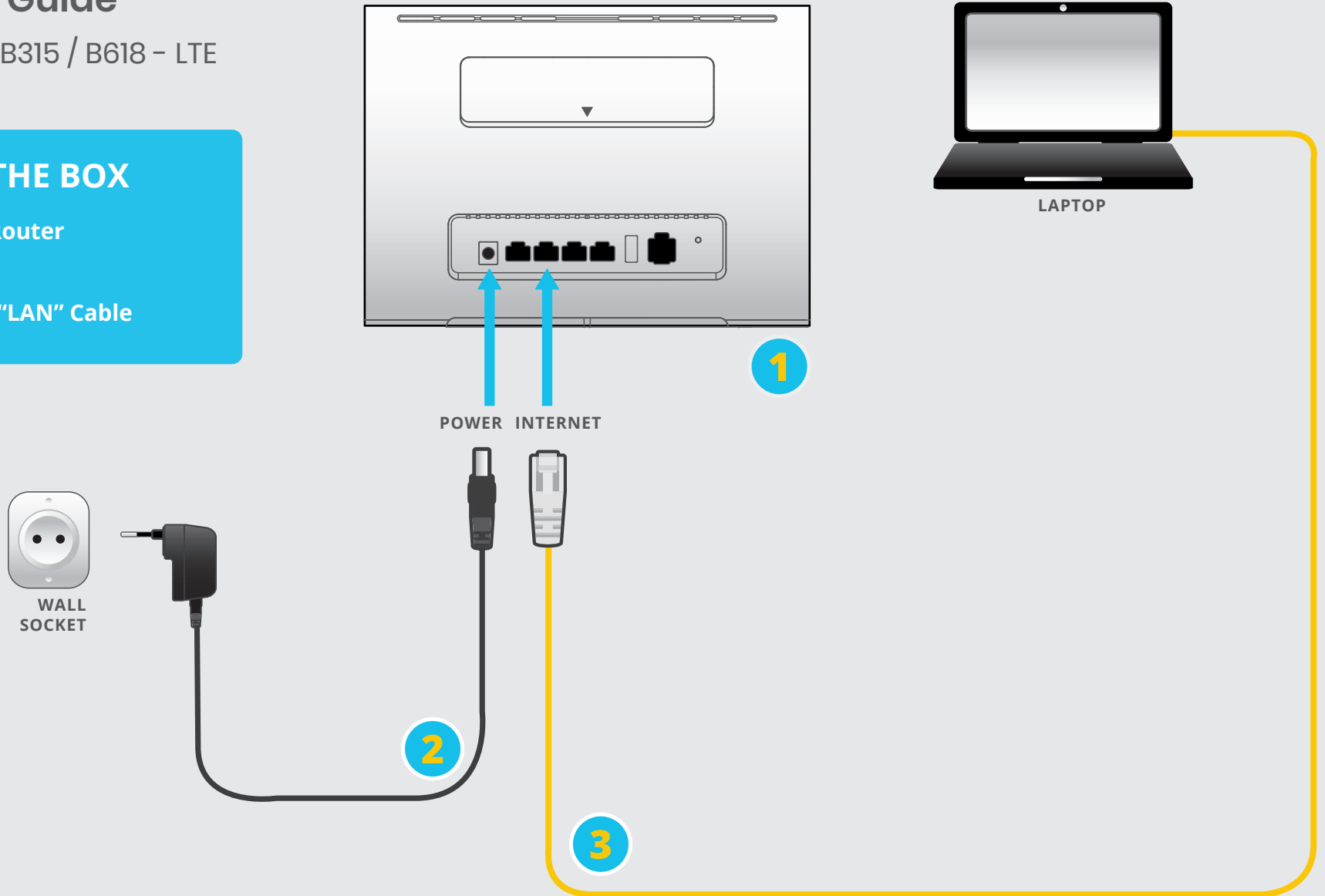

HUAWEI LTE WIFI SET UP

STEP 1

Open your Browser (Internet Explorer, Google Chrome, Mozilla Firefox, etc.)
Type in the following IP address: 192.168.8.1
This will let you log into the router and start your easy set up.

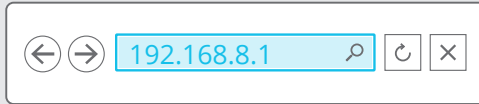

STEP 2

Enter the router's default username and password

Username: admin

Password: admin



STEP 3

Select the "Settings" tab from the top menu.
You will be prompted to re-enter the above login details.

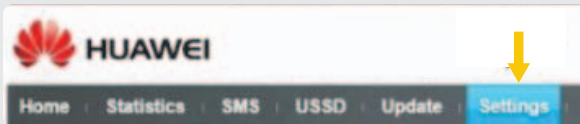

STEP 4.1

The quick Set Up Guide will pop up.
Tick the box next to "Auto Update" then click "next"

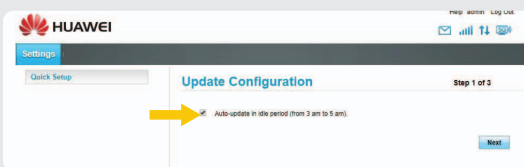

STEP 4.2

The next page to open will be called "configure WLAN settings".
This is where you get creative - set a WiFi name and password.
The SSID is your Wifi name.
The WLAN key is your Password.
Fill in what you would like these to be and click "next".
(Pro tip: write these down some place safe!)

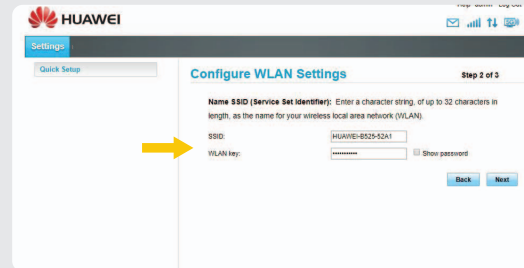

STEP 4.3

The final page to open up says "Modify Password".

This is where you can update the password of your router itself, and you will use this to log in here next time.
It's best to update this, and then save the password somewhere safe.

That's it! You're done!

