



INSTALLATION WARNINGS:

BEFORE COMMENCING INSTALLATION SWITCH OFF THE POWER BY REMOVING THE FUSE IN THE FUSE BOX OR ISOLATE THE MAIN SWITCH AS NEUTRAL IS A LIVE CONDUCTOR. If unit is to be used as a replacement for an existing product, remove existing unit from its location and disconnect the wiring. Connect the wires as shown in diagram below. Ensure terminals are properly tightened and ensure no bare wire is visible. When pushing back in to the backbox ensure no wires are trapped. Read the instructions care fully before starting the installation process and keep them for future reference. This product should be installed in accordance with the relevant sections of the building regulations code, and the current edition of the IEE Wiring Regulations (BS 7671:Requirements for electrical installations) and appropriate statutory regulations. If in any doubt, please contact a qualified electrician.

Installation

1. Remove the glass panel

Using a flat screwdriver align to aperture on bottom of cover and twist and lift to unclip

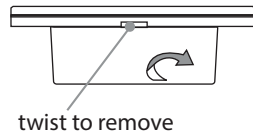

2. Wiring:

Wire as described in the diagram overleaf. Push wires firmly into terminals and tighten terminal screws so that wires are held securely. No bare wires should protrude from the terminals. Ensure correct wires are connect to the correct terminals, if incorrectly wired, this could damage the switch.

3. Fix screws:

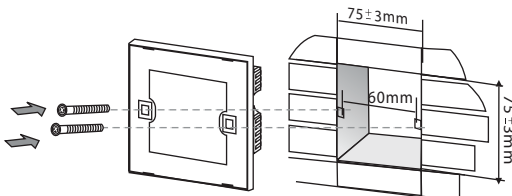

4. Re-attach the glass Surround:

Align the glass panel over the switch (A) and firmly push (B) to click into place.



Specification

Voltage: 220~240V ~ 50/60Hz

Output Power:

5.0V DC

2A / 2000mA

Working Temperature:

0°C~40°C Relative

Humidity: 10% - 93%

Measurement: 86x86mm

Backbox depth: 35mm

Wiring diagrams

Neutral Live

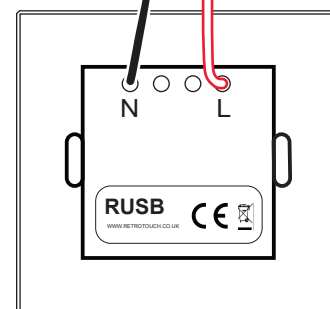

Back of
USB
Socket

RED or BROWN WIRE to terminal marked 'L'

BLACK or BLUE WIRE to terminal marked 'N'

Charging

Plug in USB

Suitable for Smartphones, tablets, iPod, iPad, Kindle and more. See instructions of your device

Charging

The indicator neon will illuminate red when charging.

Nearly charged

Once charged the neon indicator will flash blue and red indicating the battery is nearly charged.

Fully charged

Once fully charged the indicator neon will illuminate solid blue

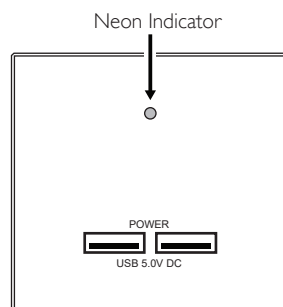

Retrotouch switches marked with the CE mark comply with the EC Low Voltage Directive: 73/23/EEC, Electromagnetic Compatibility Directive 89/336/EEC



Guarantee

All items purchased, come with a 1 year warranty (from date of purchase). Please keep proof of purchase.