

Wireless Keyboard for Xbox One Controller

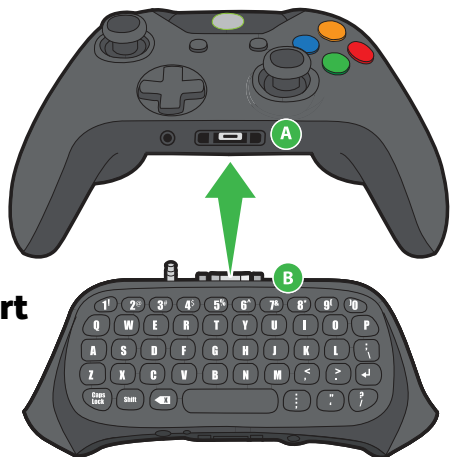

Quick Start Guide

Product Introduction

Designed for Xbox One controller. Fits perfectly with old and new original Xbox One controllers without affecting the use of headphones. It can input text and symbols conveniently and quickly.

Players can group chat with this keyboard comfortably. It is easy to connect and take out of the controller and can also combine with any version of Xbox One original controller: useful with in-game text messaging, instant messaging, and other text entry.

The keyboard surface is made of environmentally safe silicone and uses tactical feedback type keys to make it smooth and comfortable to your touch.

User Guide

1. Power on the Xbox One console and the indicator will be on.
2. Connect the controller with Xbox One console. (if you have any questions, please check the console manual.)
3. Aim the connector of the keyboard at Xbox One controller expansion port and the headset jack at the bottom of Xbox One controller. Then push the keyboard into the Xbox One controller slowly and securely. (Note: For new controllers, with the 3.5 audio jack, first lift the silicone cover by arrow direction at the bottom of the keyboard, then rotate 3.5 audio jack outward before attaching to controller.)
4. Insert the included 2.4GHz USB receiver into any USB port of Xbox One console. Move the controller within 6 inches of the installed receiver and press the pairing key on the bottom of the Xbox One keyboard within 15 seconds. It will be automatically paired while the blue indicator on the keyboard flashes. (Note: When pairing, the distance between keyboard and receiver must be within 6 inches, if it fails, do above steps again.)
5. Pairing is successful when the blue indicator goes off.
6. Pair only once between the Xbox One keyboard with 2.4GHz receiver. Turn on the console to awake the controller and keyboard.
7. Keyboard will enter sleep mode when the Xbox One controller sleeps. Please press "X" Button to awake.

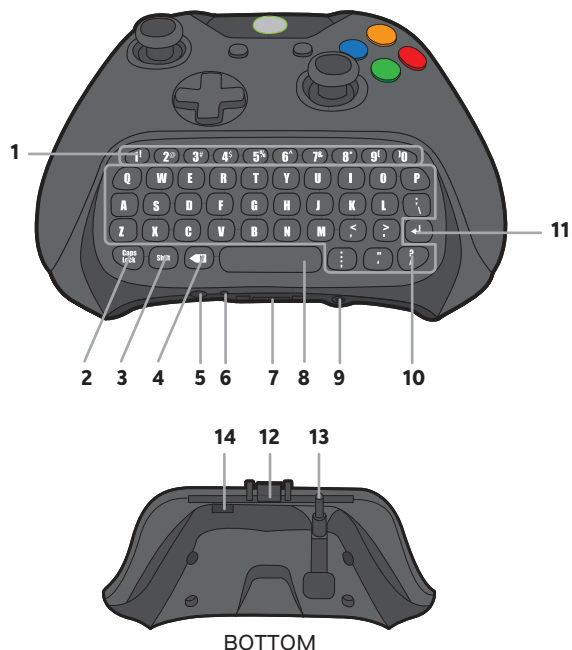
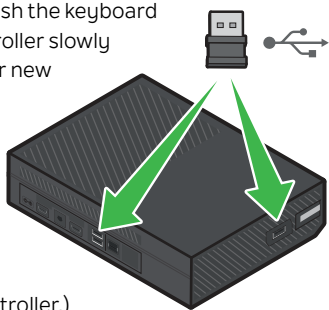

BOTTOM

Functional Buttons

- | | |
|------------------------------------|--------------------------------------|
| 1. 0-9 (NUMBER key) | 9. 3.5mm audio jack |
| 2. CAPS LOCK | 10. 26 LETTERS and SYMBOL keys |
| 3. SHIFT | 11. ENTER |
| 4. BACKSPACE | 12. Xbox One earphone jack |
| 5. Pairing key | 13. 3.5 audio jack |
| 6. 2.4G pairing indicator | 14. Storage port for 2.4GHz receiver |
| 7. Xbox One original earphone jack | |
| 8. SPACE bar | |

Specifications:

- Applicable range: Xbox One controller.
- Wireless Technology: 2.4GHz
- Wireless distance: Effective range: 8-10 meter
- Working current (press the buttons): 0.8mA
- Working current (No button pressing): 8uA
- Product dimension: 142x63x45mm (5.6x2.5x1.8in)
- Material: ABS

Cautions

- In order to use this product correctly and ensure it works well, please read the following carefully.
- Do not drop or hit the keyboard on hard surfaces.
- Do not let this product come in contact with benzene, thinner, chemical, etc.
- Do not take close to strong magnetic fields or electric fields.
- Please avoid contact with high intensity lighting or heating equipment.
- Do not attempt to take apart, modify or repair by yourself.
- Dispose of properly according to applicable laws.

Wireless Troubleshooting

Interference can come from other electronics and appliances that aren't connected to your game system, but use the same 2.4GHz frequencies to communicate. Wifi routers, cordless phones, bluetooth devices, baby monitors and wireless video security systems are some examples.

If you find that you have a poor or inconsistent wireless performance in your room, see if any of these devices are nearby. In most cases, simply moving your wireless device farther away from the source of interference is enough to solve the problem. Turning off wireless capabilities on nearby devices can also help troubleshoot which to consider relocating for better wireless performance.