

# CONNECTION INSTRUCTIONS

# RGB LED Sync Controller and Receiver Guide

## ADDRESS SETTING

Use this button to pair Receiver to RF Remote or WiFi Controller.

## Maximum Output

6A x 3CH Max Output  
12VDC-144W Max  
24VDC-288W Max

## Top View of Wireless Receiver

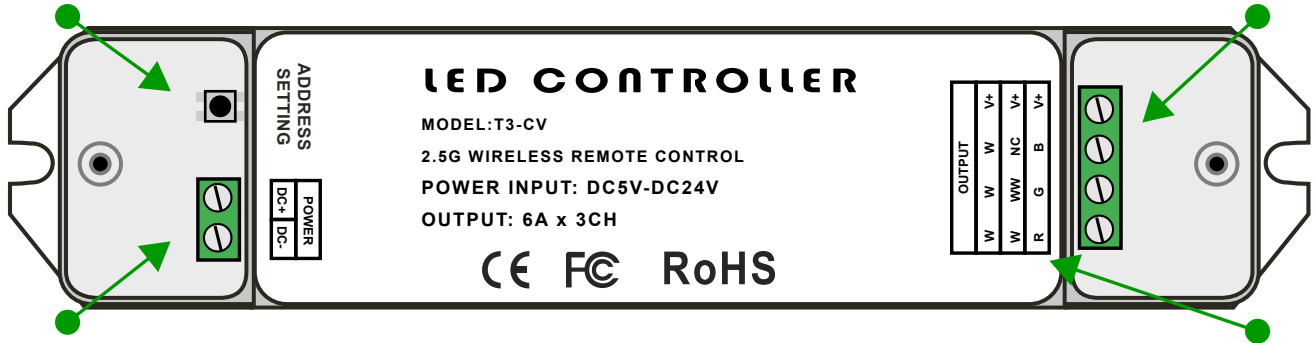

**5-24VDC INPUT**  
Input from 5-24VDC power supply

**Single Channel Output**  
6A x 1CH Max Output  
12VDC-72W Max  
24VDC-144W Max

## T3 Remote

## Connecting with RGB Color Changing LEDs

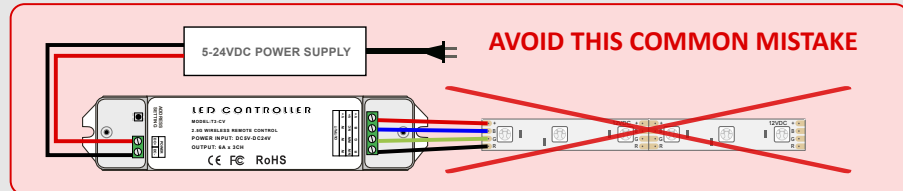
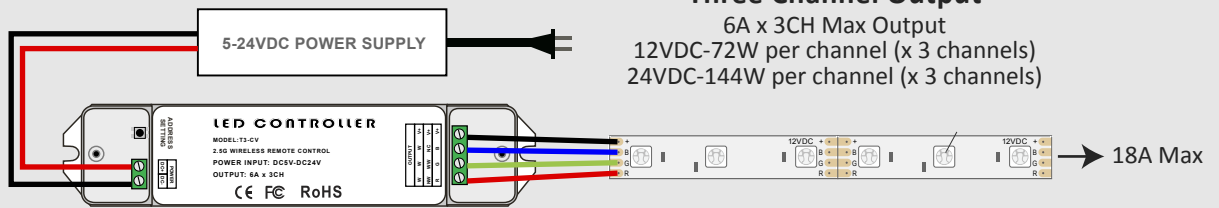

## Receiver Pairing Instructions

- 1.) Apply 5-24VDC power to your wireless receiver
- 2.) Turn on power to your T3 remote
- 3.) Press the address setting button once on your wireless receiver and let go
- 4.) The small address setting indicator light will turn solid red
- 5.) Immediately press and hold any button on the T3 remote that you wish to pair
- 6.) Hold until you hear a long beep
- 7.) The LED light on the T3 remote will flash 3 times
- 8.) Your wireless receiver is now paired
- 9.) Repeat this process for multiple receivers
- 9.) To un-pair a receiver press and hold the address setting button for 5 seconds until a long beep

Controller sign	Remote control sign	Button	Description
		ON/OFF	• Turn the controller on/off
	PAUSE 	PAUSE	• Short press to pause at current color • Short press to un-pause and play current mode • Press and hold for 3 seconds to turn on/off controller beeping
	MODE+ MODE-	MODE+ MODE-	• Short press to navigate between the next or previous mode
	SPEED+ SPEED-	SPEED+ SPEED-	• Short press to increase or decrease speed on color changing modes.
	BRT+ BRT-	BRT+ BRT-	• Short press to increase or decrease brightness
		Full-Color Touch circle	• Touch the color wheel to choose an array of static colors
	1 2 3 4 5 6 7 8 9 PLAY	9 DIY keys	• Short touch to play stored scenes • Press and hold number for 3 seconds to save the present mode, save one mode per number on remote keypad • Press "PLAY" to play through saved modes on keypad, static colors will be skipped playing only color changing effects