

› em4

Accessories

Temperature probes

- › Thermocouple J:
 - Nickel-plated brass eyelet
 - Stainless steel casing
 - Stainless steel sheath
- › Thermocouple K
- › Pt100 Class B:
 - Stainless steel sheath
 - Aluminium vee
- › Connection/Sub-base/Flange
- › For use with temperature converters



Temperature probes

Specific characteristics			
Designation	Temperature	Characteristics	Code
Thermocouple probe J	max.: 400 °C	Thermocouple probe J with nickel-plated brass eyelet Ø 6.5 mm, connection sleeve Ø 5 x 30 mm in stainless steel 316 L. Glass filament cable with stainless steel braid: 2 m long Hot junction isolated from earth	79 696 030
Thermocouple probe J	max.: 600 °C	Thermocouple probe J with casing St. steel 304 L Ø 3 mm: 500 mm long PVC cable: 2 m long Junction cannot be removed Junction isolated from earth	79 696 031
Thermocouple probe J	max.: 400 °C	Thermocouple probe J with sheath ST steel 316 L Ø 5 mm: 30 mm long Glass filament cable with stainless steel braid: 2 m long Junction isolated from earth	79 696 033
Thermocouple probe J	max.: 400 °C	Thermocouple probe J with sheath St. steel 16 L Ø 6 mm: 200 mm long Glass filament cable with stainless steel braid: 2 m long Junction isolated from earth	79 696 032
Thermocouple probe K	max.: 1100 °C	Thermocouple probe K with casing St. steel 304 L Ø 3 mm: 500 mm long PVC cable: 2 m long Junction isolated from earth	79 696 034
Pt100 probe Class B	max.: 200 °C	Pt100 probe Class B with sheath St. steel 316 L Ø 6 mm: 200 mm long Silicon teflon cable: 2 m long 3-wire assembly	79 696 035
Pt100 probe Class B	max.: 200 °C	Pt100 probe Class B Aluminium vee: 50 mm long Silicom teflon cable: 2 m long 3-wire assembly - Supplied with fixing clamp	79 696 037
Pt100 probe Class B	max.: 400 °C	Pt100 probe Class B with sheath St. steel 316 L Ø 6 mm: 30 mm long Glass filament cable with stainless steel braid: 2 m long 2-wire assembly	79 696 036

Accessories		
Description	Characteristics	Code
Connection	Sliding connection 1/4 BSP CYL. St. steel 316 L Ø 3 mm	79 696 038
	Sliding connection 1/4 BSP CYL. St. steel 316 L Ø 6 mm	79 696 039
	Sliding connection 1/2 BSP CYL. St. steel 316 L Ø 6 mm	79 696 040
Sub-base	Sliding connection 1/4 BSP CYL Ø 12 mm Nickel-plated steel	79 696 041
Flange	Inox flange Ø 6 mm	79 696 042

Diagrams
Dimensions (mm)

Connection: 79 696 038

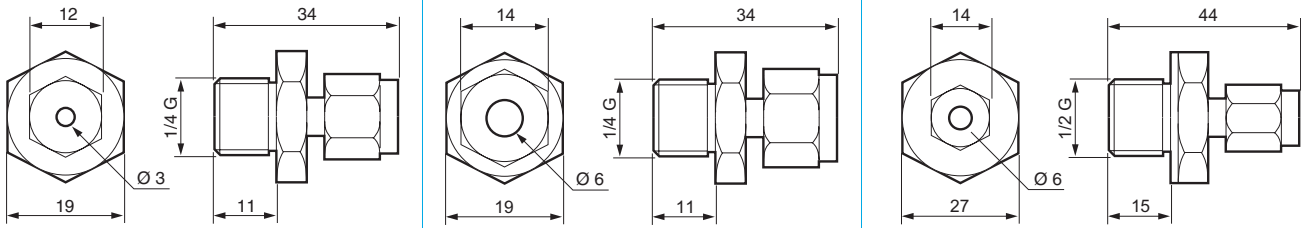

Sub-base: 79 696 041

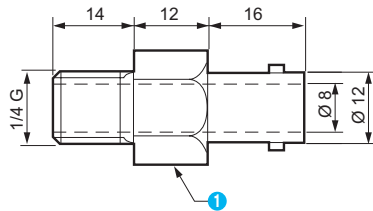

Flange: 79 696 042

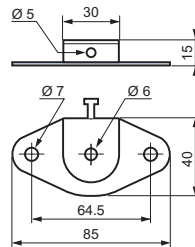

1 17 across flat

Thermocouple probe J: 79 696 030

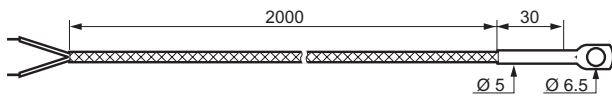

Thermocouple probe J: 79 696 031

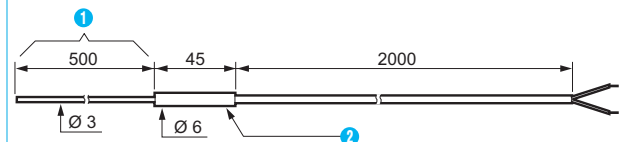

Thermocouple probe J: 79 696 032

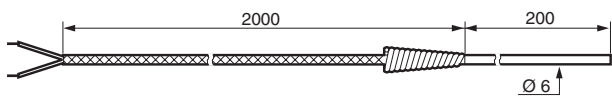

Thermocouple probe J: 79 696 033

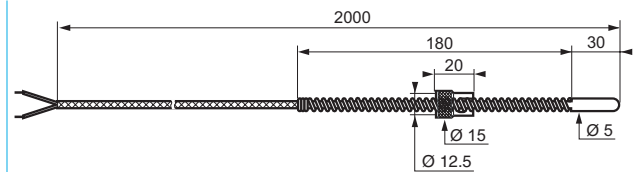

Thermocouple probe K: 79 696 034

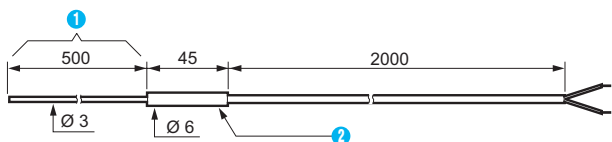

Pt100 probe Class B: 79 696 035

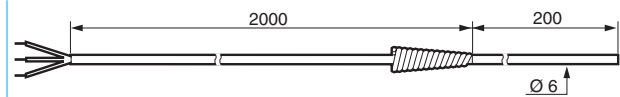

1 Flexible
2 Stainless steel sleeve

Pt100 probe Class B: 79 696 036

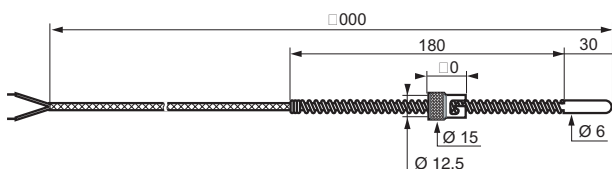

Pt100 probe Class B: 79 696 037

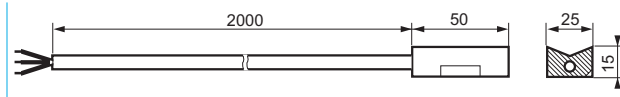

Aluminium vee (This part is removable)