

# > em4

## Accessories

### DC/DC converters

- > Power supply for extended input voltage range
- > Provides your devices with a constant supply voltage
- > Primary/secondary isolation
- > Useful in case of battery use



6 → 10 w DC/DC converter

Specific characteristics				
Designation	Input	Output	Nominal power	Code
DC/DC converter	9.2-36 V $\overline{\text{---}}$	24 V $\overline{\text{---}}$	6 → 10 W	88 950 321

General characteristics	
Certifications	CE
Output voltage	24 V $\overline{\text{---}}$ $\pm$ 5 %
Overvoltage	40 V $\overline{\text{---}}$ max.
Input limits	16 → 36 V $\overline{\text{---}}$ (10 W available) 9.2 → 16 V $\overline{\text{---}}$ (see diagram)
Isolation primary / secondary	1500 V $\overline{\text{---}}$
Operating temperature	-30 → +70 °C
Storage temperature	-40 → +80 °C
Immunity from micro power cuts	At 10 W: > 1 ms for 16 V < U < 18 V 5 ms for U $\geq$ 18 V At 6 W: > 1 ms for U < 12 V > 5 ms for 12 V $\leq$ U < 18 V > 10 ms for U $\geq$ 18 V

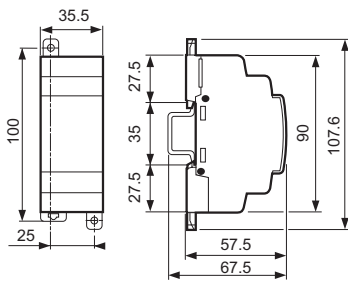
**Diagrams****Dimensions (mm)****Curves****Input limits**