

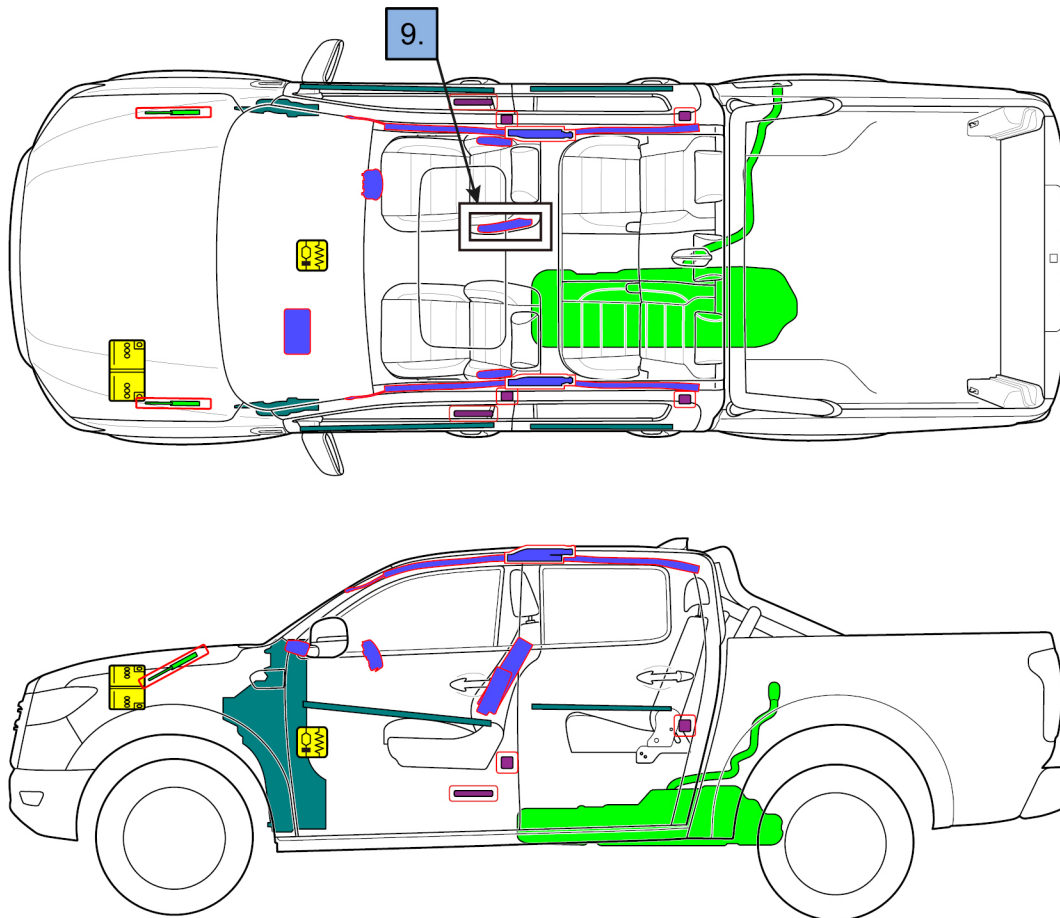

**Great Wall Motors POER**  
**Pickup Double Cab**  
**from 08/2020**

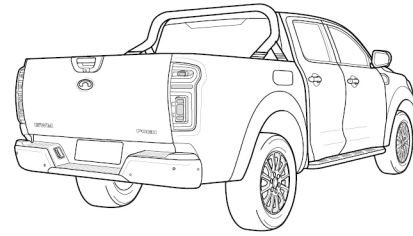
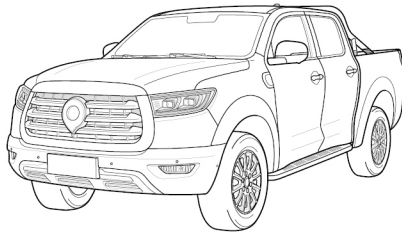

**Legend**

	Airbag		Stored gas inflator		Seat belt pretensioner		SRS control unit		Pedestrian protection active system
	Automatic rollover protection system		Gas strut/Preloaded spring		High strength zone		Zone requiring special attention		
	Battery low voltage		Ultra capacitor, low voltage		Fuel tank		Gas tank		Safety valve
	High voltage battery pack		High voltage power cable/component		High voltage disconnect		Fuse box disabling high voltage system		Ultra capacitor, high voltage

This overview shows the maximum range of equipment of the vehicle.  
 For more information see the emergency response guide.

**ID No.**

**Version No.**

**Page No.**

LGW-POER-1

V1

1/4



Great Wall Motors POER  
Pickup Double Cab  
from 08/2020



## 1. Identification / recognition

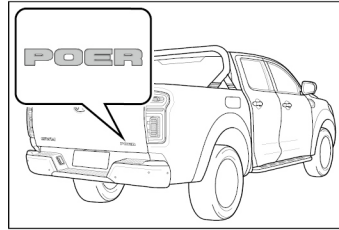
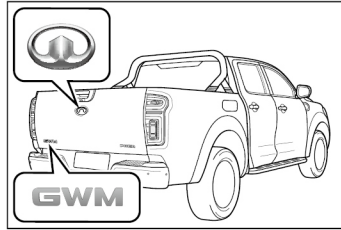
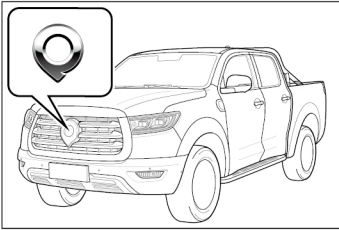

## 2. Immobilisation / stabilisation / lifting

### Immobilize vehicle

1. Block wheels and set parking brake;

› Manual parking brake

› Electronic parking brake

2. Press "P" button to select Park position.

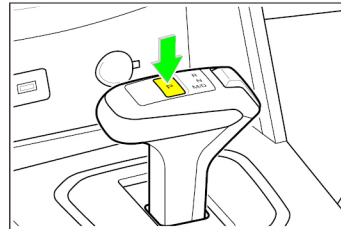
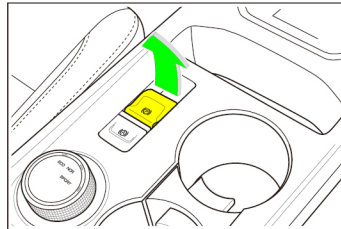
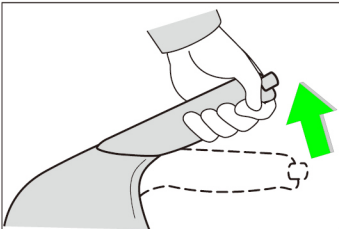

### Stabilisation-lifting points

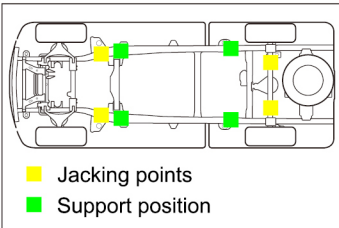

## 3. Disable direct hazards / safety regulations



**EVEN IF THE ENGINE IS STOPPED, THE VEHICLE MAY NOT BE SHUT OFF. IF THE VEHICLE IS NOT COMPLETELY SHUT OFF, THE ENGINE MAY SUDDENLY START OR THE VEHICLE MAY START TO MOVE.**

### Main method

Shut power off

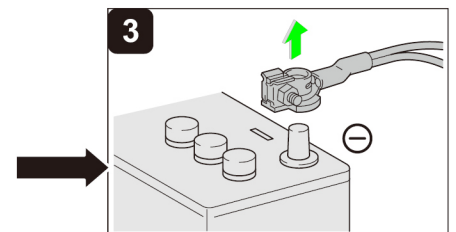
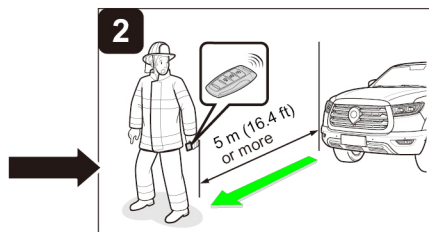
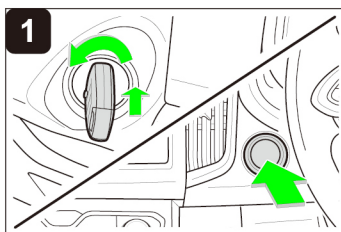

This overview shows the maximum range of equipment of the vehicle.  
For more information see the emergency response guide.

ID No.	Version No.	Page No.
LGW-POER-1	V1	2/4

**Access to 12V battery**

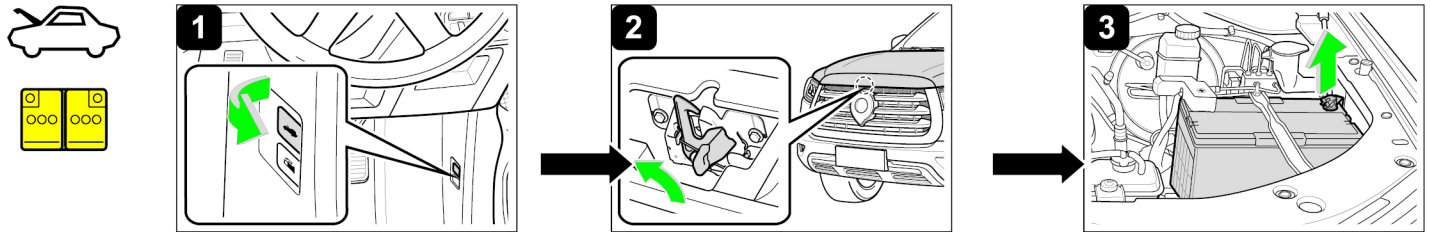

**4. Access to the occupants**

**High strength steel**

**Seat adjustment**

**Steering column adjustment**

› Mechanical

› Electrical

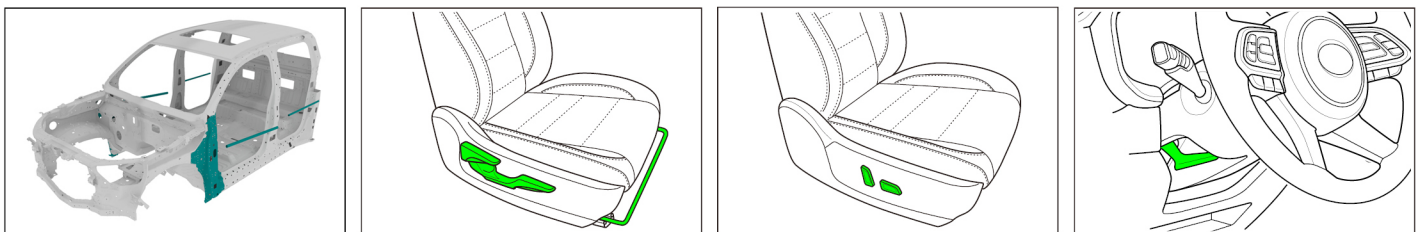

**WHEN THE 12 V BATTERY IS DISCONNECTED, ELECTRICAL COMPONENTS CANNOT BE OPERATED.**

**Glass types**

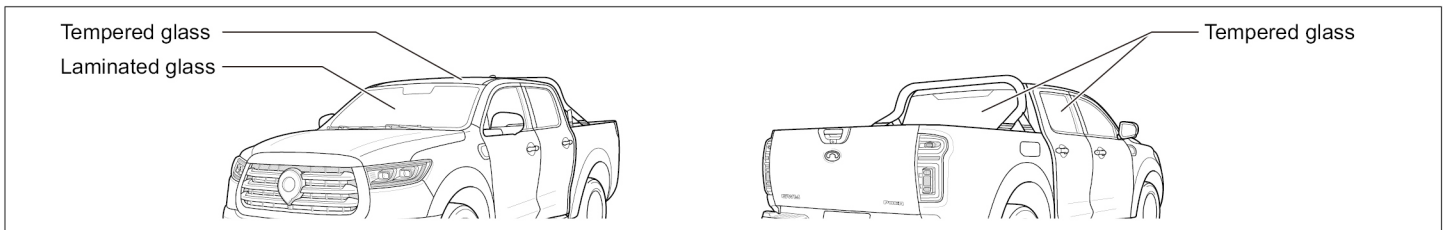

**5. Stored energy / liquids / gases / solids**

		<p>12 V</p>
		<p>( 78±3 ) L</p>

**6. In case of fire**

 **USE LARGE AMOUNTS OF WATER.**



**7. In case of submersion**

**TILT THE VEHICLE TO ONE SIDE TO ALLOW WATER TO DRAIN OUT OF THE VEHICLE.**



**Great Wall Motors POER**  
**Pickup Double Cab**  
**from 08/2020**



Proper personal protective equipment should be worn when handling any flooded vehicle. Pull the vehicle out of water as much as possible, immobilize the vehicle and disable the vehicle before starting any operation.

## 8. Towing / transportation / storage

### Location front hook

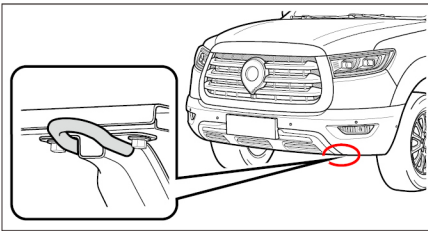

### Location rear hook

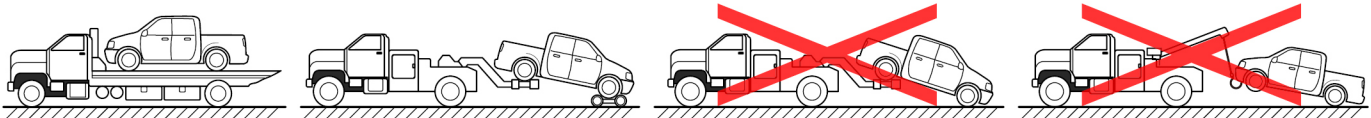
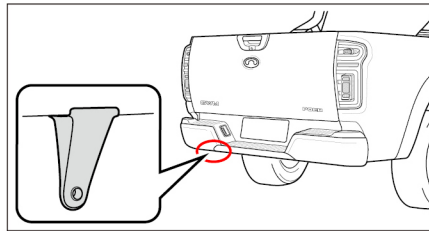

**STORE AT SAFE DISTANCE FROM OTHER VEHICLES!**

## 9. Important additional information

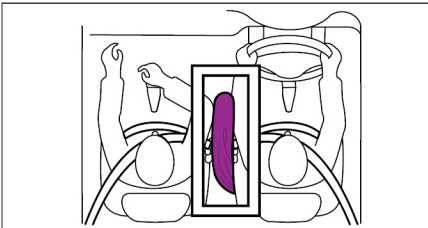

Driver's seat has a far side airbag in addition to the side airbag. Location of far side airbag is shown in the mark **9.** on page 1.



**DO NOT APPLY EXCESSIVE FORCE TO NOR STRONGLY HIT THE AIRBAG INSTALLATION AREA.**

## 10. Explanation of pictograms used

Pictogram	Designation
	Device to shut down power in vehicle
	Remove smart key
	Hood

Pictogram	Designation
	Flammable
	Explosive
	Corrosives

Pictogram	Designation
	Hazardous to the human health
	Use water to extinguish the fire

This overview shows the maximum range of equipment of the vehicle. For more information see the emergency response guide.

ID No.	Version No.	Page No.
LGW-POER-1	V1	4/4