

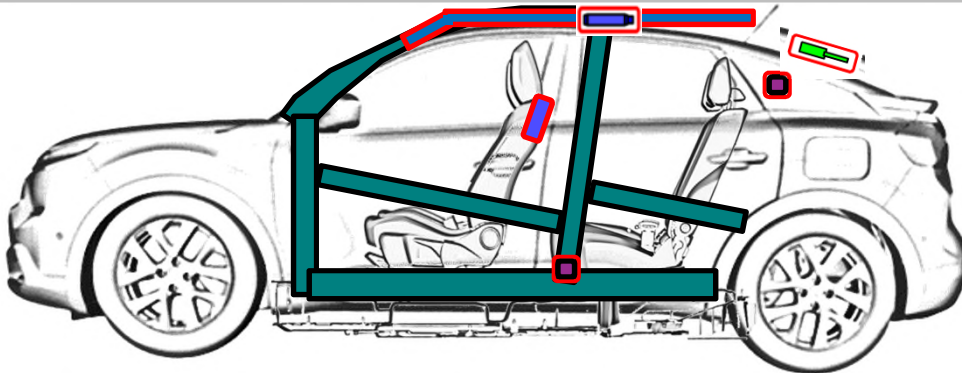

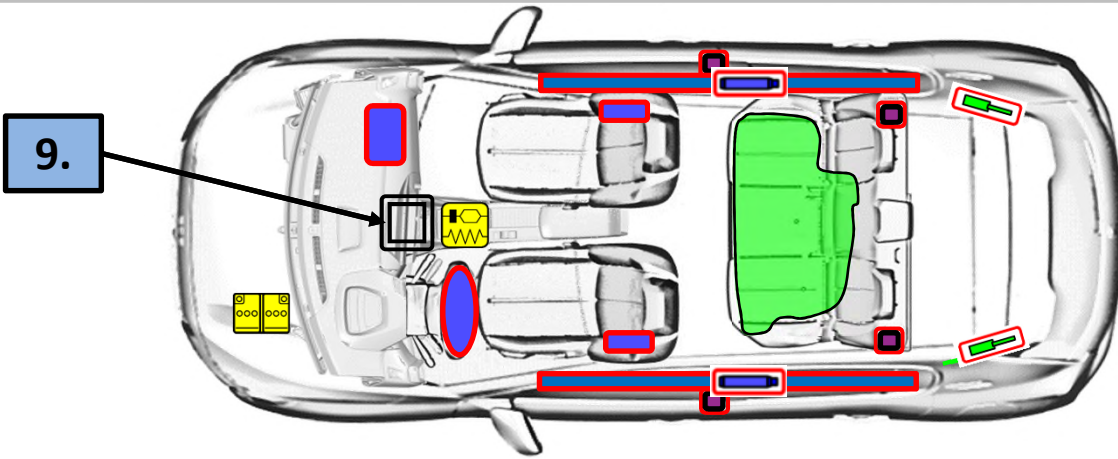







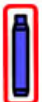



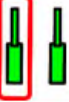

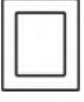

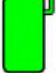
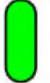
Note: The Rescue Sheet depicts a LHD vehicle (as allowed under the ISO 17840-1). All components (other than steering wheel and passenger airbag) are located in the same position in the Aust/NZ RHD model.



	airbag		Stored gas inflator		Seat belt pretensioner		SRS control unit		Pedestrian protection active system
	Automatic rollover protection system		gas strut and triggered pre-loaded spring / pre-loaded spring		High strength zone		Zone requiring special attention		
	Battery low voltage		Ultra-capacitor, low-voltage		Fuel tank		Gas tank		Safety valve
	Battery pack, high-voltage		High voltage power cable		High voltage device that disconnects high voltage		Fuse box disabling high voltage		High voltage ultra-capacitor

## 1. Identification/recognition

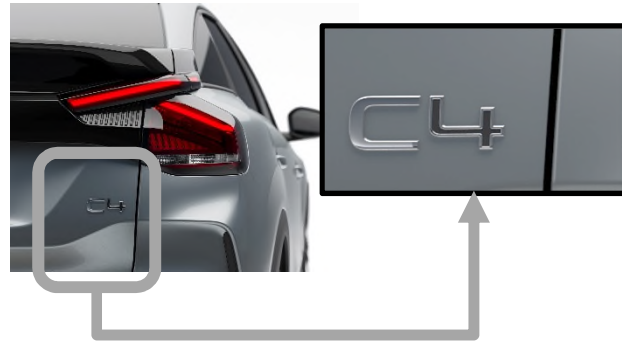

## 2. Immobilisation/stabilisation/lifting

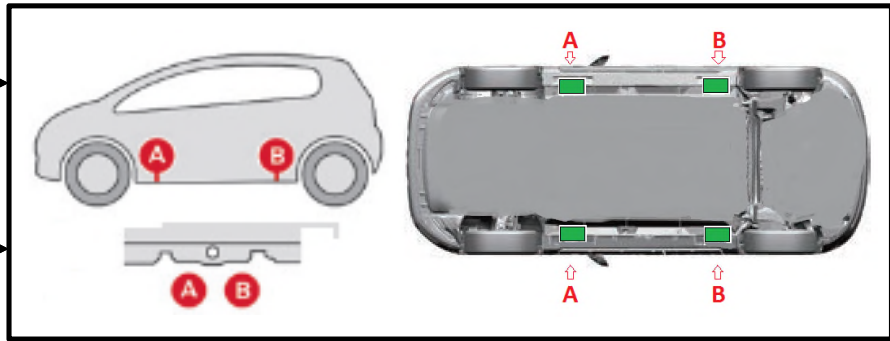
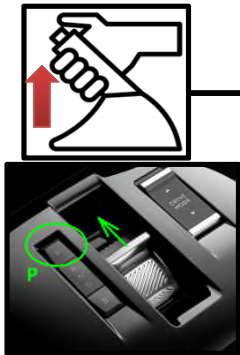

## 3. Disable direct hazards / safety regulations

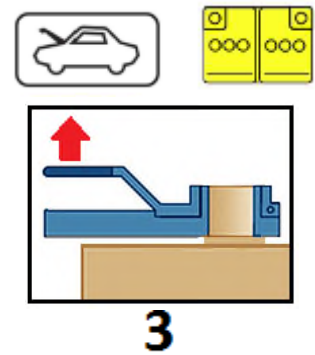
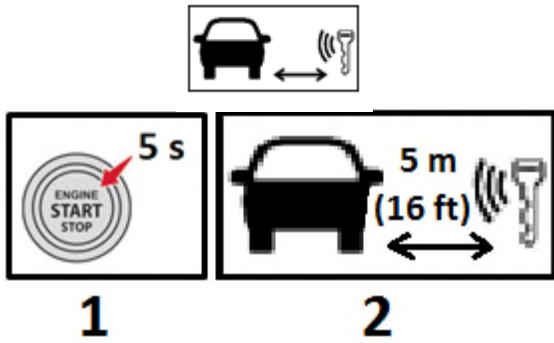

## 4. Access to the occupants

Toughened glass

Laminated glass

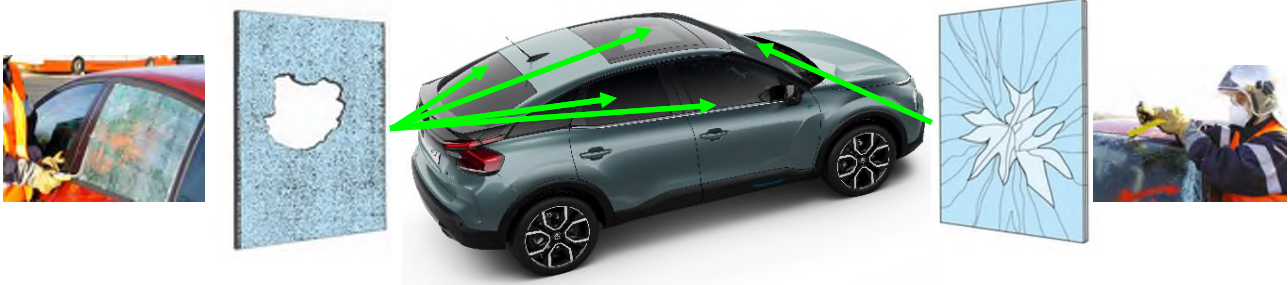

## 5. Stored energy/liquids/gases/solids



50 l

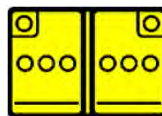

12 V



## 8. Towing /transport/storage

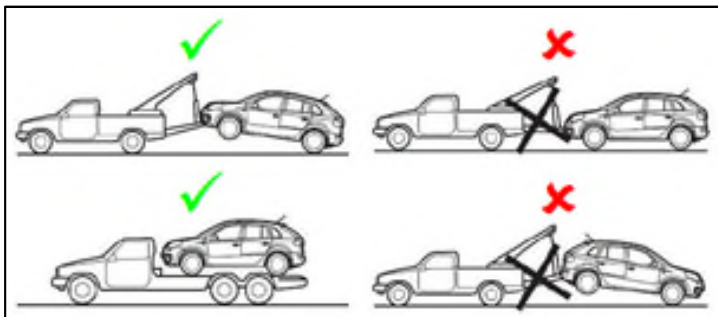
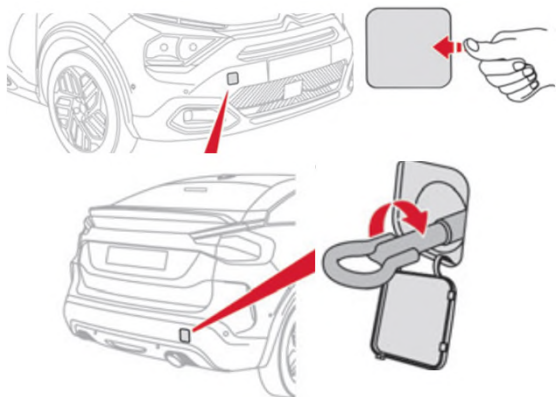

## 9. Important additional information

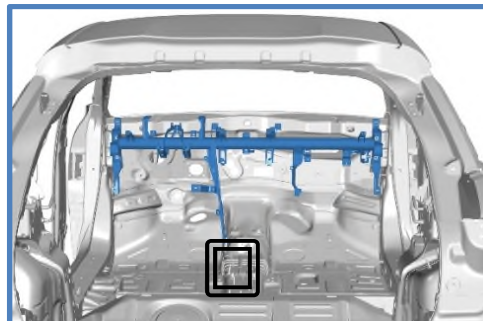
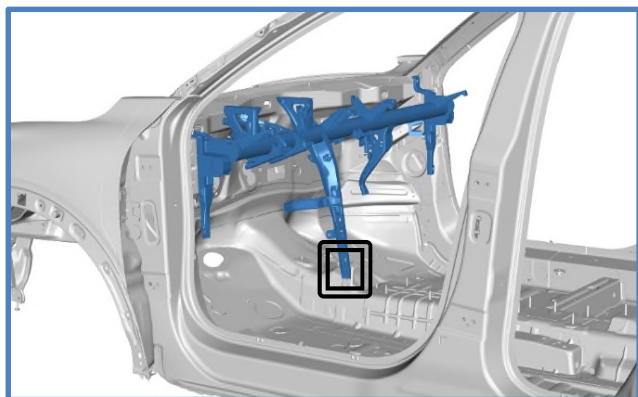

## 10. Explanation of the pictograms used



Deactivate the hands-free key



Bonnet



Flammable



Explosive



Dangerous to human health



Corrosive