

Legend

	Airbag		Airbag inflator/ stored gas inflator		Seat belt preten- sioner		SRS control unit		Battery, low-voltage
	Gas strut, preload- ed spring		High strength zone		Zone requiring special attention				
	Fuel tank content gasoline / ethanol								

This overview shows the maximum range of equipment of the vehicle.

ID No.

Version No.

Page No.

LGW-HAVAL-H6-1

01

1/4

	HAVAL H6 SUV from 2021		
--	-------------------------------------	--	--

1. Identification / recognition

Front car logos position

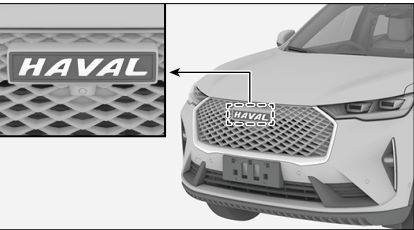

Rear car logos position

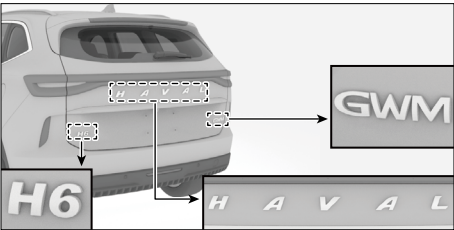



2. Immobilisation / stabilisation / lifting

Immobilize vehicle

1. Press the P button to engage the parking gear (P) .
2. Pull up the EPB switch , ensure the vehicle is stationary.
3. Shut power off .

Stabilisation-lifting points

-  Jacking points
-  Support position

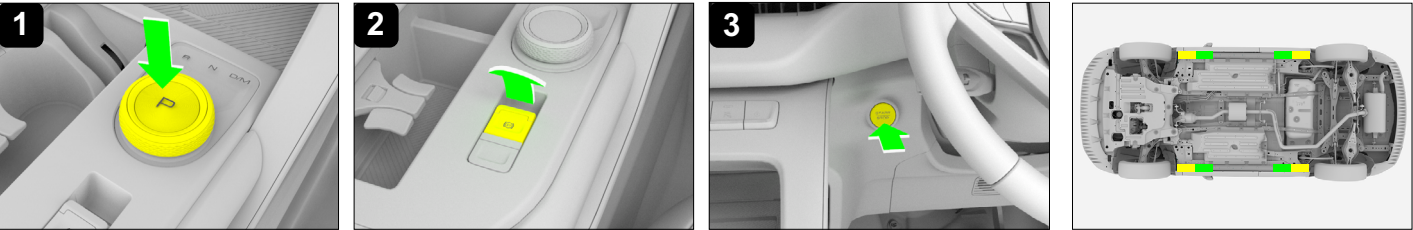

3. Disable direct hazards / safety regulations



EVEN IF THE ENGINE IS STOPPED, THE VEHICLE MAY NOT BE SHUT OFF. IF THE VEHICLE IS NOT COMPLETELY SHUT OFF, THE ENGINE MAY SUDDENLY START OR THE VEHICLE MAY START TO MOVE.

Shut power off

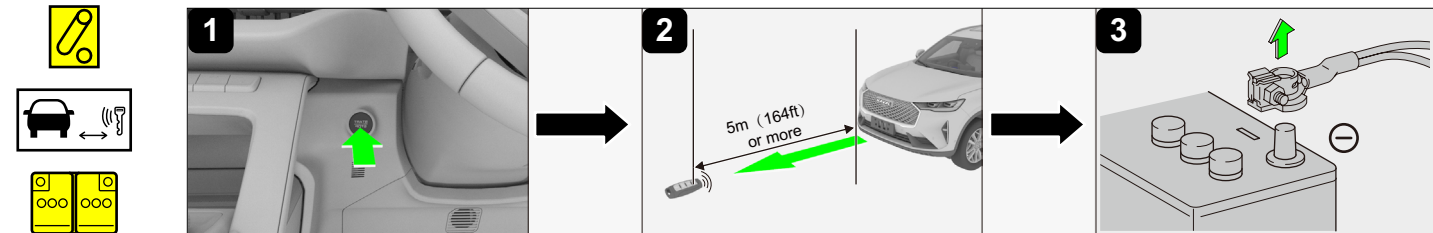

Access to 12V battery

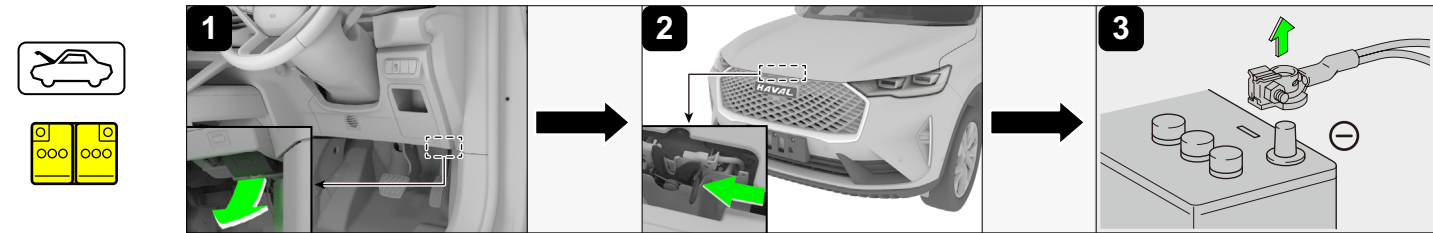

	HAVAL H6 SUV from 2021		
--	-------------------------------------	--	--

4. Access to the occupants

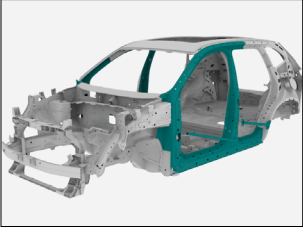
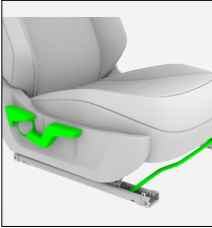
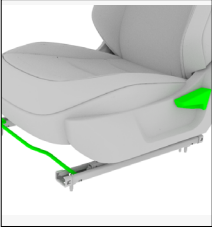
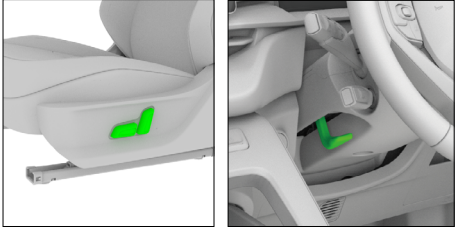
High strength steel in body	Mechanical seat adjustment	Electrical seat adjustment	Steering column adjustment
			

WHEN THE 12V BATTERY IS DISCONNECTED, ELECTRICAL COMPONENTS CANNOT BE OPERATED.

Glass types

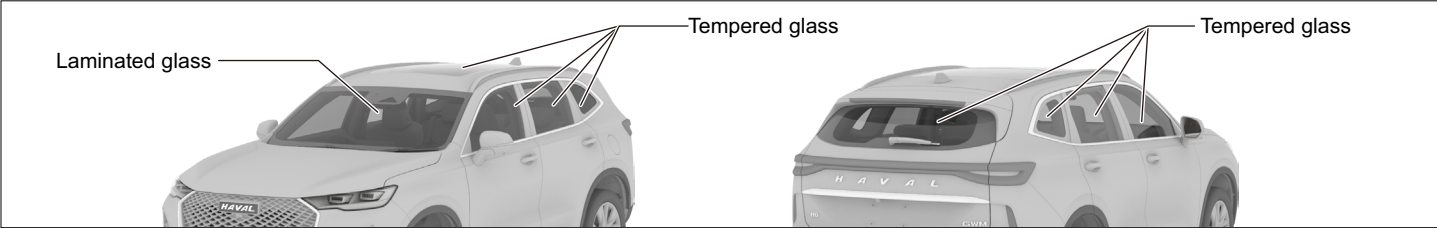

5. Stored energy / liquids / gases / solids

		12 V
		4WD : 60 ±1.8L 2WD : 61±1.8 L
		650 g

6. In case of fire

 USE LARGE AMOUNTS OF WATER	
--	--

7. In case of submersion

Proper personal protective equipment should be worn when handling any flooded vehicle. Pull the vehicle out of water as much as possible, immobilize the vehicle and disable the vehicle before starting any operation (refer to chapter 3).

TILT THE VEHICLE TO ONE SIDE TO ALLOW WATER TO DRAIN OUT OF THE VEHICLE.

This overview shows the maximum range of equipment of the vehicle.	ID No.	Version No.	Page No.
	LGW-HAVAL-H6-1	01	3/4



8. Towing / transportation / storage

Location front hook

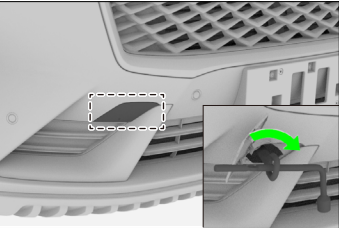

Location rear hook

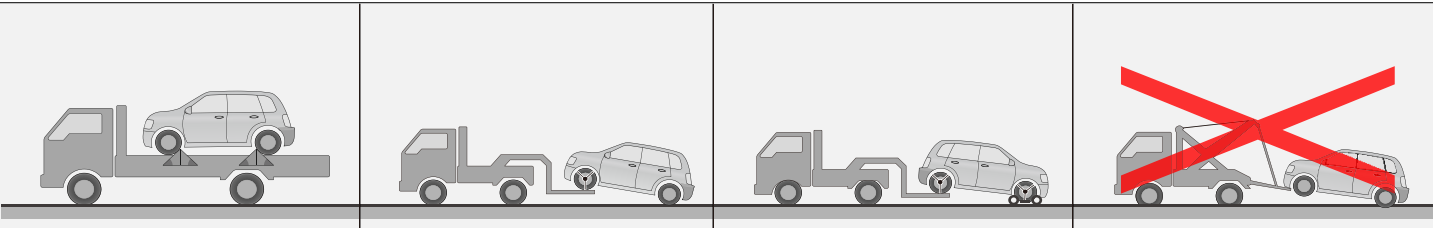
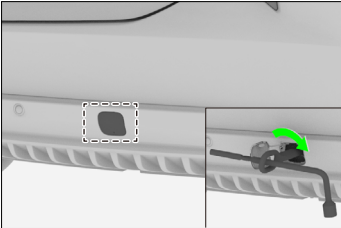

STORE AT SAFE DISTANCE FROM OTHER VEHICLES!

9. Important additional information



Driver's seat has a far side airbag in addition to the side airbag. Location of far side airbag is shown in the mark **9.** on page 1.

10. Explanation of pictograms used

Pictogram	Designation
	Device to shut down power in vehicle
	Remove smart key
	Bonnet
	General warning sign

Pictogram	Designation
	Flammable
	Explosive
	Corrosives

Pictogram	Designation
	Hazardous to the human health
	Use water to extinguish the fire
	Air-conditioning component

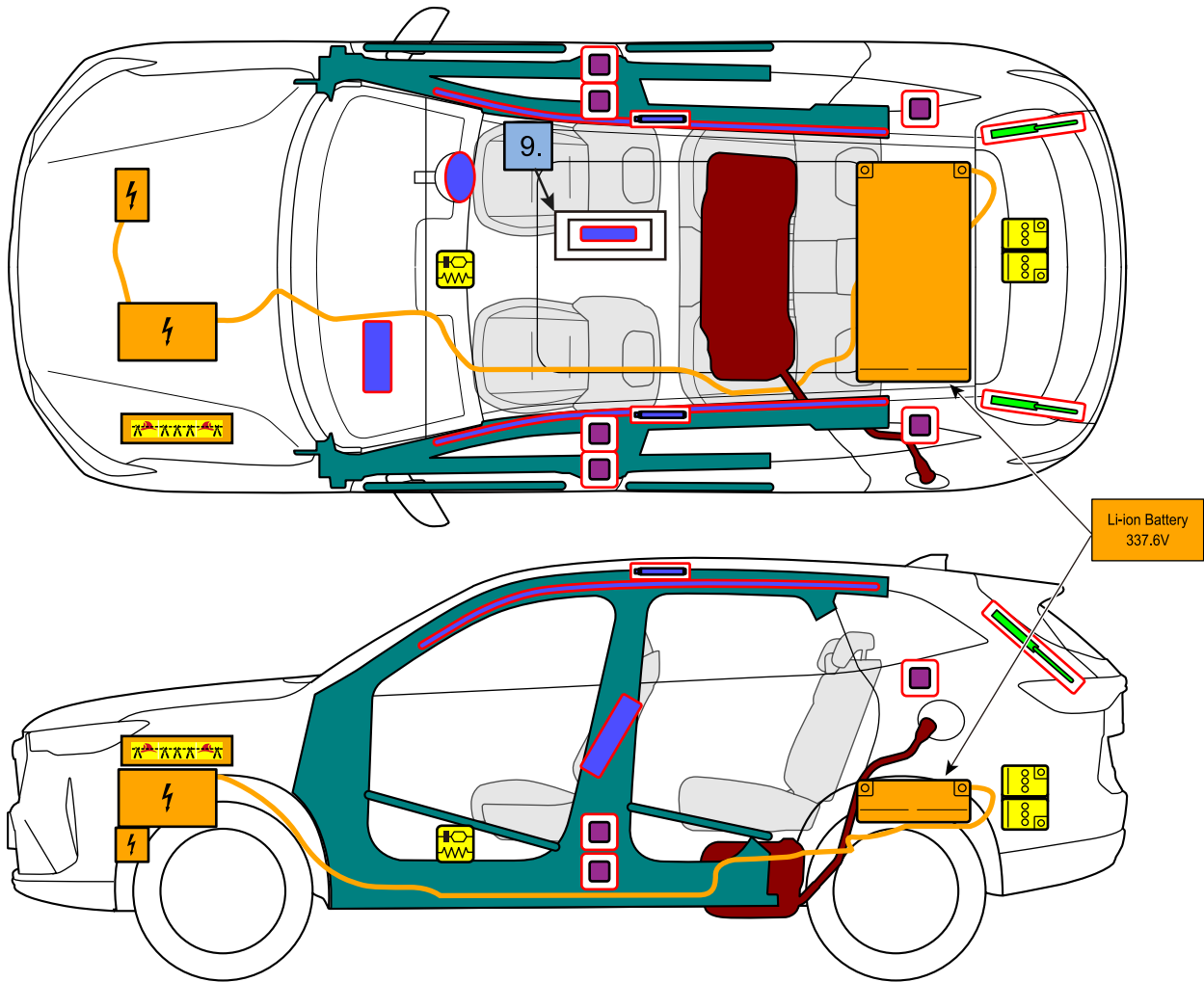

Legend							
	Airbag		Airbag inflator/ stored gas inflator		Seat belt preten- sioner		SRS control unit
	Gas strut, preloaded spring		High strength zone		Zone requiring special attention		Battery, low-voltage
	High voltage power cable		Battery pack, high- voltage		Fuel tank content gasoline / ethanol		Cable cut
	High voltage compo- nent						

This overview shows the maximum range of equipment of the vehicle.

ID No.

Version No.

Page No.

LGW-HAVAL-H6HEV-1

01

1/4



1. Identification / recognition



LACK OF ENGINE NOISE DOES NOT MEAN VEHICLE IS OFF. SILENT MOVEMENT OR INSTANT RESTART CAPABILITY EXISTS UNTIL VEHICLE IS FULLY SHUT DOWN. WEAR APPROPRIATE PPE.

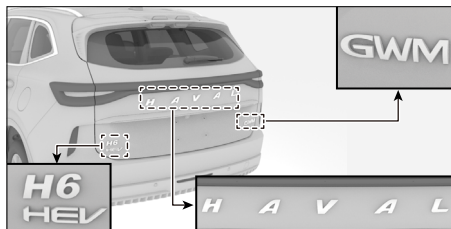
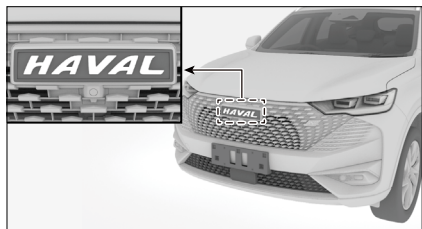

2. Immobilisation / stabilisation / lifting

Immobilize vehicle

1. Press the P button to engage the parking gear (P).
2. Pull up the EPB switch, ensure the vehicle is stationary.
3. Shut power off.

Stabilisation-lifting points

- Jacking points
- Support position

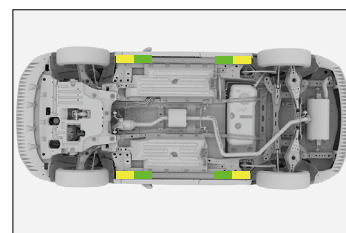
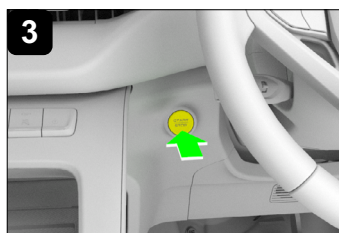
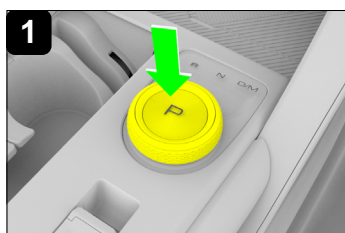

3. Disable direct hazards / safety regulations

Main disabling method

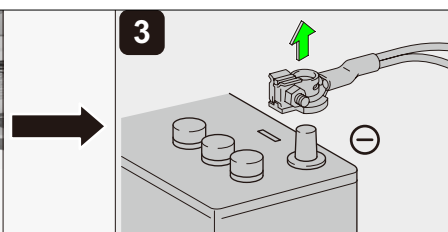
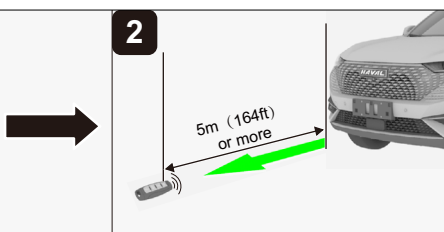
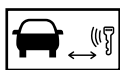

Alternative disabling method

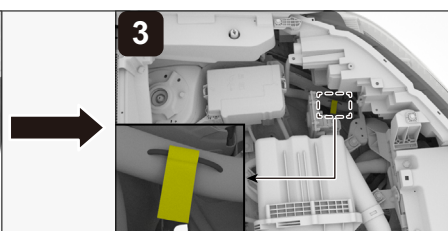
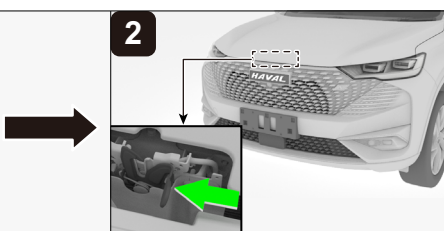

Access to 12V battery

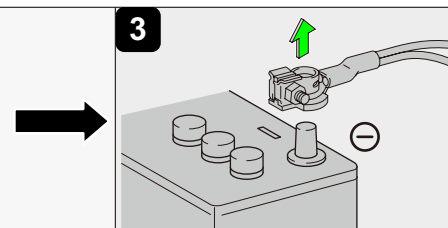
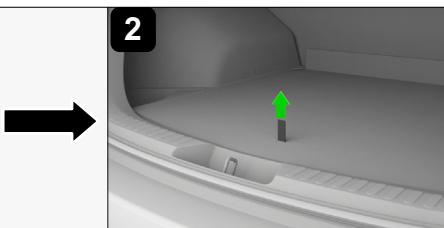
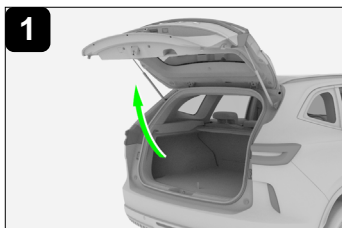

This overview shows the maximum range of equipment of the vehicle.

ID No.



Version No.

Page No.

LGW-HAVAL-H6HEV-1

01

2/4

	HAVAL H6 SUV from 2022		
--	-------------------------------------	--	--

4. Access to the occupants

High strength steel in body

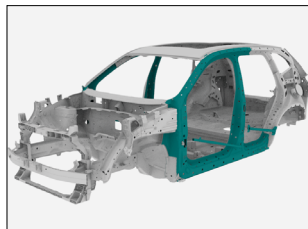

Mechanical seat adjustment

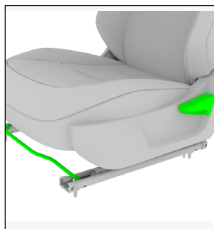
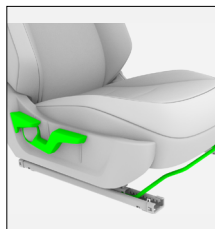

Electrical seat adjustment

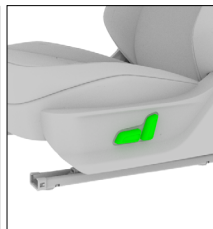
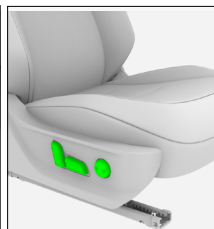

Steering column adjustment

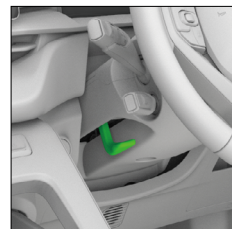





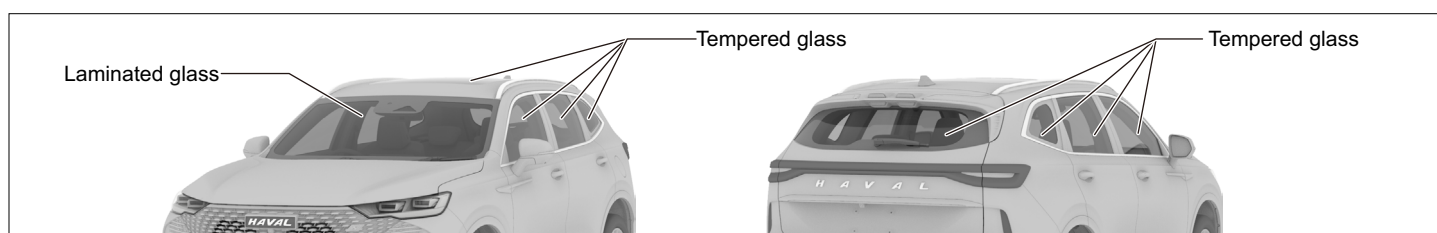



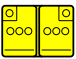







WHEN THE 12V BATTERY IS DISCONNECTED, ELECTRICAL COMPONENTS CANNOT BE OPERATED.

Glass types



5. Stored energy / liquids / gases / solids

	  	12 V
	     	337.6 V
	 	61±1.8 L
	 	650 g

6. In case of fire



USE LARGE AMOUNTS OF WATER

If it is difficult to apply copious amounts of water to the high voltage battery, it is recommended to allow the high voltage battery to burn itself out.

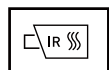

BATTERY RE-IGNITION !



DO NOT SUBMERGE VEHICLE TO EXTINGUISH BATTERY.

7. In case of submersion

Proper personal protective equipment should be worn when handling any flooded vehicle. Pull the vehicle out of water as much as possible, immobilize the vehicle and disable the vehicle before starting any operation (refer to chapter 3).

This overview shows the maximum range of equipment of the vehicle.	ID No.	Version No.	Page No.
	LGW-HAVAL-H6HEV-1	01	3/4



Tilt the vehicle to one side to allow water to drain out of the vehicle.

8. Towing / transportation / storage

Location front hook

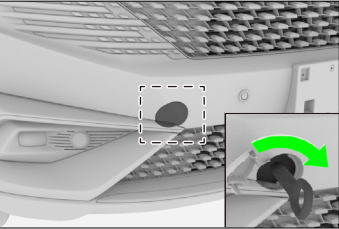

Location rear hook

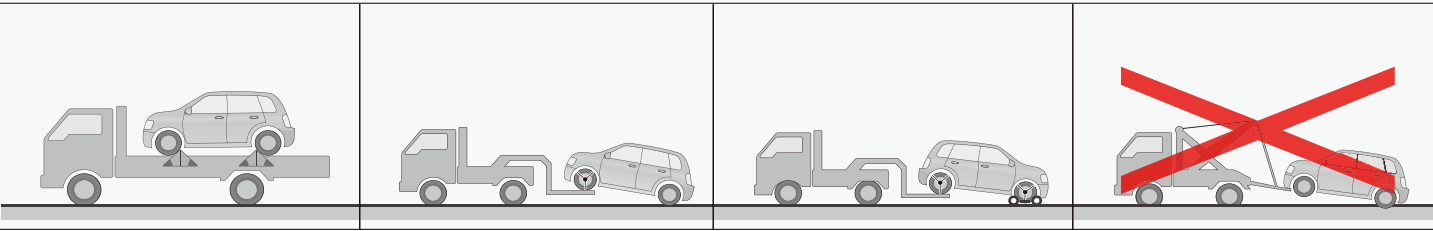
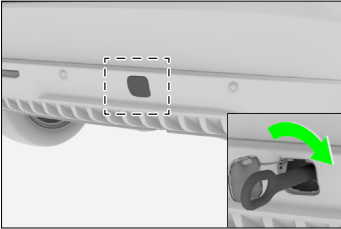

STORE AT SAFE DISTANCE FROM OTHER VEHICLES!



BATTERY RE-IGNITION !

9. Important additional information



Driver's seat has a far side airbag in addition to the side airbag. Location of far side airbag is shown in the mark on page 1.

9.

10. Explanation of pictograms used

Pictogram	Designation
	Low voltage device that disconnect high voltage
	Remove smart key
	Bonnet
	Use thermal Infrared camera
	Hybrid Electric Vehicle on fuel of liquid group 2

Pictogram	Designation
	Flammable
	Explosive
	Corrosives
	Warning, Electricity
	Air-conditioning component

Pictogram	Designation
	Hazardous to the human health
	Use water to extinguish the fire
	Boot
	General warning sign
	Acute toxicity

This overview shows the maximum range of equipment of the vehicle.

ID No.

Version No.

Page No.

LGW-HAVAL-H6HEV-1

01

4/4