



150342100  
0 SUFFOLK VA 23434

Total Assessed Value  
\$25,100

PID No.	7798
Account No.	150342100
Map No.	34B*P143
Owner	BOONE VIOLA
Situs Address	0 SUFFOLK VA 23434
Mailing Address	917 GARFIELD AVE SUFFOLK VA 23434
Legal Description	L 143,GARFIELD AVE. BOSTON PARK
Use Code	200V - Vacant Residential Land
Lots / Acres	0.090000
Effective Area	0 SqFt

	Assessed Value
Market Land Value	\$25,100
Total Imp. Value	\$0
Land Use Value	\$0
Total Assessed Value	\$25,100

SALE NO.	BOOK	PAGE	QUALIFIED/UNQUALIFIED	IMP/VACANT	INSTRUMENT NO.	SALE DATE	SALE PRICE
+ 1	0WB33	00144	U	V	-	09/15/2000	\$0
Comments		AFFIDAVIT OF HEIRS					
+ 2	00000	00000	U	V	009532	09/15/2000	\$0
Comments		AFFIDAVIT OF HEIRS					
+ 3	00351	00600	U	-	-	01/01/1972	\$0
Comments		AFFIDAVIT OF HEIRS					
+ 4	00262	00089	U	-	-	01/01/1962	\$0
Comments		AFFIDAVIT OF HEIRS					
+ 5	0WB19	00306	U	-	-	01/01/1954	\$0
Comments		AFFIDAVIT OF HEIRS					
+ 6	00168	00047	U	-	-	01/01/1949	\$0
Comments		AFFIDAVIT OF HEIRS					
+ 7	00000	00000	U	-	-	01/01/1900	\$0
Comments		AFFIDAVIT OF HEIRS					

ASSESSED VALUE HISTORY

YEAR	MARKET LAND VALUE	TOTAL IMP. VALUE	LAND USE VALUE	TOTAL ASSESSED VALUE
2023	\$25,100	\$0	\$0	\$25,100
2022	\$20,100	\$0	\$0	\$20,100
2021	\$18,200	\$0	\$0	\$18,200
2020	\$18,200	\$0	\$0	\$18,200
2018	\$18,200	\$0	\$0	\$18,200
2017	\$18,200	\$0	\$0	\$18,200
2016	\$18,200	\$0	\$0	\$18,200

LAND DETAILS

	LAND LINE #	LAND USE CODE	LAND USE DESC	ZONING	UNITS	UNIT DESC	APPRAISED VALUE
+	1	200V	Vacant Residential Land	C - Conservation	0.0900	Acres	\$35,100

Frontage	0
Depth	0
Total SqFt	3,920 SqFt
Description	-
Occupancy Type	Vacant Residential Land
Lot Type Descr.	Urban Suffolk
Exempt	0 (1=Yes, 0=No)
Note	-

BUILDING DETAILS

SUB-AREAS

No data to display

OUTBUILDINGS & EXTRA FEATURES

No data to display

PERMIT DETAILS

No data to display

DISCLAIMER

Under Virginia State law, these real estate assessment records are public information. Display of property on the Internet is specifically authorized by § 58.1-3122.2 of the Code of Virginia (1950), as amended.\*

Contact us if you believe any real estate assessment data provided is inaccurate or if you have any comments about this online search. Call us by telephone at **(757) 514-7477**. You may e-mail comments or questions to: [CityAssessor@suffolkva.us](mailto:CityAssessor@suffolkva.us)

**Pursuant to § 54.1-402.C and 18 VAC 10-20-310**

The city of Suffolk, Virginia makes no warranty, representation, or guarantee of any kind regarding either GIS produced maps, data, other information provided herein or the sources of such maps, data, or other information. The city of Suffolk specifically disclaims all representations or warranties, express or implied, including, without limitation, the implied warranties of merchantability and fitness for a particular purpose.

The city of Suffolk assumes no liability either for any errors, omissions, or inaccuracies in the information provided regardless of the cause of such or for any decision made, action taken, or action not taken by the user in reliance upon any maps or information provided herein.

Any determination of topography or contours, or any depiction of physical improvements, property lines or boundaries is for general information only and shall not be used for the design, modification, or construction of improvements to real property or for flood plain determination.

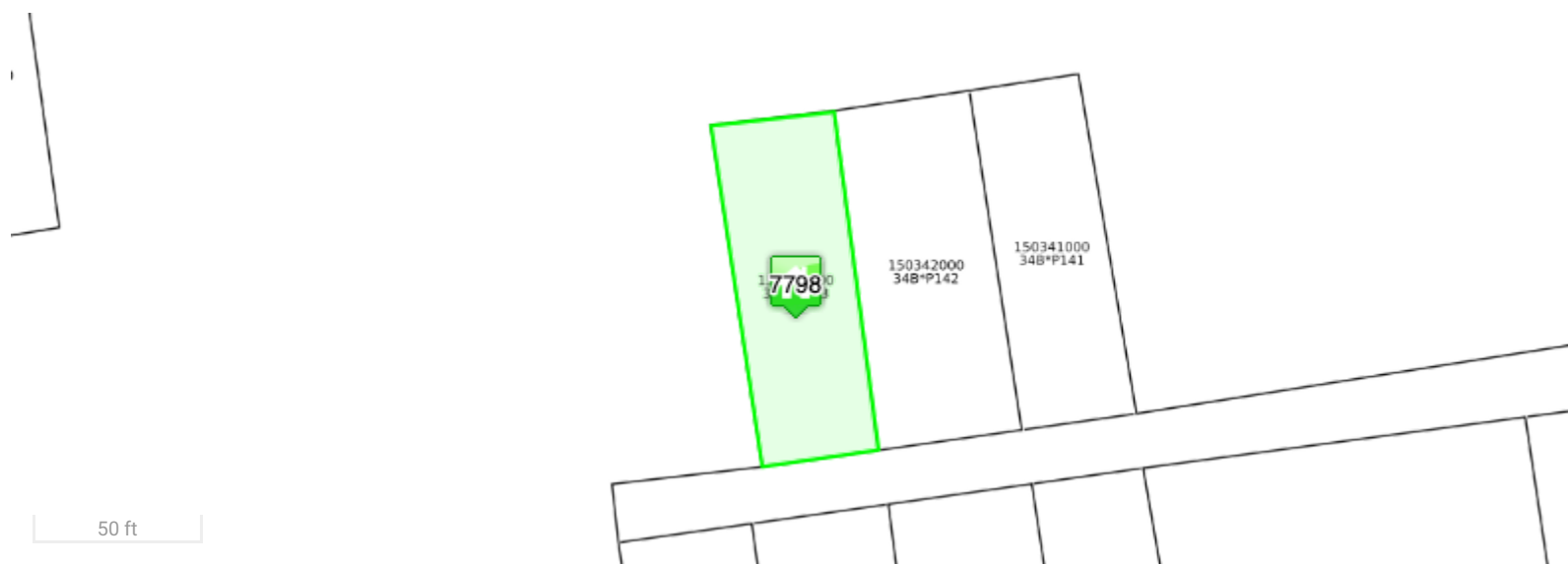

No Photo Available



Data last updated: 06/15/2023