

DURHAM PROPERTY RECORD SEARCH

118434
1111 SOUTH ST

CURRENT
MBT TRUST
530 BOB HORTON RD
APEX, NC, 27523

Total Assessed Value
\$105,114

KEY INFORMATION

Tax District	CNTY-DRHM/CITY-DRHM	PIN	0821-72-86-0971
Account	8645515	Neighborhood	R821B
Land Use Code	112	Land Use Desc	RES/ 2-FAMILY
Subdiv Code	0931	Subdiv Desc	NEW HOPE RLTY CO/RESUB PT
Deed Book & Page	008270 / 000386	Plat Book & Page:	00005A / 000088
Last Sale Date:	-	Last Sale Price:	-
Jan 1st Owner:	MBT TRUST		
Legal Description:	NEW HOPE RLTY CO RESUBD/B LK:1/LT#12		

ASSESSMENT DETAILS

Land Fair Market Value	\$62,100
Improvement Fair Market Value	\$43,014
Total Fair Market Value	\$105,114

RESIDENTIAL BUILDING (1)

Year Built:	1958	Built Use / Ranch	SEMI-DETACHED (VERT SPLIT)
Current Use	RESIDENTIAL	Percent Complete:	100%
Heated Area (S/F):	1,256	Full Bathroom(s):	2
Half Bathroom(s):	0	Bedroom(s):	4
Fireplace (Y/N):	N	Basement (Y/N):	N
Basement Unfinished:	-	Basement Finished:	-
Basement Partially Finished:	-	Attached Garage (Y/N):	N
Assessed Building Value:	\$43,014		

Assessed Total Improvement Value **\$43,014**

LAND DETAILS

Land Fair Market Value (FMV)	\$62,100	Land Assessed Value	\$62,100	Mapped Acres	0.23
------------------------------	----------	---------------------	----------	--------------	------



118434 09/05/2017

Disclaimer

Data Disclaimer: All data shown here is from other primary data sources and is public information. Users of this data are hereby notified that the aforementioned public information sources should be consulted for verification of the information contained on this website. **This site presents appraised value which may not represent taxable value.** While efforts have been made to use the most current and accurate data, Durham County, NC and Data Providers assume no legal responsibility for the use of the information contained herein.

Please direct any questions or comments about the data displayed here to tax_assessor@dcconc.gov

DURHAM PROPERTY RECORD SEARCH

118434
1111 SOUTH ST

CURRENT MBT TRUST
530 BOB HORTON RD
APEX, NC, 27523

Total Assessed Value
\$105,114

KEY INFORMATION

Tax District	CNTY-DRHM/CITY-DRHM	PIN	0821-72-86-0971
Account	8645515	Neighborhood	R821B
Land Use Code	112	Land Use Desc	RES/ 2-FAMILY
Subdiv Code	0931	Subdiv Desc	NEW HOPE RLTY CO/RESUB PT
Deed Book & Page	008270 / 000386	Plat Book & Page:	00005A / 000088
Last Sale Date:	-	Last Sale Price:	-
Jan 1st Owner:	MBT TRUST		
Legal Description:	NEW HOPE RLTY CO RESUBD/B LK:I/LT#12		
-			

ASSESSMENT DETAILS

Land Fair Market Value	\$62,100
Improvement Fair Market Value	\$43,014
Total Fair Market Value	\$105,114

RESIDENTIAL BUILDING (1)

Assessed Total Improvement Value **\$43,014**

Year Built:	1958	Built Use / Ranch	SEMI-DETACHED (VERT SPLT)
Current Use	RESIDENTIAL	Percent Complete:	100%
Heated Area (S/F):	1,256	Full Bathroom(s):	2
Half Bathroom(s):	0	Bedroom(s):	4
Fireplace (Y/N):	N	Basement (Y/N):	N
Basement Unfinished:	-	Basement Finished:	-
Basement Partially Finished:	-	Attached Garage (Y/N):	N
Assessed Building Value:	\$43,014		

LAND DETAILS

Land Fair Market Value (FMV)	Land Assessed Value	Mapped Acres
\$62,100	\$62,100	0.23



118434 09/05/2017



Parcels

Map Tips

1 Results

Zoom	Buffer	Find Adjainers	Report	Tax Info	PARCEL_ID	PIN	FRONT_DIM	POLY_ACRE	SUM_A
1311	1312				118434	0821-72-86-0971			0.23

40m Adjainers
200ft

SUBDIVISION PLAT OF PROPERTY OF
 NEW HOPE REALTY CO.
 DURHAM N.C.
 SCALE 1" = 150'
 MAY 1918
 RECORDED IN PLAT BOOK NO. 100
 ENGINEERS, CHARLOTTE, N.C.

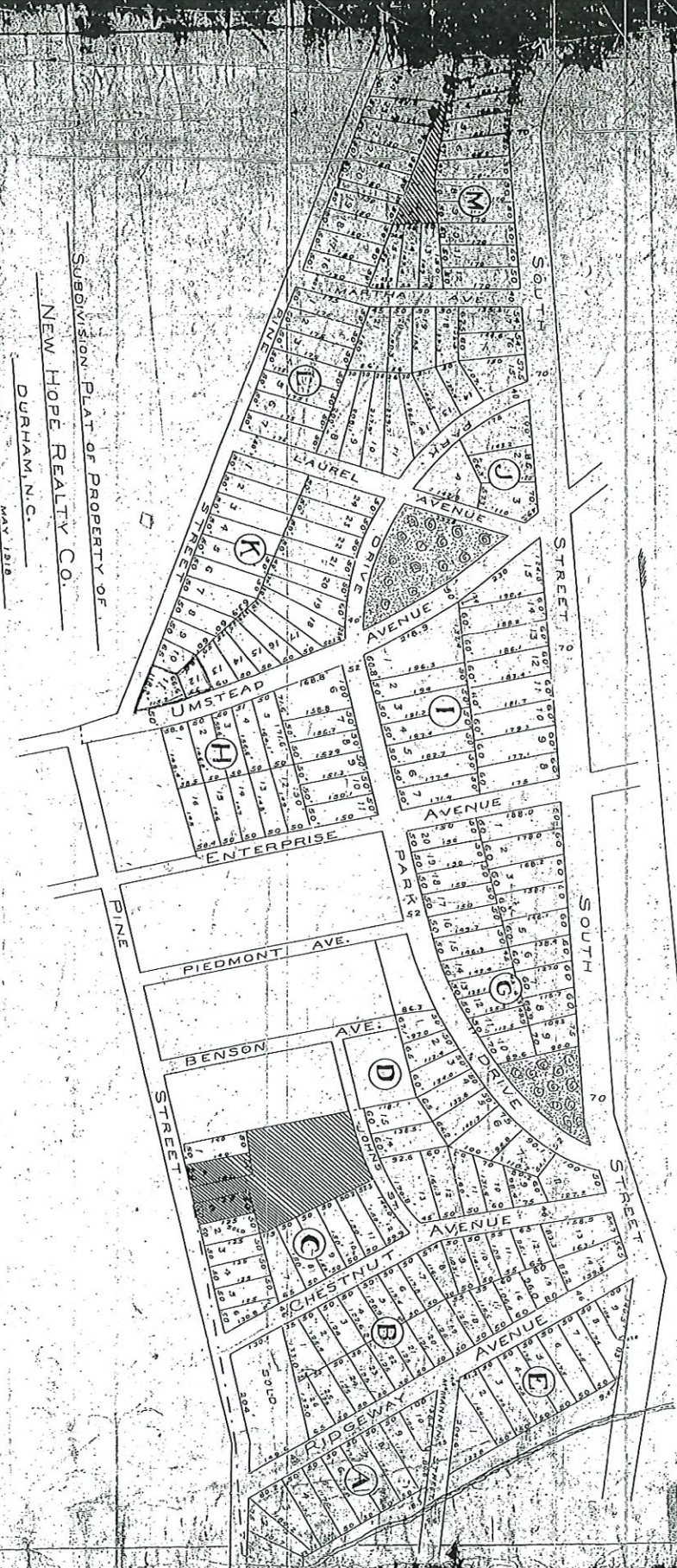

*See map provided in file
 10/26/18 3-1/2*

88



5 A
 PG
 88



Parcels

Map Tips

W Piedmont Ave

W Enterprise St

Fargo St

South St

E Umstead

W Umstead St

Lodge St

Scout Dr

Bond St

1 Results

Zoom Buffer Find Report Tax Info

Zoom Buffer Find Report Tax Info

PARCEL_ID	PIN	FRONT_DIM	POLY_ACRE	SUM_A
118434	0821-72-86-0971			0.23

40m Adjoiners 200ft

⚙️ 203
🔍
🔍
👤
←
→
Parcels
⌵
🕒
🗨️
Map Tips
🗑️



▼ 1 Results

🔍
✳️
🕒
🗨️

Zoom	Buffer	Find Adjoiners	Report	Tax Info	PARCEL_ID	PIN	FRONT_DIM	POLY_ACRE	SUM_A
					118433	0821-72-87-1478			0.242

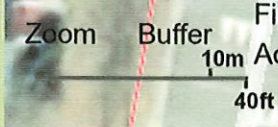

This is a generated Tax Bill, Not the Original! - For Display Purposes only

County of Durham
Office of the Tax Administrator
PO Box 3397
Durham NC 27702-3397

Durham County Property Tax Notice

201 East Main Street
Administration Building II, Third Floor
Durham, NC 27701

Office Hours: Monday-Friday 8:30am - 5:00pm
Tax Department: 919 560 - 0300
Solid Waste: 919 560 - 0430
Fax: 919 560 - 0350

Website Address: www.dconc.gov

Durham County E-Services

Electric Check: www.dconc.gov/tax - go to on-line payments

MBT TRUST
530 BOB HORTON RD
APEX, NC 27523

Year	Past Due After	Account Number	Bill Number
2022	01-05-2023	8645515	7962323



Rec #	Description	Parcel ID	Value	District	Amount Assessed
9063816	1111 SOUTH ST	118434	\$105,114	001	\$1,345.35

Year	Past Due After	Account Number	Bill Number	Balance Due
2022	01-05-2023	8645515	7962323	\$1,345.35

Exhibit 1

Property 21

Description:

All of that certain piece, parcel or tract of land situated in Durham County, North Carolina, and more particularly described as follows:

BEGINNING at a stake on the east side of South Street, said stake being in the south line of Lot 11 in Block I on plat hereinafter referred to; and running thence with the south line of said Lot 11, South 83° 35' 53" East 179.51 feet to a stake the southeast corner of said Lot 11; thence South 10° 28' 42" West 59.75 feet to a stake, the northeast corner of Lot 13 in said Block I; thence with the north line of said Lot 13, North 83° 35' 53" West 182.64 feet to a stake on the eastside of South Street, thence along and with the east side of said South Street North 13° 27' 31" East 60.05 feet to a stake, the point and place of BEGINNING, and being the greater part of Lot 12 in Block I of the New Hope Realty Company Property, as per plat and survey thereof now on file in the Office of the Register of Deeds of Durham County in Plat Book 5 at page 88, to which plat reference is hereby made for a more particular description of same, and also being that same property shown on survey for Thomas E. Tilley and wife, Iris M. Tilley dated April 13, 1985, by William Jerry Autry, Registered Land Surveyor, to which plat reference is also made for a more particular description of same.

The subject real property has street address of 1111 South Street, Durham North Carolina, and bears Tract No. 118434.

The property being the same property described in the Quitclaim Deed dated September 15, 2017, and recorded September 15, 2017, at Book 8270, Pages 386 through 389.

Commonly known as: 1111 South Street, Durham, North Carolina
County: Durham
Parcel ID No(s): 118434
Titled to: MBT Trust
Transfer(s): TT Farms Trust to MBT Trust on September 15, 2017, deed recorded September 15, 2017, at Book 8270, Pages 386-389.
Nominee notice(s) of lien: August 22, 2018, 18M895 (MBT Trust)
August 22, 2018, 18M897 (TT Farms Trust)

For Registration Sharon A. Davis
Register of Deeds
Durham County, NC
Electronically Recorded
2017 Sep 15 01:48 PM NC Rev Stamp: \$ 0.00
Book: 8270 Page: 386 Fee: \$ 26.00
Instrument Number: 2017032645
DEED

Submitted electronically by Henderson and Wall, PLLC in compliance with North Carolina statutes governing recordable documents and the terms of the submitter agreement with the Durham County Register of Deeds.

This instrument should be mailed to the preparer: Trinity M. Henderson, Attorney
Henderson Law
132 Partlo Street
Garner, NC 27529

No title Certification
No tax advice

Excise Tax: \$0.00

Brief Index Description:

2922 Rutgers Place,
2926 Rutgers Place,
5701 Crescent Drive,
1111 South Street,
603 Barton Street, &
601 Barton Street,
Durham, NC

PIN(s):
141650,
141649,
141647,
118434,
116408, &
116407

NORTH CAROLINA QUITCLAIM DEED

THIS QUITCLAIM DEED is made September 15, 2017 by and between:

Bruce Tilley, Executive Trustee of TT Farms Trust

(hereinafter referred to in the neuter singular as "the Grantor") and

MBT Trust

530 Bob Horton Road
Apex, NC 27523

(hereinafter referred to in the neuter singular as "the Grantee") :

WITNESSETH, that the Grantor, for a valuable consideration paid by the Grantee, the receipt of which is hereby acknowledged, has and by these presents does hereby give, grant, bargain, sell and convey unto the Grantee, its heirs, successors, administrators and assigns, any interest it may have in all of that certain piece, parcel or tract of land situated in Durham County, North Carolina, and more particularly described as follows:

SEE ATTACHED EXHIBIT "A" FOR LEGAL DESCRIPTION

The property herein described was acquired by the Grantor by deed recorded in Book 6423 at Page 507.

TO HAVE AND TO HOLD the aforesaid lot or parcel of land and all privileges and appurtenances thereto belonging free and discharged from all right, title, claim or interest of the Grantor or anyone claiming by, through or under Grantor.

THE undersigned hereby certifies that, per an Appointment of Executive Trustee dated January 30, 2017, the previously-acting Trustees of the TT Farms Trust, Melba George and Barbara Wright, have been removed from their positions as Trustees. He furthermore certifies that, per the same Appointment, he is the sole Executive Trustee of the TT Farms Trust and that he possesses the authority to sign any and all documents on behalf of the trust and other current Trustees, Iris Tilley and Thomas E. Tilley.

IN WITNESS WHEREOF, the undersigned has executed this instrument on behalf TT Farms Trust on the date set forth below in the acknowledgment hereof.

Bruce Tilley, Executive Trustee of TT Farms Trust

By: Bruce Tilley, Trustee

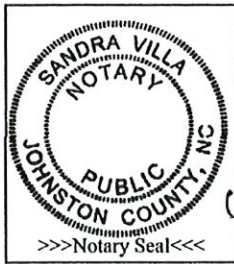

State of NC, WAKE County
I, the undersigned, a Notary Public for the County and State aforesaid, do hereby certify that Bruce Tilley, Executive Trustee of TT Farms Trust, personally appeared before me this day and acknowledged the due execution of the foregoing instrument on behalf of the said Trust. Witness my hand and notarial seal, this the 15 day of SEPTEMBER, 2017.

Sandra Villa
Notary Public

My commission expires 04/20/21

Exhibit A

Legal Description

Tract One

The greater parts of Lots 50 through 55 inclusive and 59 in Block A of Woodland acres as per plat and survey in Plat Book 31 at Page 61, Durham County Registry, and being more particular described as BEGINNING at a stake on the west side of Farrington Road, said stake being a corner of Lot 60 on plat herein above referred to, and running thence along and with the west side of Farrington Road South $12^{\circ} 10' 58''$ East 137.03 feet to a stake; thence continuing with the west side of Farrington Road in a general southerly direction along a curve having a radius of 3,130 feet, a distance of 201.84 feet to a stake; thence South $7^{\circ} 53'$ West 82.54 feet to a stake on the north side of Forest Drive; thence with the north side of Forest Drive North $84^{\circ} 40' 30''$ West 200.53 feet to a stake on the east side of Crescent Drive; thence with the east side of Crescent Drive in a general northerly direction along a curve having a radius of 1,330 feet, a distance of 251.72 feet to a stake; thence North $34^{\circ} 34' 13''$ East 289.6 feet to a stake; thence South $41^{\circ} 24' 4''$ East 104.56 feet to a stake, the point and place of BEGINNING, containing 2.209 acres, more or less, and being shown as Property of Thomas E. Tilley and wife, Iris M. Tilley on survey by Autry Land Surveying dated November 24, 1986, to which plat reference is hereby made for a more particular description of same.

2922 Rutgers Place; Lots 55 and part of Lot 54 (Parcel ID 141650)
 2926 Rutgers Place; Lots 52 & 53 (Parcel ID 141649)
 5701 Crescent Drive; Lots 50 & 51 (Parcel ID 141647)

Tract Two

BEGINNING at a stake on the east side of South Street, said stake being in the south line of Lot 11 in Block I on plat hereinafter referred to; and running thence with the south line of said Lot 11, South $83^{\circ} 35' 53''$ East 179.51 feet to a stake, the southeast corner of said Lot 11; thence South $10^{\circ} 28' 42''$ West 59.75 feet to a stake, the northeast corner of Lot 13 in said Block I; thence with the north line of said Lot 13, North $83^{\circ} 35' 53''$ West 182.64 feet to a stake on the east side of South Street; thence along and with the east side of said South Street North $13^{\circ} 27' 31''$ East 60.05 feet to a stake, the point and place of BEGINNING, and being the greater part of Lot 12 in Block I of the New Hope Realty Company Property, as per plat and survey thereof now on file in the Office of the Register of Deeds of Durham County in Plat Book 5 at page 88, to which plat reference is hereby made for a more particular description of same, and also being that same property shown on survey for Thomas E. Tilley and wife, Iris M. Tilley dated April 13, 1985, by William Jerry Autry, Registered Land Surveyor, to which plat reference is also made for a more particular description of same.

The subject real property as street address of 1111 South Street in Durham, North Carolina and bears Tract No. 118434

Tract Three

Being all of Lot 10 in Block C of Homeland Heights as per plat and survey thereof now on file in the Office of the Register of Deeds of Durham County in Plat Book 12 at Page 85, to which plat reference is hereby made for a more particular description of same.

The subject real property as street addresses of 603 Barton Street in Durham, North Carolina and bears Tract No. 116408.

Tract Four

Being all of Lot 9 in Block C of Home Homeland Heights as per plat and survey thereof now on file in the Office of the Register of Deeds of Durham County in Plat Book 12 at Page 85, to which plat reference is hereby made for a more particular description of same.

The subject real property as street addresses of 601 Barton Street in Durham, North Carolina and bears Tract No. 116407.