



Parcel Number: 0761001000010
Property Address (Primary): POCATY RD
 CHESAPEAKE , 23322
Parcel Class: 2000
Parcel Class Description: RESIDENTIAL - VACANT

Summary

Property Owner	FLAGSHIP HOMES INC
Owner Address Address	1136 EPPINGTON DR VIRGINIA BEACH , VA 23454-5810
Zoning	A1: Agricultural
Acreage	3.032
Legal Description	1 AMENDED BLACKWATER FOREST SEC ONE 3.032 AC

Site Information

Neighborhood Number	BR051
Neighborhood Description	BLACKWATER FOREST, KING JAMES COLONY
Borough:	BUTTS ROAD
Building Name	BLACKWATER FOREST
Frontage Length	178.09
Other Dimensions	X679.81X210.46X785.17
Land Use Participant	No

Assessment Information

Date	Fiscal Year	Land Value	Land Use Value	Improvement Value	Total Value
7/1/2023 Proposed	2024	\$25,800			\$25,800
7/1/2022	2023	\$25,800			\$25,800
7/1/2021	2022	\$22,700			\$22,700
7/1/2020	2021	\$3,000			\$3,000
7/1/2019	2020	\$2,700			\$2,700
7/1/2018	2019	\$2,700			\$2,700
7/1/2017	2018	\$2,700			\$2,700
7/1/2016	2017	\$2,700			\$2,700
7/1/2015	2016	\$2,700			\$2,700
7/1/2014	2015	\$2,700			\$2,700
7/1/2013	2014	\$2,700			\$2,700
7/1/2012	2013	\$2,700			\$2,700
7/1/2011	2012	\$3,000			\$3,000
7/1/2010	2011	\$3,300			\$3,300
7/1/2009	2010	\$3,800			\$3,800
7/1/2008	2009	\$3,800			\$3,800
7/1/2007	2008	\$3,800			\$3,800
7/1/2006	2007	\$3,800			\$3,800
7/1/2005	2006	\$3,800			\$3,800

Ownership Information

Buyer Name	Seller Name	Sale Date	Sale Amount	Deed Book	Deed Page	Map Book/Page
FLAGSHIP HOMES INC	PUGHSVILLE BUILDING CORP	3/28/1997	\$5,000	3475	44	01060054
PUGHSVILLE BUILDING CORP	DOMINION LAND INVESTMENT GROUP	1/3/1997	\$3,000	3443	616	01060054
DOMINION LAND INVESTMENT GROUP	J & M EXCAVATION & CLEARING INC	11/9/1988	\$35,000	2440	309	01060054

DISCLAIMER: This data is provided without warranty of any kind, either expressed or implied, including but not limited to, the implied warranties of merchantability and fitness for a particular purpose. Any person, firm or corporation which uses this map or any of the enclosed information assumes all risk for the inaccuracy thereof, as City of Chesapeake expressly disclaims any liability for loss or damage arising from the use of said information by any third party.

J & M EXCAVATION & CLEARING INC	DOMINION LAND INVESTMENT GROUP	2/9/1988	\$38,500	2367	643	00890082
DOMINION LAND INVESTMENT GROUP		8/14/1985	\$	2126	372	00890082

Segments Information

Outbuilding Information

Building Description	Year Built	Square Feet
----------------------	------------	-------------

Real Estate Tax

Current Year	Bill Number	Year	Installment	Date Due	Tax Billed	Tax Paid	Balance Due
2023	86674	2023	INSTALLMENT #1	8/31/2022	\$28.56	\$0.00	
2023	25061	2023	INSTALLMENT #1	9/30/2022	\$65.15	\$0.00	
2023	87668	2023	INSTALLMENT #2	12/31/2022	\$100.00	\$0.00	
2023	87669	2023	INSTALLMENT #2	12/31/2022	\$17.00	\$0.00	
2023	25061	2023	INSTALLMENT #2	1/3/2023	\$65.15	\$0.00	
2023	88608	2023	INSTALLMENT #3	2/28/2023	\$6.80	\$0.00	
2023	88610	2023	INSTALLMENT #3	2/28/2023	\$30.00	\$0.00	
2023	88611	2023	INSTALLMENT #3	2/28/2023	\$2.93	\$0.00	
2023	88609	2023	INSTALLMENT #3	2/28/2023	\$31.00	\$0.00	
2023	25061	2023	INSTALLMENT #3	3/31/2023	\$65.15	\$0.00	
2023	88748	2023	INSTALLMENT #3	4/30/2023	\$12.00	\$0.00	
2023	25061	2023	INSTALLMENT #4	6/5/2023	\$65.15	\$0.00	

Please contact the Treasurer's Office at (757) 382-6281 if you have questions regarding Tax Paid or Balance Due. Storm Water Fees and prior balances do not show on this tab.

Real Estate Notes

Note
1-LEGAL CHG 93-94 7/93 PH.
2-AIR RIGHTS SOLD PER ROB KINSER
3 - DB10630 PG1058 LIS PENDENS RECRD'D 1-10-2023, CASE #CL23-139-00; SJG

City of Chesapeake, Virginia

Legend

- Address Points
- Parcels
- City Boundary

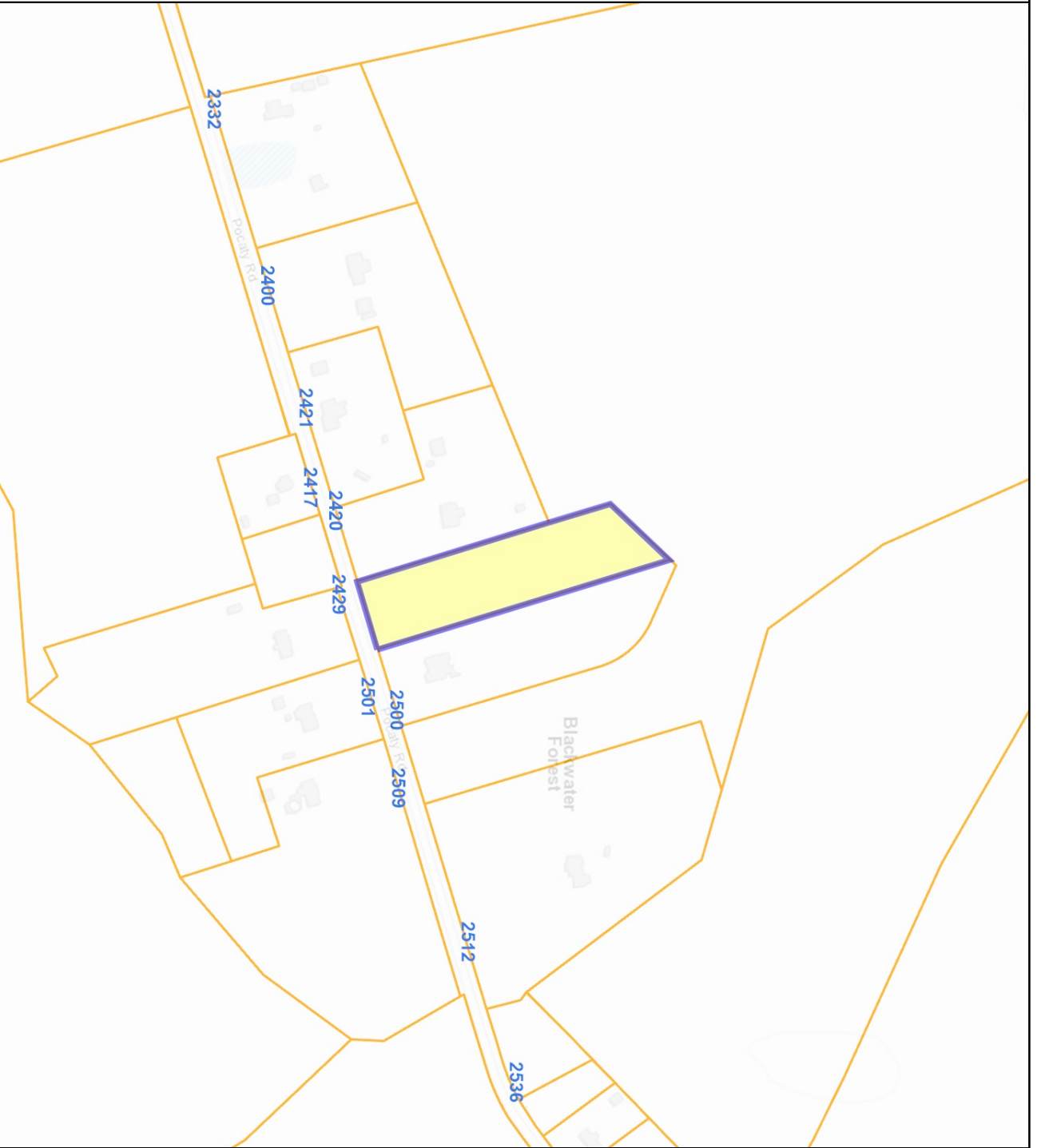

Parcel Number: 0761001000010

Date: 4/13/2023

DISCLAIMER: This drawing is neither a legally recorded map nor a survey and is not intended to be used as such. The information displayed is a compilation of records, information, and data obtained from various sources, and City of Chesapeake is not responsible for its accuracy or how current it may be.