

138.37^{+/-} Acres | **Lancaster County,
Nebraska**

Offered as a Whole Unit



"Dedicated to the Success of Our Clients"

MELISSA PIERCE

Listing Agent

Mobile (402) 366-4238

Travis Dougherty - Broker

Office (402) 336-4444

Website: www.LandMarketers.com

Land Management • Live Auctions • On line Auctions • Sales and Tax Deferred Exchanges
in Nebraska, Iowa & South Dakota



138.37^{+/-} Acres | Lancaster County, Nebraska

Offered as a Whole Unit

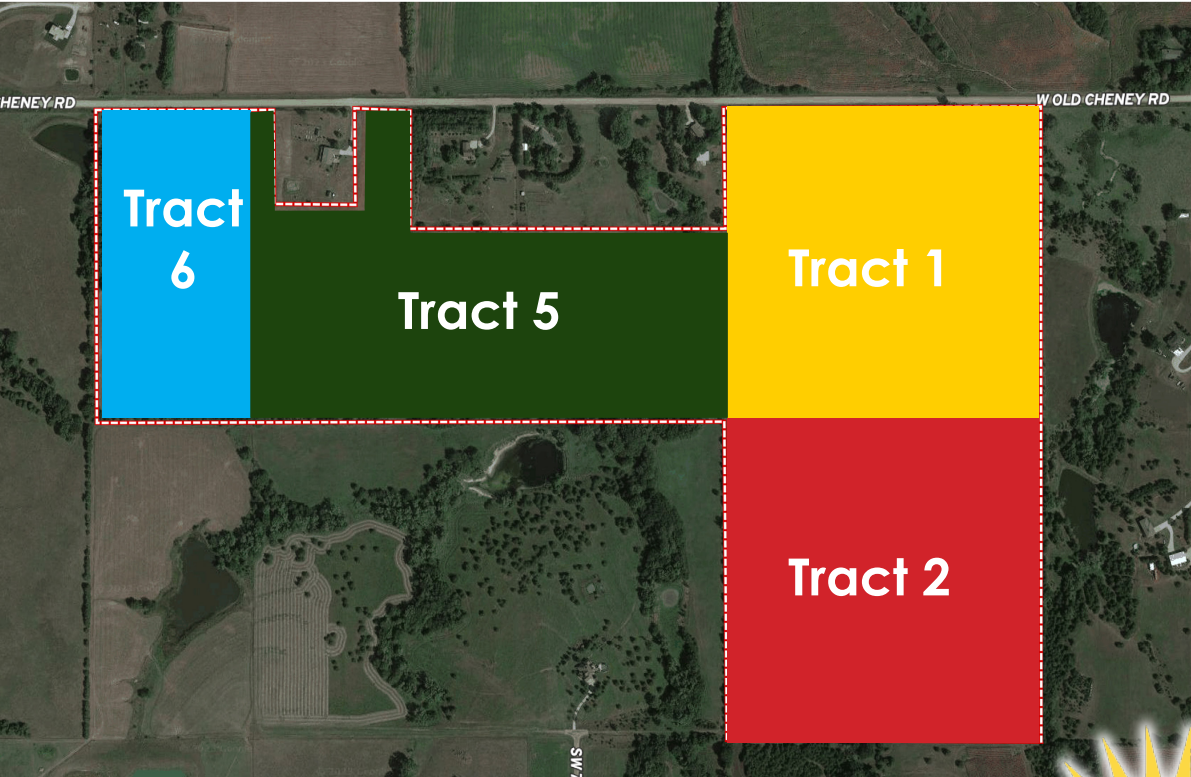

Location:

1 mile North of Denton, NE on 55A then 1 ½ miles East on Old Cheney Road.

School District:

Crete Public School K-12

Zoned:

Agricultural

Total

Listing Price

\$1,661,000

Tract 1 - 39.17^{+/-} Acres

Taxes- \$5,049.77 (2021)

Improvements:

Home Built 1930 - 952 sq. ft.

2 bathrooms / 2 bedrooms

Pole Shed 50' x 80' (Partial Concrete Floor)

Detached Garage

Livestock Barn

Tract 2 - 39.17^{+/-} Acres

Taxes - \$2,141.31 (2021)

Legal Description - Available Upon Request

*Note There are two dams on Tract 2.



Tract 5 - 40.69^{+/-} Acres

Taxes - \$2,451.9 (2021)

Legal Description - Available Upon Request

Tract 6 - 19.34^{+/-} Acres

Taxes - \$954.56 (2021)

Legal Description - Available Upon Request

Land Marketers Realty has obtained this information from sources we have deemed reliable. All boundary lines contained in any advertising are for visual aid only and do not represent the location of any existing fence lines. Land Marketers Realty makes no guarantees, warranty or representation about the accuracy of this information. This information is submitted subject to the possibility of errors, omissions, price changes, or any other conditions. All prospective buyers are urged to consult with their own tax and legal counsel and conduct their own investigation of the property or transaction. Copyright © 2023 Land Marketers Realty. All rights reserved. No part of this publication may be reproduced, distributed, or transmitted in any form or by any means, including photocopying, recording, or other electronic or mechanical methods, without the prior written permission of Land Marketers Realty.



Seller: Connie Graves

Call Today for More Information or to Schedule a Showing!!!
MELISSA PIERCE, Listing Agent • Mobile (402) 366-4238

Here is an opportunity to own a piece of Country Paradise in Lancaster County, Nebraska.

This farm is located only a few miles from Denton, NE and only a few minutes from Lincoln. If you are ready to make the move to the quiet country lifestyle but still close to town, now is your chance!! These lots would be perfect for that New Home or Shop you have been dreaming of.

Now is the time to "Make a Move". Call Today to set up a personal tour!!



Melissa Pierce

Listing Agent

Mobile (402) 366-4238



www.LandMarketers.com