

Soils Map

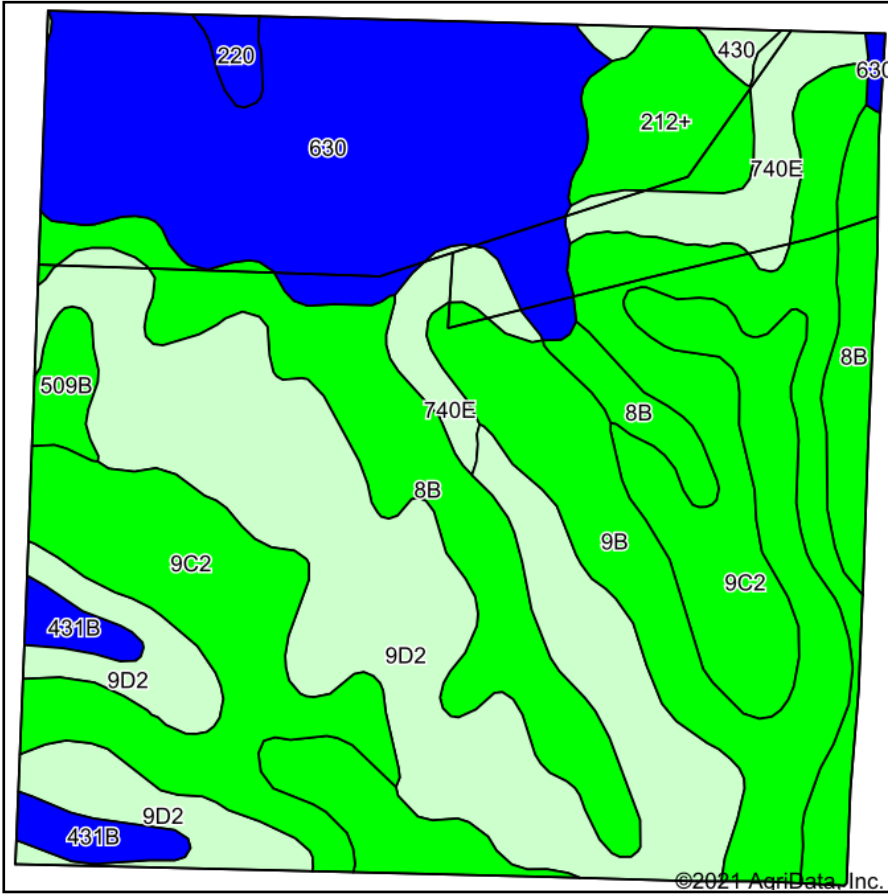

Soils data provided by USDA and NRCS.

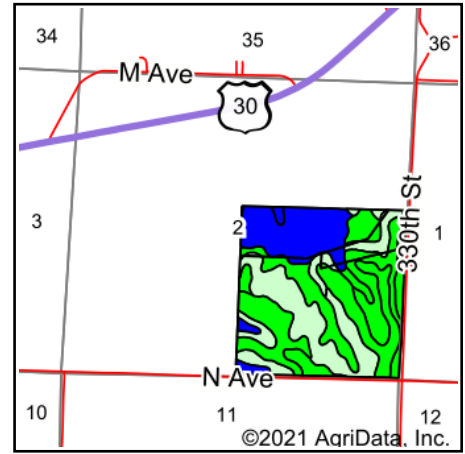

State: **Iowa**
 County: **Crawford**
 Location: **2-83N-38W**
 Township: **East Boyer**
 Acres: **153.07**
 Date: **8/27/2021**



Area Symbol: IA047, Soil Area Version: 34

Code	Soil Description	Acres	Percent of field	CSR2 Legend	Non-Irr Class *c	CSR2**	CSR
9D2	Marshall silty clay loam, 9 to 14 percent slopes, eroded	36.25	23.7%		IIIe	61	54
9C2	Marshall silty clay loam, 5 to 9 percent slopes, eroded	31.19	20.4%		IIIe	87	64
630	Danbury silt loam, 0 to 2 percent slopes, occasionally flooded	28.24	18.4%		IIw	83	85
9B	Marshall silty clay loam, 2 to 5 percent slopes	20.04	13.1%		Ile	95	81
8B	Judson silty clay loam, deep loess, 2 to 5 percent slopes	18.86	12.3%		Ile	92	81
740E	Hawick gravelly sandy loam, 14 to 18 percent slopes	7.34	4.8%		VIIs	11	5
212+	Kennebec silt loam, 0 to 2 percent slopes, occasionally flooded, overwash	5.16	3.4%		Iw	91	90
431B	Judson-Ackmore-Colo, overwash complex, 1 to 5 percent slopes	2.63	1.7%		Ile	81	66
509B	Marshall silty clay loam, terrace, 2 to 5 percent slopes	1.61	1.1%		Ile	94	76
220	Nodaway silt loam, 0 to 2 percent slopes, occasionally flooded	0.90	0.6%		IIw	82	86
430	Ackmore silt loam, 0 to 2 percent slopes, occasionally flooded	0.85	0.6%		IIw	77	86
Weighted Average						78.1	68.3

**IA has updated the CSR values for each county to CSR2.
 *c: Using Capabilities Class Dominant Condition Aggregation Method
 Soils data provided by USDA and NRCS.

PARCEL # 2 - SOIL MAP