

# Soils Map

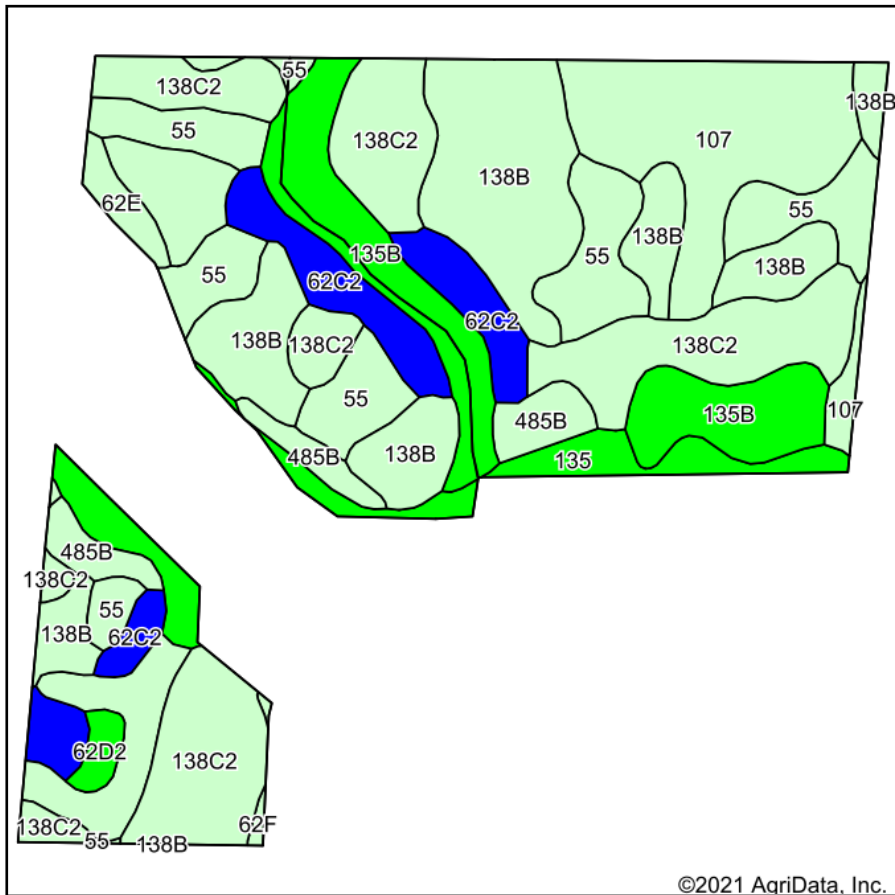

Soils data provided by USDA and NRCS.

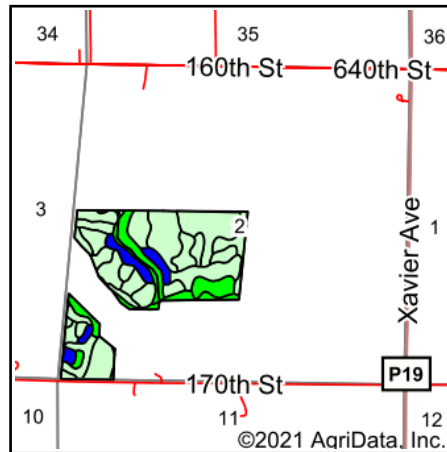

State: **Iowa**  
 County: **Calhoun**  
 Location: **2-89N-31W**  
 Township: **Lincoln**  
 Acres: **92.53**  
 Date: **1/25/2021**

*Green Real Estate & Auction Co.*  
 SAC CITY, IA 712-662-4442  
[greenrealestate-auction.com](http://greenrealestate-auction.com)

Maps Provided By:  
  
 CUSTOMIZED ONLINE MAPPING  
 © AgriData, Inc. 2021 [www.AgriDataInc.com](http://www.AgriDataInc.com)

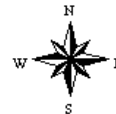

Code	Soil Description	Acres	Percent of field	CSR2 Legend	Non-Irr Class *c	CSR2**	CSR
138C2	Clarion loam, 6 to 10 percent slopes, moderately eroded	20.81	22.5%		IIIe	83	63
138B	Clarion loam, 2 to 6 percent slopes	18.11	19.6%		Ile	89	80
107	Webster clay loam, 0 to 2 percent slopes	13.92	15.0%		IIw	86	83
55	Nicollet clay loam, 1 to 3 percent slopes	12.13	13.1%		Iw	89	88
135B	Coland clay loam, 2 to 4 percent slopes	9.81	10.6%		IIw	69	73
62C2	Storden loam, 6 to 10 percent slopes, moderately eroded	7.08	7.7%		IIIe	64	51
135	Coland clay loam, 0 to 2 percent slopes, occasionally flooded	5.24	5.7%		IIw	76	78
485B	Spillville loam, 2 to 5 percent slopes	3.49	3.8%		Ile	88	81
62E	Storden loam, 10 to 22 percent slopes, moderately eroded	1.04	1.1%		IVe	32	33
62D2	Storden loam, 10 to 16 percent slopes, moderately eroded	0.71	0.8%		IVe	41	42
62F	Belview loam, 16 to 30 percent slopes	0.19	0.2%		VIe	17	9
<b>Weighted Average</b>						<b>81.2</b>	<b>73.7</b>

\*\*IA has updated the CSR values for each county to CSR2.  
 \*c: Using Capabilities Class Dominant Condition Aggregation Method  
 Soils data provided by USDA and NRCS.