

Soils Map

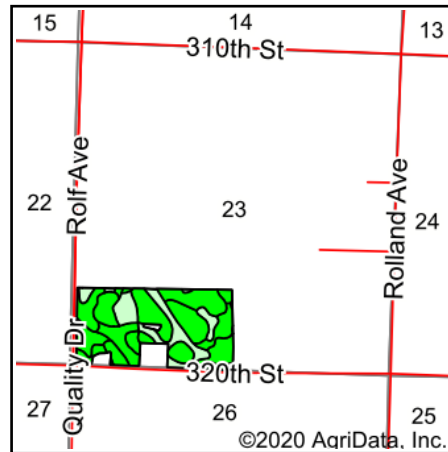
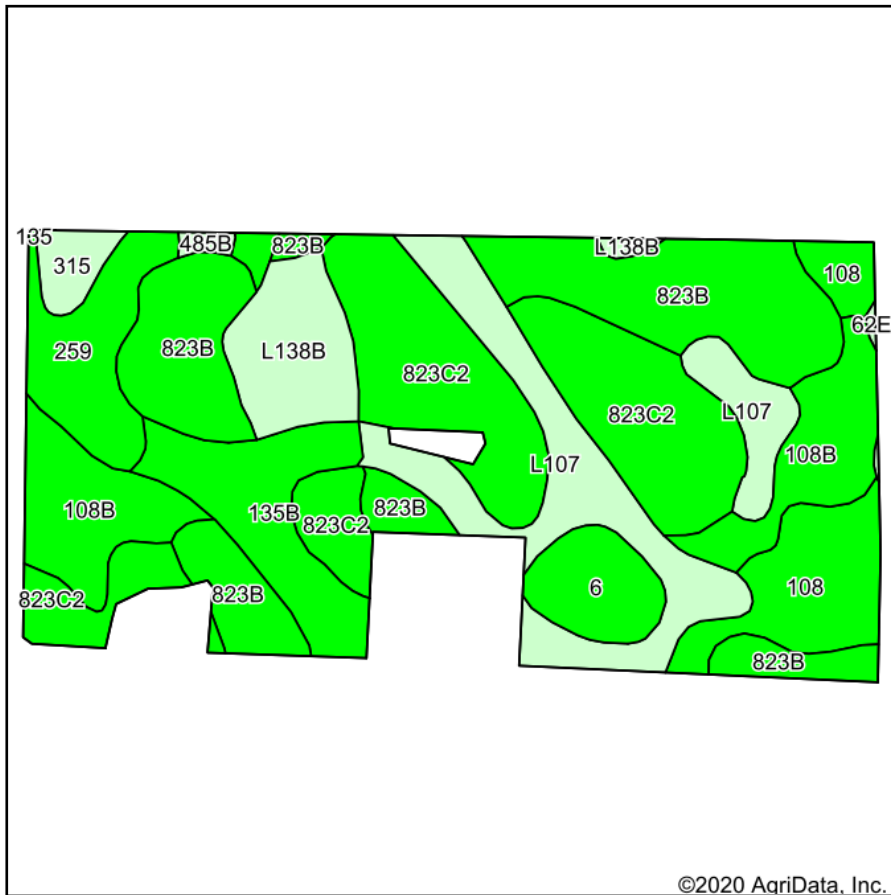

State: **Iowa**
 County: **Sac**
 Location: **23-87N-36W**
 Township: **Wall Lake**
 Acres: **70.02**
 Date: **11/18/2020**

Green Real Estate & Auction Co.
 SAC CITY, IA 712-662-4442
greenrealestate-auction.com

Maps Provided By:
surety
 CUSTOMIZED ONLINE MAPPING
 © AgriData, Inc. 2020 www.AgriDataInc.com



Soils data provided by USDA and NRCS.

| Area Symbol: IA161. Soil Area Version: 28 | | | | | | | |
|---|--|-------|------------------|-------------|------------------|-------------|-----------|
| Code | Soil Description | Acres | Percent of field | CSR2 Legend | Non-Irr Class *c | CSR2** | CSR |
| 823C2 | Flagler sandy loam, calcareous subsoil variant, 5 to 9 percent slopes, moderately eroded | 15.88 | 22.7% | | IIIe | 42 | 8 |
| 823B | Flagler sandy loam, calcareous subsoil variant, 2 to 5 percent slopes | 14.96 | 21.4% | | IIIe | 51 | 20 |
| L107 | Webster clay loam, Bemis moraine, 0 to 2 percent slopes | 9.53 | 13.6% | | IIw | 88 | |
| 108B | Wadena loam, 2 to 6 percent slopes | 7.43 | 10.6% | | IIe | 52 | 49 |
| 108 | Wadena loam, 0 to 2 percent slopes | 5.14 | 7.3% | | IIs | 56 | 54 |
| 135B | Coland clay loam, 2 to 4 percent slopes | 5.00 | 7.1% | | IIe | 69 | 75 |
| L138B | Clarion loam, Bemis moraine, 2 to 6 percent slopes | 3.96 | 5.7% | | IIe | 88 | |
| 259 | Biscay clay loam, 0 to 2 percent slopes | 3.89 | 5.6% | | IIw | 52 | 71 |
| 6 | Okoboji silty clay loam, 0 to 1 percent slopes | 2.53 | 3.6% | | IIIw | 59 | 55 |
| 315 | Alluvial land | 1.05 | 1.5% | | Vw | 8 | 15 |
| L62D2 | Storden loam, Bemis moraine, 10 to 16 percent slopes, moderately eroded | 0.32 | 0.5% | | IVe | 41 | |
| 485B | Spillville loam, 2 to 5 percent slopes | 0.24 | 0.3% | | IIe | 88 | 75 |
| 62E | Storden loam, 10 to 22 percent slopes, moderately eroded | 0.09 | 0.1% | | IVe | 32 | 29 |
| Weighted Average | | | | | | 57.6 | *- |

**IA has updated the CSR values for each county to CSR2.

*- CSR weighted average cannot be calculated on the current soils data, use prior data version for csr values.

*c: Using Capabilities Class Dominant Condition Aggregation Method

Soils data provided by USDA and NRCS.