

Property 10

Tax Map No. 5016-()-219-

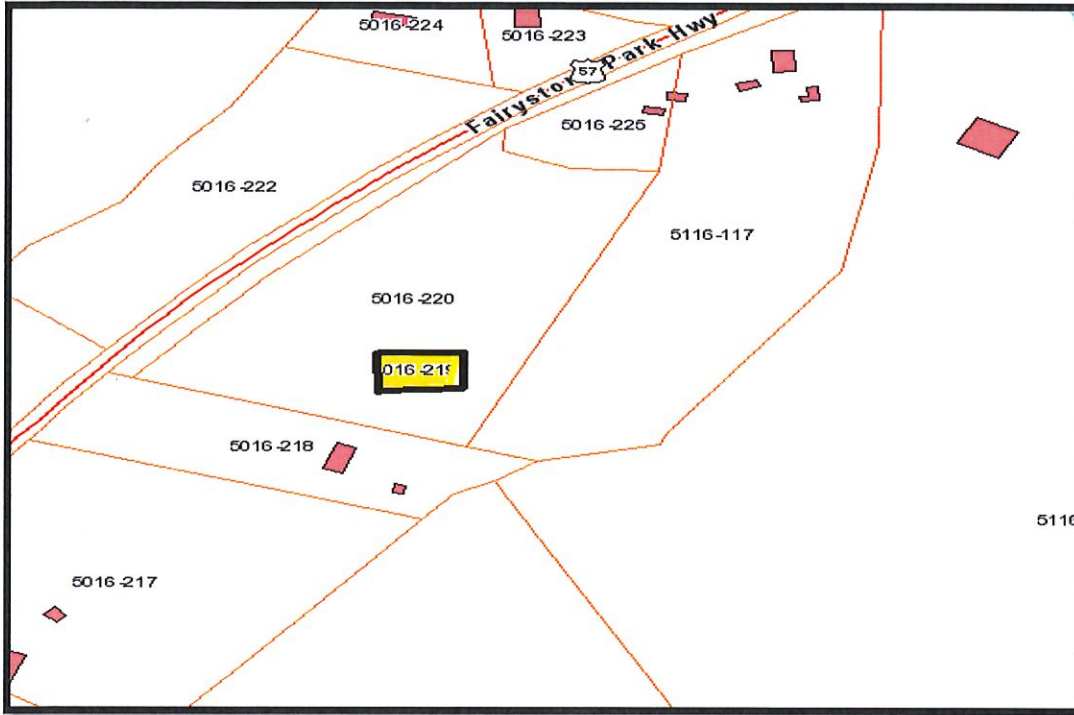

Owner:

Roger Ball, Estate, et al.

Legal Description:

South side of Highway 57

Magisterial District:

Smith River

Acres:

1.5 +/-

Assessed Value:

\$7,000



This information is provided for general reference only and is not intended to be a true and accurate representation of the shape of the property. This is no substitute for a survey of the property and is intended to be informational in nature. Interested bidders should exercise their due diligence to determine the size, shape, location, percability, zoning, road frontage, and any other matters of interest related to this property.