

Managed Forest Law - Order of Designation issued by Wisconsin Department of Natural Resources

Order No: 69-080-2013

Effective Date: January 1, 2013

In the matter of designation of land located in

Waupaca County, Township of Matteson

as Managed Forest Land under Chapter 77 Wisconsin Statutes,

for a period of **50** years on petition of the following parties:

Petitioner(s): SCOTT J TILLESON

JODI A TILLESON

Register of Deeds:

Return document and invoice to:

Department of Natural Resources

Forest Tax Section

PO Box 7963, Madison, WI 53707

Address: 210 INDIAN RIDGE DR
BROOKFIELD, WI 53005

See Parcel Identification No. Below

Findings of Fact

1. The Petitioner has filed a timely petition under s.77.82(2), Wis. Stats., and in accordance with s.77.82, Wis. Stats., to enter the land as Managed Forest Land.
2. The lands described in the petition meet the eligibility requirements of s.77.82(1), Wis. Stats.
3. The facts in the petition are correct.
4. A merchantable stand of timber will be developed on the land within a reasonable period of time.
5. The use of the land as Managed Forest Land is not incompatible with the existing uses of land in the municipality.
6. There are no delinquent taxes on the land.

Conclusions of Law

The Department of Natural Resources, pursuant to s. 77.82(8), Wis. Stats., based upon the foregoing Findings of Fact is required to approve the petitioners' petition and designate the land described in the petition as Managed Forest Land.

Order

It is hereby ordered that the following land be designated Managed Forest Land:

Please see parcel information on the following page(s).

Date: November 6, 2012

**Notice of Appeal Rights on
reverse side of this page**

Pursuant to s. 77.91(6), Wis. Stats.,
the authentication requirements of
s 706.05(2)(b) Wis. Stats., do not apply to this order.

**This instrument drafted by State of Wisconsin
Department of Natural Resources**

State of Wisconsin

Department of Natural Resources

For the Secretary

By

Kathryn J. Nelson

Kathryn J. Nelson, Section Chief

FOREST TAX SECTION

Form 2450-167 (R 3/06) N657

ORDER NUMBER
Co. Code/Seq. No./Yr. of Entry 69 - 080 -2013

State of Wisconsin Dept. of Natural Resources
MANAGED FOREST LAW MAP
 Form 2450-133 Rev. 11/02

MADISON OFFICE USE ONLY
Acreage Entered 125.00

Owner's Name Scott J. Tilleson			Town or Village Name Matteson		County Waupaca
Township # 25	Range # 15	<input checked="" type="checkbox"/> East <input type="checkbox"/> West	Section 15	Open Acres	Closed Acres 125.00

LEGEND: Closed Area Open Area



Prepared By:
Tom Albrecht

Date:
5-2-12

Section Diagram 8" = 1 Mile

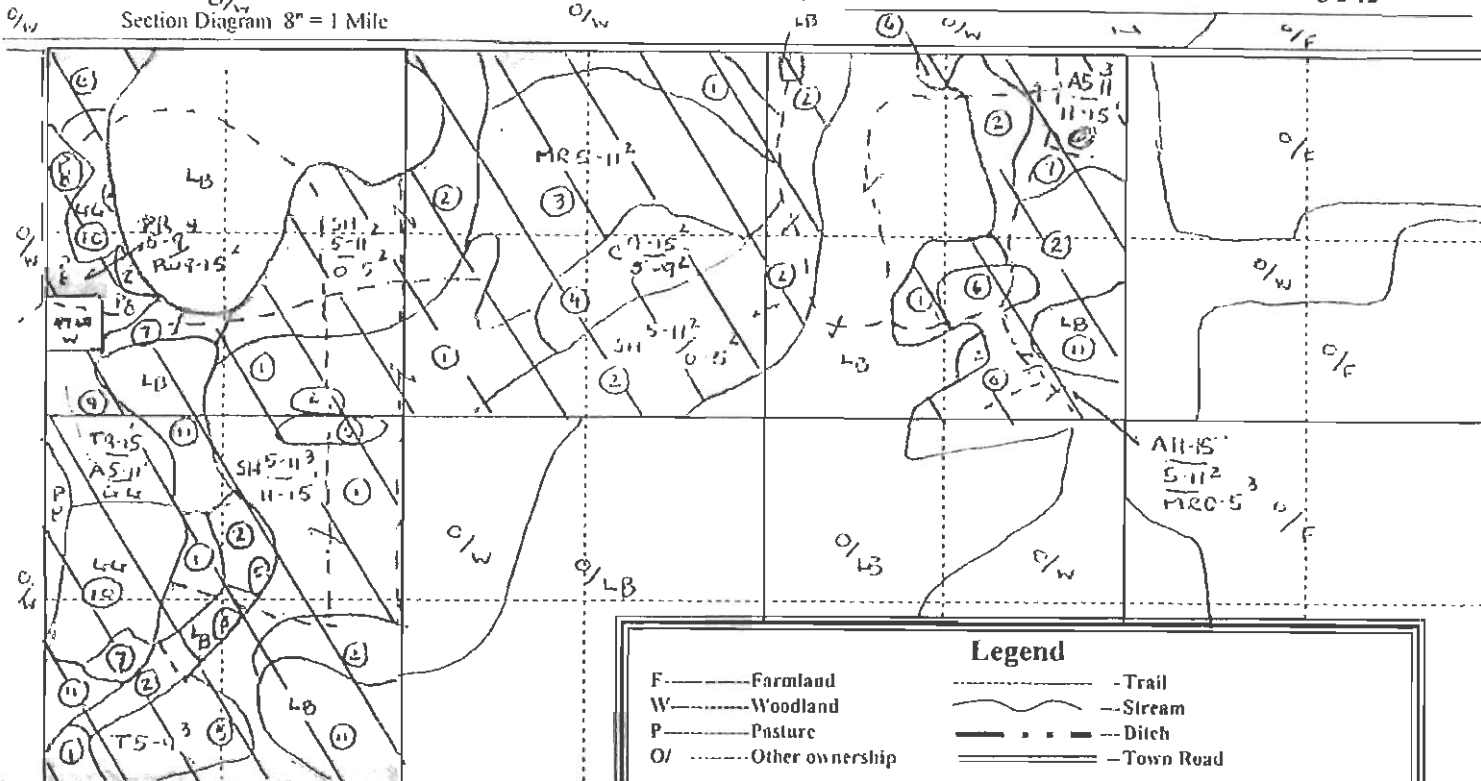

Legend

- | | |
|------------------------|-----------------|
| F-----Farmland | - - - - - Trail |
| W-----Woodland | ~~~~~ Stream |
| P-----Pasture | ===== Ditch |
| O/-----Other ownership | ===== Town Road |

Stand 1 - Swamp Hardwood poletimber of good stocking / Swamp Hardwood small sawlogs of poor stocking. SH 5-11³ / SH 11-15¹ - 27 acres.
 Stand 2 - Swamp Hardwood poletimber of average stocking / Swamp Hardwood saplings of average stocking. SH 5-11² / SH 0-5² - 31 acres.
 Stand 3 - Red Maple poletimber of average stocking. MRG 5-11² - 14 acres.
 Stand 4 - Cedar small sawlogs of average stocking Cedar poletimber of average stocking. C 9-15² / C 5-9² - 5 acres.
 Stand 5 - Tamarack poletimber of good stocking T 5-9³ - 5 acres.
 Stand 6 - Aspen small sawlogs of poor stocking / Aspen poletimber of average stocking / Red Maple saplings of good stocking. A 11-15¹ / A 5-11² / MRG 0-5³ - 7 acres.
 (Legend continued below...)

For exclusion

From NW corner 900' south,

then 208' x 208'

Legend (continued...)

Stand 7 - Aspen pole timber of good stocking / Aspen small sawlogs of good stocking. A 5-11³ / A11-15¹ - 6 acres

Stand P8 - Red Pine pole timber of very good stocking / White Pine small sawlogs of average stocking.

PR 5-9⁴ / PR 9-15² - 4 acres

Stand 9 - Tamarack small sawlogs of poor stocking / Aspen poletimber of poor stocking / grass

T 9-15¹ / A 6-11² / GG - 4 acres

Stand 10 - Grass GG - 7 acres

Stand 11 - Lowland Brush LB - 15 acres

Natural Heritage Inventory searches are made to determine if endangered, threatened, or special concern animals, plants or plant communities exist.

The Natural Resources Heritage Inventory (NHI) lists no Endangered, Threatened or Special Concern Species or Natural Communities within your property.

This same NHI review showed that there are known Endangered, Threatened or Special Concerns Species or Natural Communities present within the surrounding area but they show up on the Wolf River a mile away, and are not known to occur on this property. For additional information on rare plants, animals and natural plant communities, visit <http://dnr.wi.gov/org/land/er>.

The Archaeological Resources Inventory lists no archaeological resources within this MFL property
 The Historical Resources Inventory lists no historical resources within this MFL property.

Contact your local DNR Forester for additional information on archaeological and historical sites.

Your plan defines similar vegetative groupings or areas of land that can be combined for management purposes. Foresters call such areas "stands." Prescriptions (also called "practices") are scheduled for each stand according to its age, condition and characteristic plant species.

Mandatory Practices:

You must complete or establish mandatory practices in the manner prescribed by the end of the year listed below; if not, the department may be required to issue a non-compliance fee or withdraw your property from the MFL program.

If withdrawn, your property may be subject to substantial property taxes and a withdrawal fee.

You must file two cutting notices at least 30 days before you may cut or harvest timber. You must file a Wisconsin Cutting Notice and Report (Form 2450-32). Additionally, you must file a separate county cutting notice with the County Clerk prior to any harvest. The cutting prescriptions must be within the guidelines of the Department of Natural Resources Silviculture Handbook at <http://dnr.wi.gov/forestry/Publications/Handbooks/24315/> and the Forest Management Guidelines at <http://dnr.wi.gov/forestry/Publications/Guidelines/>.

Mandatory Practices Summary

YEAR	STAND(S)	ACRES	TIMBER TYPE	PRACTICE
2026	1	27	SH 5-11 ³ / SH 11-15 ¹	<u>THINNING</u>
2041				<u>WETLAND HARVESTING</u>
2056	1	27	SH 5-11 ³ / SH 11-15 ¹	<u>SHELTERWOOD REGENERATION HARVEST – Preparatory Cut</u> <u>WETLAND HARVESTING</u>
2041	2	31	SH 5-11 ² / SH 0-5 ²	<u>THINNING</u>
2056				<u>WETLAND HARVESTING</u>
2041	3	14	MR 5-11 ²	<u>THINNING</u>
				<u>WETLAND HARVESTING</u>
2056	3	14	MR 5-11 ²	<u>SHELTERWOOD REGENERATION HARVEST – Preparatory Cut</u> <u>WETLAND HARVESTING</u>
2026	4	5	C 9-15 ² / C 5-9 ²	<u>SHELTERWOOD REGENERATION HARVEST – Preparatory Cut</u> <u>WETLAND HARVESTING</u>

Mandatory Practices Summary (continued...)				
YEAR	STAND(S)	ACRES	TIMBER TYPE	PRACTICE
2041	4	5	C 9-15 ² / C 5-9 ²	<u>SHELTERWOOD REGENERATION HARVEST – Final Cut</u> <u>WETLAND HARVESTING</u>
2014	5	5	T 5-9 ³	<u>CLEARCUT REGENERATION HARVEST</u>
2014	6	7	A 11-15 ¹ / A 5-11 ² / MR 0-5 ²	<u>SANITATION and SALVAGE CUTTING</u>
2056	6	7	A 11-15 ¹ / A 5-11 ² / MR 0-5 ²	<u>THINNING.</u>
2014 2060	7	6	A 5-11 ³ / A 11-15 ¹	<u>COPPICE REGENERATION HARVEST</u> <u>RIPARIAN MANAGEMENT ZONES.</u>
2014 2026 2041	P8	4	PR 5-9 ⁴ / PW 9-15 ²	<u>THINNING..</u>
2056	P8	4	PR 5-9 ⁴ / PW 9-15 ²	<u>SHELTERWOOD REGENERATION HARVEST – Preparatory Cut.</u>
2041	9	4	T 9-15 ¹ / A 5-11 ¹ / G	<u>CLEARCUT REGENERATION HARVEST</u>
2042	9	4	T 9-15 ¹ / A 5-11 ¹ / G	<u>PREPARATION FOR PLANTING.</u>
2042	9	4	T 9-15 ¹ / A 5-11 ¹ / G	<u>HAND PIANT.</u>

Non-mandatory Practices:

Non-mandatory practices are optional; however, to get the maximum benefit from your Managed Forest Law-Stewardship Forestry Plan, it is important that you set aside time and money to complete your non-mandatory practices. These practices will enhance the growth rate and species composition of your forest; improve wildlife habitat and recreational opportunities.

Many non-mandatory practices are eligible for cost-share assistance under the Wisconsin Forest Landowner Grant Program.