



# AVONLEY HOMES

3528 POINTE DU HOC DRIVE



RUDDER POINTE NEIGHBORHOOD

3 BDRM | 2 BATH | 1555 SF

Move-In Ready in Rudder Pointe, one of our newest plans, The “Daffodil.” Designed with you and your family in mind, this 3 bedroom, 2 bath home is filled with natural light, an open concept living area, a perfectly designed flex room and so much more! Complete with dual sinks and a super shower, the master bath allows for relaxation and functionality all in one.

Come Home to Avonley and enjoy what all this plan has to offer!

**FEATURES:**

Granite Countertops | Luxury Vinyl Plank Flooring Throughout  
Covered Back Porch | Stainless Appliances

## COME HOME TO AVONLEY



**Avonley Homes**  
 979-321-7200  
 info@avonleyhomes.com

## 3528 POINTE DU HOC DRIVE

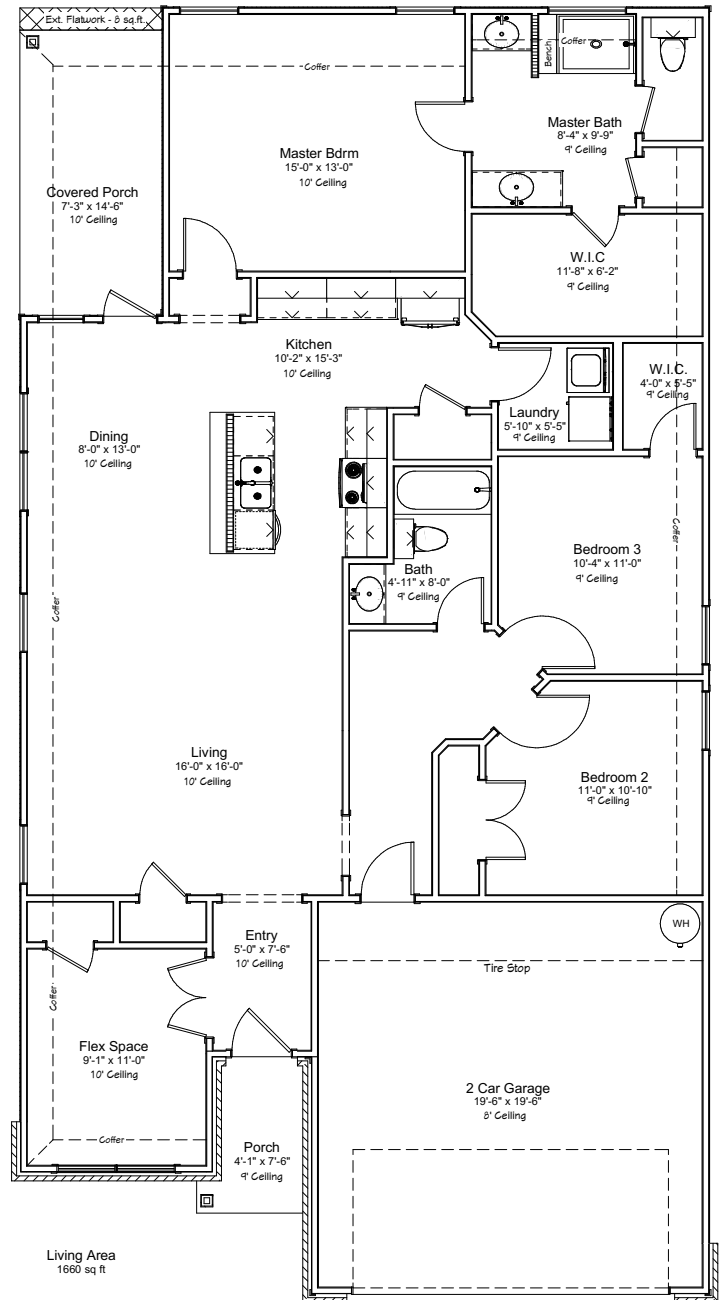

3 BDRM | 2 BATH | 1655 SF

**WWW.AVONLEYHOMES.COM**

**COME HOME TO AVONLEY | Avonley Homes is committed to giving families the home of their dreams. From simple comfort to expert craftsmanship, we promise you will be proud to call our house your home.**