

2697 3-car at Shadow Creek

4 BEDROOMS + BONUS / 3 BATHS - 2,697 SQ.FT.

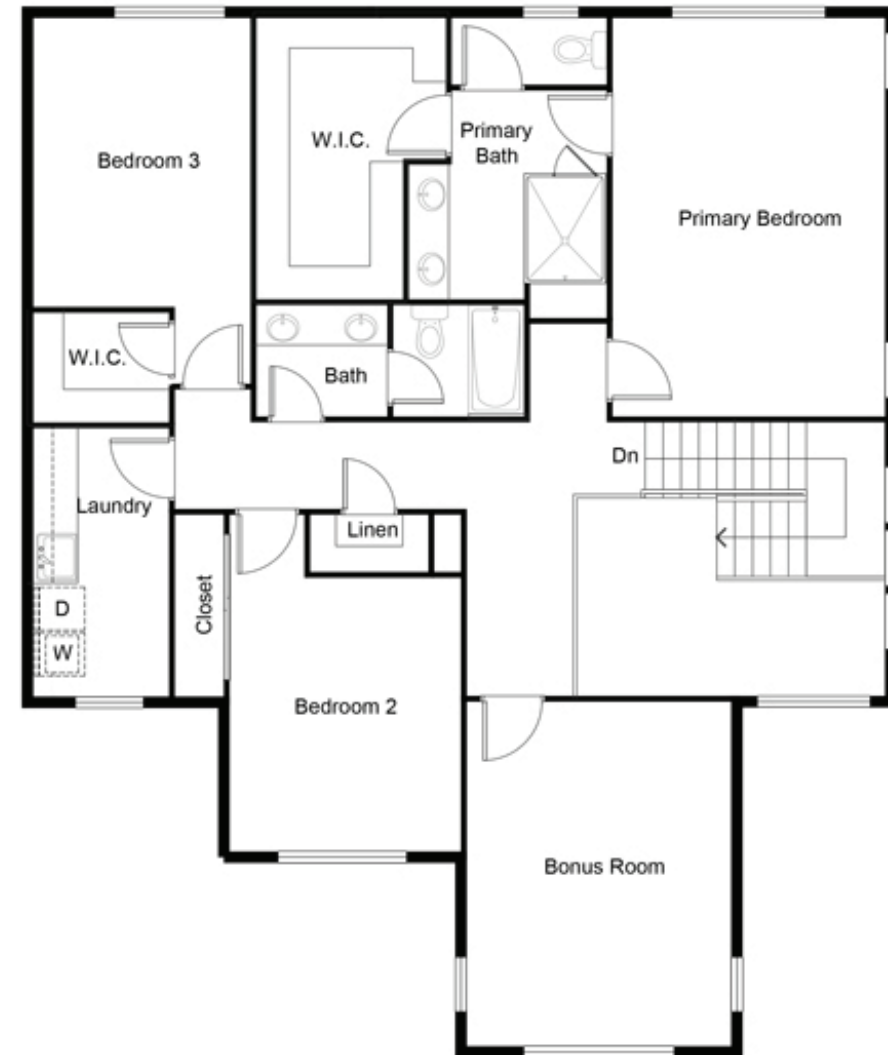

MAIN



UPPER

Plans and elevations are artists' renderings only. RM Homes reserves the right to make changes to floor plans, specifications, dimensions and elevations without prior notice, Stated dimensions and square footage are approximate and should not be used as representation of the home's actual size. Deck and/or patio size may vary per lot, community and/or jurisdiction.

2697 3-car at Shadow Creek

4 BEDROOMS + BONUS / 3 BATHS - 2,697 SQ.FT.

Unique Plan Features

- > 2697 sq.ft. home with 3-car garage
- > Just one available, our most affordable home at Shadow Creek
- > Welcoming entry with two-story ceiling
- > Gourmet kitchen with island and walk-in pantry
- > Sun deck that steps down to backyard
- > Main-level bedroom/den with adjacent guest bath
- > Owner's entry from garage
- > Spacious primary suite with big walk-in shower and walk-in closet
- > Laundry with cabinets, countertop, and utility sink

